

SLV CONNECTOR

Disconnectable Crimp style connectors

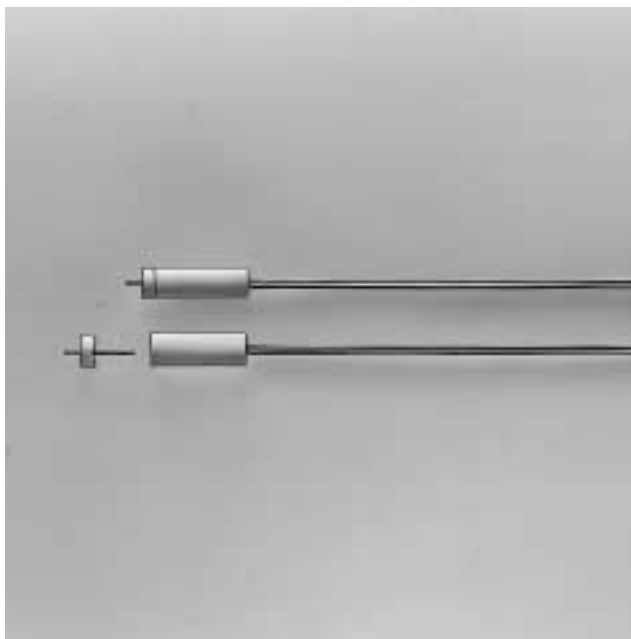

This is a single-circuit version of the SV connector. Even though this connector has only one circuit, it provides a secure connection.

Specifications

- Current rating: 5A AC, DC
- Applicable wire: AWG #24 to #20
- Temperature range: -25°C to +85°C
(including temperature rise in applying electrical current)

Standards

 Recognized E60389

 Certified LR20812

Contact

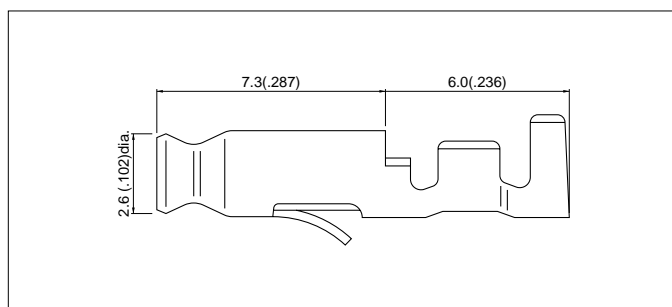

Model No.	Q'ty / reel
SVF-01T-1.5S	4,000
Material and Finish	
Brass, tin-plated	

Housing

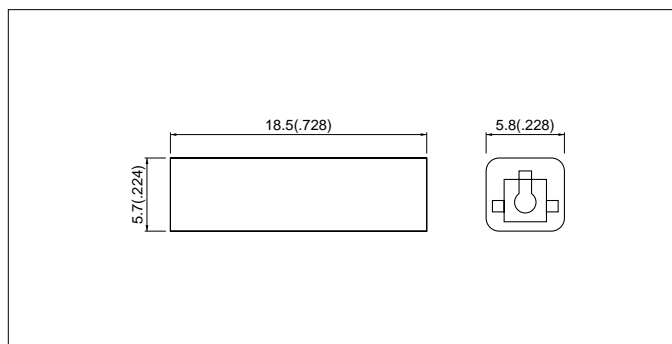

Model No.	Q'ty / bag
S1P-SLV	1,000
Material and Finish	
Nylon 6, UL94V-0, natural (white)	

Header, single circuit

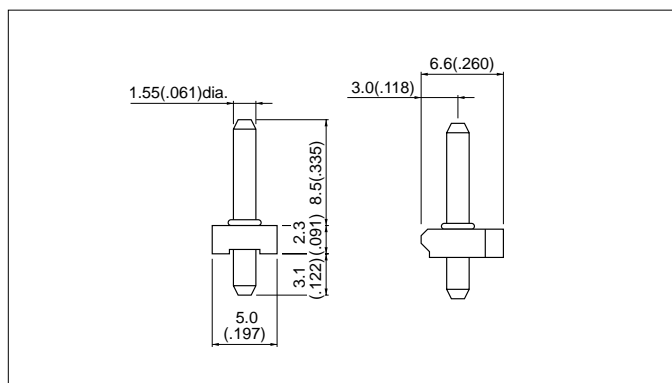

Model No.	Q'ty / box
RTB-1.5-1F	1,000
Material and Finish	
Post: Brass copper-undercoated, tin-plated Wafer: Nylon 66, UL94V-0, natural (ivory)	

Applicator for the semi-automatic press AP-K2N

Contact	Crimp applicator MKS-L		Compact crimp applicator MKS-LS		Strip-crimp applicator MKS-SC
	with safety cover	without safety cover	with safety cover	without safety cover	with safety cover
SVF-01T-1.5S	APLMK SVF01-15S	APLNC SVF01-15S	—	—	—