

F-61-05-07
F-61-05-11

■ **LOW PROFILE 2.5mm PITCH
INDIRECT PCB CONNECTOR
WITH FRICTION LOCK**

IL-G Series

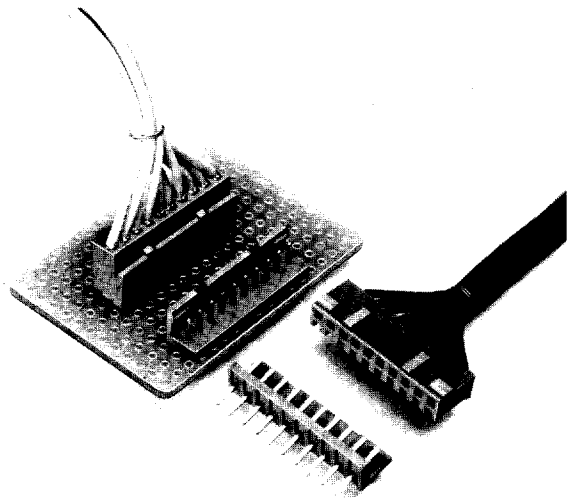

IL-G series connector is highly reliable, low cost, low profile, indirect PCB connector with friction locking mechanism, making lower and higher density mounting on the P.C. board.

- Very low profile — total mated height: 10mm
- Newly designed, highly reliable socket contact
- 14 sizes, from 2 to 15 contact layouts
- Straight/Right angle pin headers & sockets

● **MATERIALS & FINISHES**

Insulator: 66 Nylon,
UL94V-0 light brown
Pin contact: Brass,
Tin over nickel plated

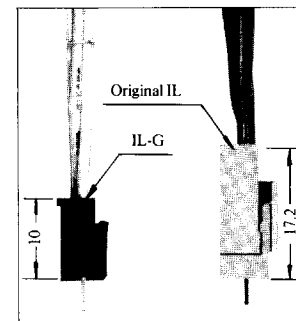

● **STANDARD DATA**

- Current rating: 3 Amp.
- Dielectric withstanding voltage: 1500 VAC r.m.s.
- Insulation resistance: 100 MΩ min.
- Contact resistance: 20 mΩ max.
- Contact retention: 1 kg min.
- Total mating force: $(350 \times n + 1500)$ g max.
- Total unmating force: $(200 \times n + 1500)$ g min.
- Operating temperature: -40°C thru $+85^{\circ}\text{C}$
- Applicable PCB: 1.6 thru 2.6 mm thick
- Applicable wire size: AWG #22 thru #28
(n=Number of contacts)

Straight pin header



Right-angle pin header



Socket housing



● **SOCKET CONTACT (CRIMP TYPE)**

P/N: IL-G-C2-SA-10000 (reeled 10000 pcs.)
Material: Phosphor bronze
Finish: Tin plate

● **SEMI-AUTOMATIC CRIMPING MACHINE:
CT350-2-ILG**

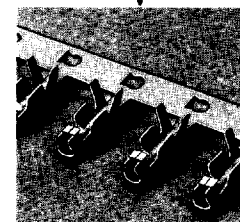
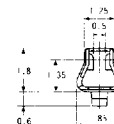
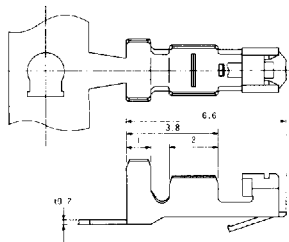
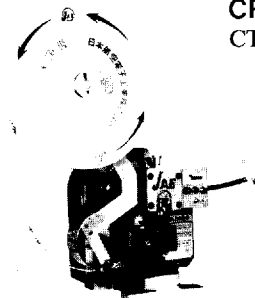

● **HAND CRIMPING TOOL:**

Tool	Applicable wire		Insulation stripping length
	AWG#	Outer dia.	
CT150-1-ILG	#28~#26	1.0~1.3mm	2.4~3.0mm
CT150-1B-ILG	#26~#24	1.2~1.5mm	
CT150-1C-ILG	#24~#22	1.4~1.7mm	
CT150-1D-ILG	#20 (shielded wire)		