



DEUTSCH | DEUTSCH DT

TE Internal #: DT06-3S-EP10

Housing for Female Terminals, Component-to-Wire, 3 Position, .394 in [10.01 mm] Centerline, Sealable, Black, Wire & Cable, Power & Signal, DEUTSCH DT

[View on TE.com >](#)

Connectors > Automotive Connectors > Connector Housings > DEUTSCH DT Series Housings & Connectors



Connector & Housing Type: **Housing for Female Terminals**

Mating Pin Diameter: **1.59 mm [ .063 in ]**

Connector System: **Component-to-Wire**

Number of Positions: **3**

Centerline (Pitch): **10.01 mm [ .394 in ]**

[All DEUTSCH DT Series Housings & Connectors \(461\)](#)

**Features**

**Product Type Features**

Connector & Housing Shape	Triangular
Connector & Housing Type	Housing for Female Terminals
Connector System	Component-to-Wire
Sealable	Yes
Hybrid Connector	No
Primary Locking Feature	Integrated in Housing
Connector & Contact Terminates To	Wire & Cable

**Configuration Features**

Blank Cavity Position	0
Connector Modification	Terminating Resistor, End Cap, J1939
Number of Positions	3

**Electrical Characteristics**

Operating Voltage	250 VAC
Nominal Voltage Architecture	12 V, 24 V, 48 V

**Body Features**

Cable Exit Angle	180°
Body Material	PA GF



Primary Product Color	Black
-----------------------	-------

### Contact Features

Contact Type	Socket
Mating Pin Diameter	1.59 mm[.063 in]
Contact Current Rating (Max)	13 A

### Mechanical Attachment

Mounting Feature	Without
Terminal Position Assurance	Yes
Strain Relief	Add By Accessory
Mating Alignment Type	Polarized
Mating Alignment	With

### Housing Features

Centerline (Pitch)	10.01 mm[.394 in]
--------------------	-------------------

### Dimensions

Product Width	18.71 mm[.737 in]
Product Length	31.19 mm[1.228 in]
Product Height	23.89 mm[.94 in]

### Usage Conditions

Operating Temperature (Max)	125 °C[257 °F]
Operating Temperature Range	-55 – 125 °C[-67 – 257 °F]

### Operation/Application

Circuit Application	Power & Signal
---------------------	----------------

### Industry Standards

Agency/Standard	SAE J2030
Degree of Protection	IP68, IP6K9K
UL Flammability Rating	12mm Flame Test per Standard UL-94

### Packaging Features

Packaging Quantity	1000
Packaging Method	Box

### Other

Serviceable	Yes
-------------	-----



Connector Position Assurance Capable

No

### Product Compliance

[For compliance documentation, visit the product page on TE.com>](#)

EU RoHS Directive 2011/65/EU	Compliant with Exemptions
EU ELV Directive 2000/53/EC	Compliant with Exemptions
China RoHS 2 Directive MIIT Order No 32, 2016	Restricted Materials Above Threshold
EU REACH Regulation (EC) No. 1907/2006	Current ECHA Candidate List: JUNE 2022 (224) Candidate List Declared Against: JAN 2022 (223) SVHC > Threshold: Pb (1.2% in in its components) <b>Article Safe Usage Statements:</b> Do not eat, drink or smoke when using this product. Wash thoroughly after handling. Recycle if possible and dispose of the article by following all applicable governmental regulations relevant to your geographic location.
Halogen Content	Not Low Halogen - contains Br or Cl > 900 ppm.
Solder Process Capability	Not reviewed for solder process capability

#### Product Compliance Disclaimer

This information is provided based on reasonable inquiry of our suppliers and represents our current actual knowledge based on the information they provided. This information is subject to change. The part numbers that TE has identified as EU RoHS compliant have a maximum concentration of 0.1% by weight in homogenous materials for lead, hexavalent chromium, mercury, PBB, PBDE, DBP, BBP, DEHP, DIBP, and 0.01% for cadmium, or qualify for an exemption to these limits as defined in the Annexes of Directive 2011/65/EU (RoHS2). Finished electrical and electronic equipment products will be CE marked as required by Directive 2011/65/EU. Components may not be CE marked. Additionally, the part numbers that TE has identified as EU ELV compliant have a maximum concentration of 0.1% by weight in homogenous materials for lead, hexavalent chromium, and mercury, and 0.01% for cadmium, or qualify for an exemption to these limits as defined in the Annexes of Directive 2000/53/EC (ELV). Regarding the REACH Regulation, the information TE provides on SVHC in articles for this part number is based on the latest European Chemicals Agency (ECHA) 'Guidance on requirements for substances in articles' posted at this URL: <https://echa.europa.eu/guidance-documents/guidance-on-reach>

### Compatible Parts



TE Part # CAT-D487-CH8172  
DEUTSCH DT Series Housings & Connectors



TE Part # CAT-D487-H342  
DEUTSCH DT HEADERS



TE Part # 1011-345-0305  
DUST CAP, 3P, PLG, BLK, DT

### Also in the Series | DEUTSCH DT



Automotive Connector Caps & Covers (98)



Automotive Connector Locks & Position Assurance(73)



Automotive Housings(619)



Automotive Seals & Cavity Plugs(4)



Insertion & Extraction Tools(3)



Other Automotive Connector Accessories(14)

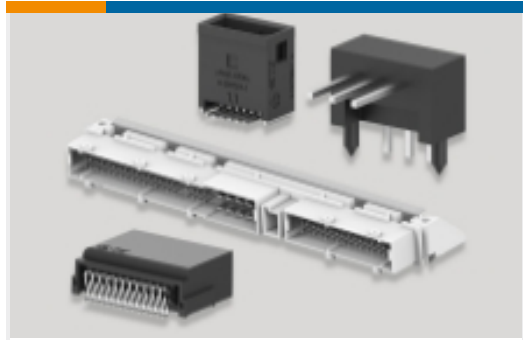

PCB Headers & Receptacles(106)

## Customers Also Bought



TE Part #1813123-1  
ASSY FOR SUPPORT PLATE AND SEALING



TE Part #W3S-1939  
WEDGE LOCK, 3P, PLG, BLU, STD, J1939, DT



TE Part #42899-2  
RING TONGUE 10-6 AWG TPBR



TE Part #2-34173-1  
TERMINAL, PG R 12-10 3/8

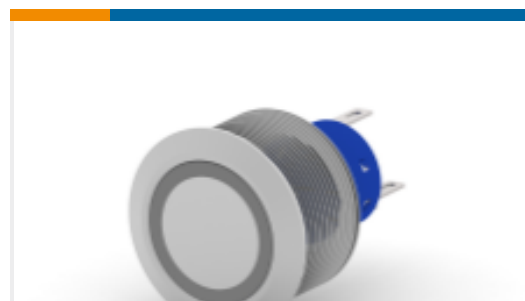

TE Part #1-2317656-9  
AV25 SPL 3A MOVING RING BLUE 12V



TE Part #DT04-3P-P007  
REC, 3P, GRY, Y-SPLITTER

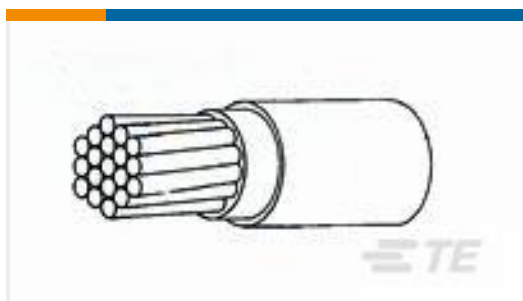

TE Part #2823653006  
44A0111-12-4

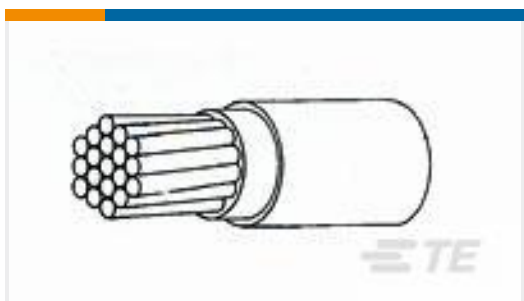

TE Part #282062-000  
44A0211-10-9

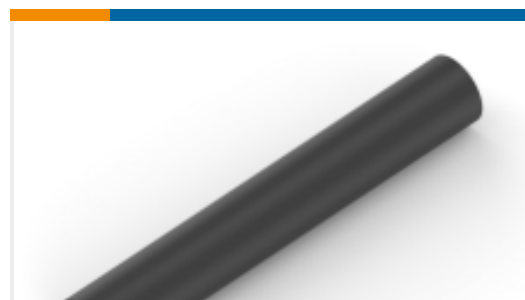

TE Part #EK5194-000  
ES2000-NO.6-H2-0-39MM

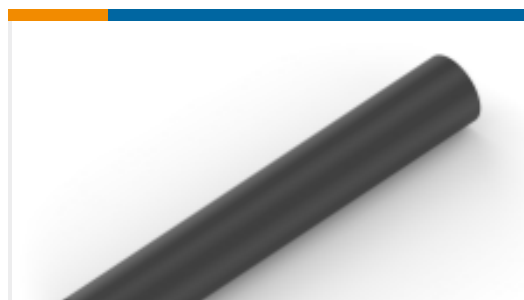

TE Part #EK5493-000  
ES2000-NO.8-A1-0-2IN

## Documents



### Product Drawings

[PLG, 3P, BLK, 120 OHM RESISTOR](#)

English

---

### CAD Files

Customer View Model

[ENG\\_CVM\\_CVM\\_DT06-3S-EP10\\_99.2d\\_dxf.zip](#)

English

[3D PDF](#)

3D

Customer View Model

[ENG\\_CVM\\_CVM\\_DT06-3S-EP10\\_99.3d\\_igs.zip](#)

English

Customer View Model

[ENG\\_CVM\\_CVM\\_DT06-3S-EP10\\_99.3d\\_stp.zip](#)

English

By downloading the CAD file I accept and agree to the [Terms and Conditions](#) of use.

---

### Datasheets & Catalog Pages

[ICT Terminals and Connectors Catalogue](#)

English

[CONNECTOR SELECTOR](#)

English

---

### Product Specifications

[Application Specification](#)

English

---

### Product Environmental Compliance

[Product Compliance](#)

English

[Product Compliance](#)

English

---

### Agency Approvals

[UL Report](#)

English