

DRAWING FOR REFERENCE: This is subject to change without notice  
08/11/2012

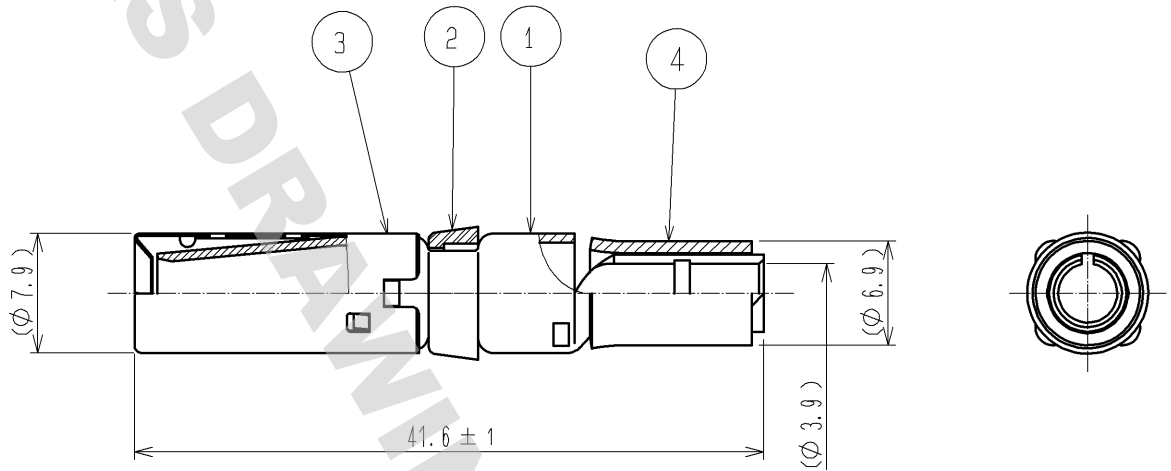

- NOTES
- 1 APPLICABLE CRIMPING TOOL : JIS C 9711(Compression tools for wire connectors of interior wiring) OR EQUIVALENT CRIMPING TOOL.
  - 2 APPLICABLE EXTRACTION TOOL : EM-8-TP(CL150-0249-3)
  - 3 ONE BAG INCLUDES 4PCS OF PRODUCTS.
  - 4 THE WIRING OF THIS PRODUCT SHALL CONFORM TO ATAD-C0155.
  - 5 REFER TO ASSEMBLY PROCEDURE AND HANDLING MANUAL (ATAD-C0222) FOR THE ASSEMBLY OF THIS PRODUCT.

2	PBT	UL94V-0 (WHITE)	4	JIS C 2806	NON-INSULATED CRIMP-TYPE SLEEVES FOR COPPER CONDUCTORS OPEN END CONNECTORS E-M		
1	COPPER ALLOY	OVER PLATING: TIN 1μm min. UNDER PLATING: NICKEL 1μm min.	3	STAINLESS STEEL			
NO.	MATERIAL	FINISH , REMARKS	NO.	MATERIAL	FINISH , REMARKS		
UNITS mm		SCALE 2 : 1	COUNT 	DESCRIPTION OF REVISIONS	DESIGNED	CHECKED	DATE
<b>HIROSE ELECTRIC CO., LTD.</b>	APPROVED : SU. OBARA	11. 04. 01	DRAWING NO.	EDC4-115601-00			
	CHECKED : HY. KOBAYASHI	11. 04. 01	PART NO.	EM-SC-113			
	DESIGNED : HN. TANAKA	11. 04. 01	CODE NO.	CL138-0010-5-00			
	DRAWN : YS. SAKODA	11. 03. 31		1/1			