

REVISIONS					
REV	ECO	DESCRIPTION	DATE	BY	APPR
01	-	PRELIMINARY DRAWING	19OCT18	SULLEN	TOMMY

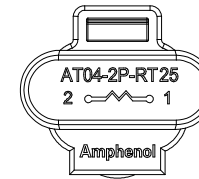

NOTES: UNLESS OTHERWISE SPECIFIED

- MATERIAL:
HOUSING: THERMOPLASTIC, BLACK
CONTACT: COPPER ALLOY
CONTACT PLATING: NICKEL PLATED
- MODIFICATIONS: RESISTOR
- SPECIFICATIONS:
3.1 RESISTOR PROPERTIES: 27K OHMS 1/2 WATT 1% TOLERANCE
3.2 OPERATING TEMPERATURE: -55°C TO +125°C
3.3 MOISTURE RESISTANCE: IP67
3.4 MATING CYCLE DURABILITY: 100 CYCLES
3.5 RoHS COMPLIANT
- MATING PART: AT06-2S*
(* = ALL MODIFICATIONS)
- ALL DIMENSIONS ARE FOR REFERENCE USE ONLY

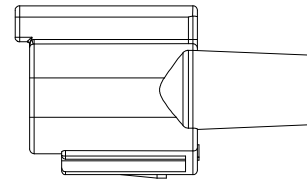
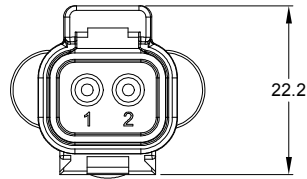
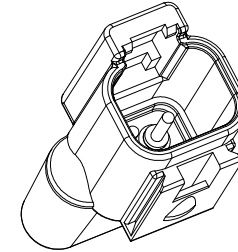
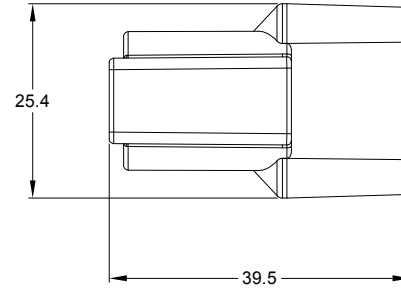
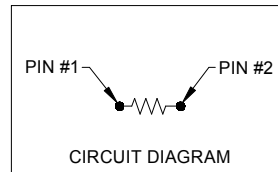

TITLE: RECEPTACLE 2PIN,RESISTOR,AT SERIES
DWG NO: AT04-2P-RT25
REV: 01
SH: 1
OF: 1

AT04-2P-RT25		DESCRIPTION		ITEM
QUANTITY	PART NUMBER	MATERIALS LIST		
<p>UNLESS OTHERWISE SPECIFIED</p> <p>1) All dimensions are in metric(mm). 2) Tolerances are as follows: 1 PL DEC ±0.30 2 PL DEC ±0.15 3 PL DEC ±0.08</p> <p>Fractions ±1/64 Angles ±1°</p> <p>3) Note reference = </p>				
SIGNATURES		DATE		
DRAWN: SULLENZHANG		19SEP18		
CHECKED: ORONLI		19SEP18		
ENGINEER:				
APPROVAL: TOMMYXIE		19SEP18		
MATERIAL SPECIFICATIONS:		CUSTOMER:		
PROCESS SPECIFICATIONS:		THIS DRAWING IS SUPPLIED FOR INFORMATION ONLY. DESIGN FEATURES, SPECIFICATIONS AND PERFORMANCE DATA SHOWN HEREON ARE THE PROPERTY OF THE AMPHENOL CORPORATION. NO RIGHTS OF REPRODUCTION ARE IMPLIED. ALL DIMENSIONS ARE SUBJECT TO NORMAL MANUFACTURING VARIATIONS.		
NEXT ASSY:		SCALE: NONE		
		SIZE: B C-	DWG NO: AT04-2P-RT25	REVISION: 01
		SINE SYSTEMS - www.amphenol-sine.com 44724 Morley Drive Clinton Township, MI 48036		SHEET 1 OF 1
		RECEPTACLE 2PIN,RESISTOR, AT SERIES		