

REVISIONS					
REV	ECO	DESCRIPTION	DATE	BY	APPR
01	-	PRELIMINARY DRAWING	19SEP18	SULLEN	TOMMY

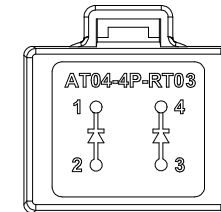

NOTES: UNLESS OTHERWISE SPECIFIED

- MATERIAL:
HOUSING: THERMOPLASTIC, GRAY
CONTACT: COPPER ALLOY
CONTACT PLATING: NICKEL PLATED
- MODIFICATIONS: DIODE
- SPECIFICATIONS:
3.1 DIODE P/N: MUR460G
3.2 PEAK REVERSE VOLTAGE: 600.0 V MAX.
3.3 PEAK FORWARD VOLTAGE: 1.28 V MAX.
3.4 AVERAGE FORWARD CURRENT: 4.0 A MAX.
3.5 OPERATING TEMPERATURE: -55°C TO +125°C
3.6 MOISTURE RESISTANCE: IP67
3.7 MATING CYCLE DURABILITY: 100 CYCLES
3.8 RoHS COMPLIANT
- MATING PART: AT06-4S*
(* = ALL MODIFICATIONS)
- ALL DIMENSIONS ARE FOR REFERENCE USE ONLY

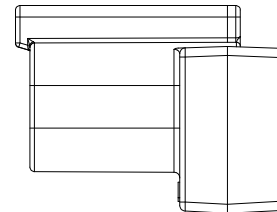
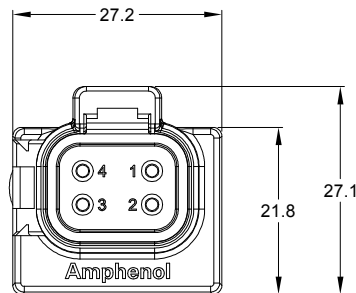
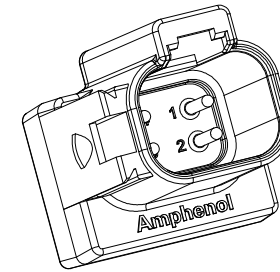
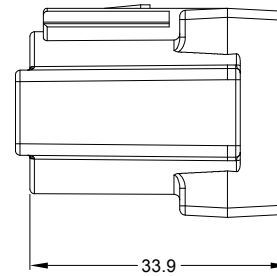
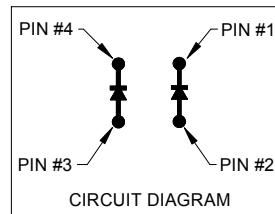

AT04-4P-RT03		DESCRIPTION		ITEM
PART NUMBER				
MATERIALS LIST				
UNLESS OTHERWISE SPECIFIED 1) All dimensions are in metric(mm). 2) Tolerances are as follows: 1 PL DEC ±0.30 2 PL DEC ±0.15 3 PL DEC ±0.08 Fractions ±1/64 Angles ±1°		SIGNATURES DRAWN: SULENZHANG CHECKED: ORONLI APPROVAL: TOMMYXIE DATE: 19SEP18 DATE: 19SEP18 DATE: 19SEP18		
MATERIAL SPECIFICATIONS:		Amphenol Sine Systems - www.amphenol-sine.com 44724 Morley Drive Clinton Township, MI 48036		
PROCESS SPECIFICATIONS:		RECEPTACLE 4PIN,TERMINATOR, AT SERIES		
NEXT ASSY:		THIS DRAWING IS SUPPLIED FOR INFORMATION ONLY. DESIGN FEATURES, SPECIFICATIONS AND PERFORMANCE DATA SHOWN HEREON ARE THE PROPERTY OF THE AMPHENOL CORPORATION. NO RIGHTS OF REPRODUCTION ARE IMPLIED. ALL DIMENSIONS ARE SUBJECT TO NORMAL MANUFACTURING VARIATIONS.	SIZE: B C- SCALE: NONE	DWG NO: AT04-4P-RT03 REVISION: 01
		SHEET 1 OF 1		

TITLE: RECEPTACLE 4PIN,TERMINATOR,AT SERIES
DWG NO: AT04-4P-RT03
REV: 01
SH: 1
OF: 1