

4

3

2

1

THIS DRAWING IS UNPUBLISHED. RELEASED FOR PUBLICATION, 19 .  
 © COPYRIGHT 19 BY AMP INCORPORATED. ALL RIGHTS RESERVED.

| LOC | DIST | REVISIONS   |                             |         |       |
|-----|------|-------------|-----------------------------|---------|-------|
| P   | LTR  | DESCRIPTION | DATE                        | DWN     | APVD  |
| CM  | 52   | G           | REVISED PER EC 063B-0169-99 | 18NOV99 | LM JE |

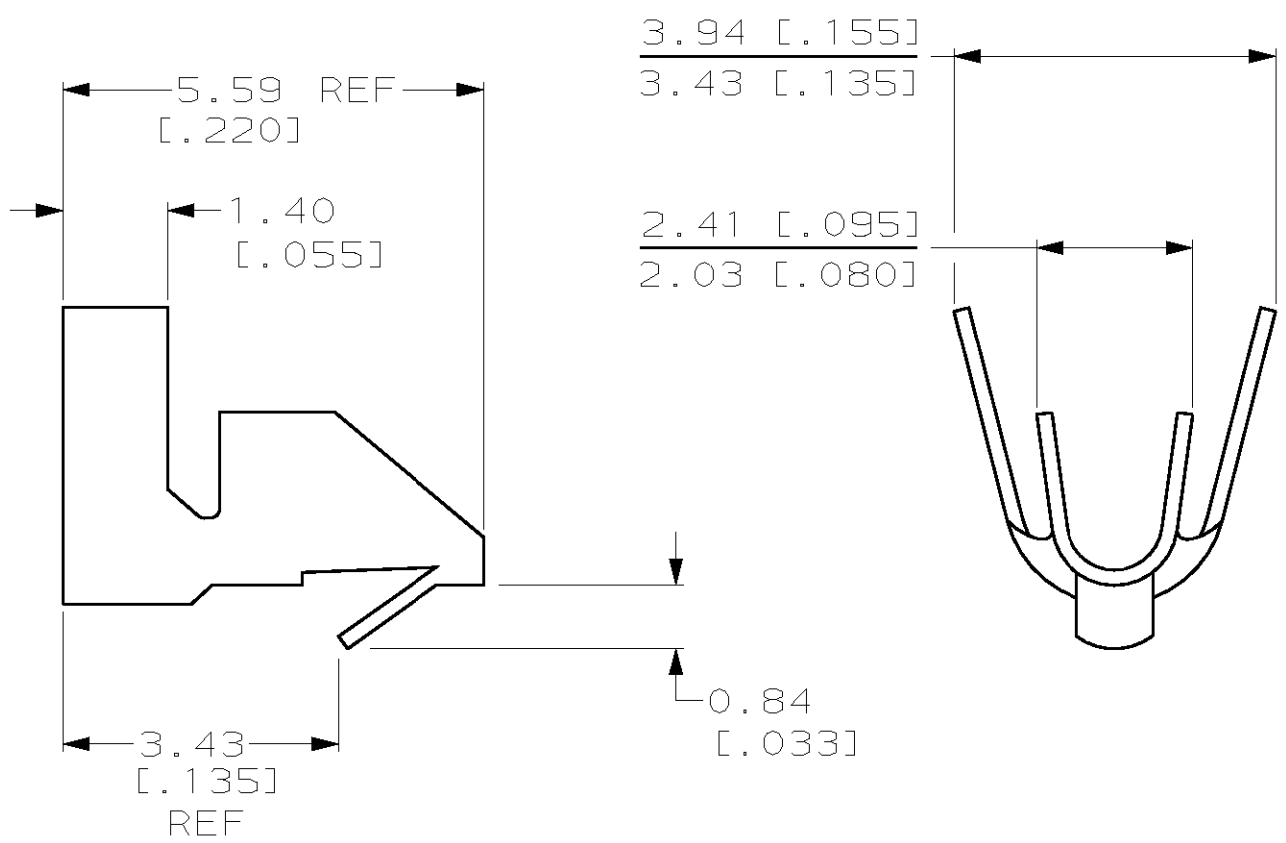

- PARTS COMPLY WITH AMP SOLDERABILITY SPEC 109-11-3.
- WIRE RANGE: 0.3 - 0.9 mm<sup>2</sup> (22 - 18 AWG).
- INSULATION RANGE: 1.52 - 2.79 [.060 - .110] DIA.
- 0.00254 [.000100] MIN BRIGHT TIN-LEAD OVER 0.00203 [.000080] MIN MATTE COPPER.
- 0.00508 [.000200] MIN BRIGHT TIN-LEAD.
- DIMENSIONS IN BRACKETS ARE IN INCHES.
- FOR FOREIGN PRODUCTION ONLY.

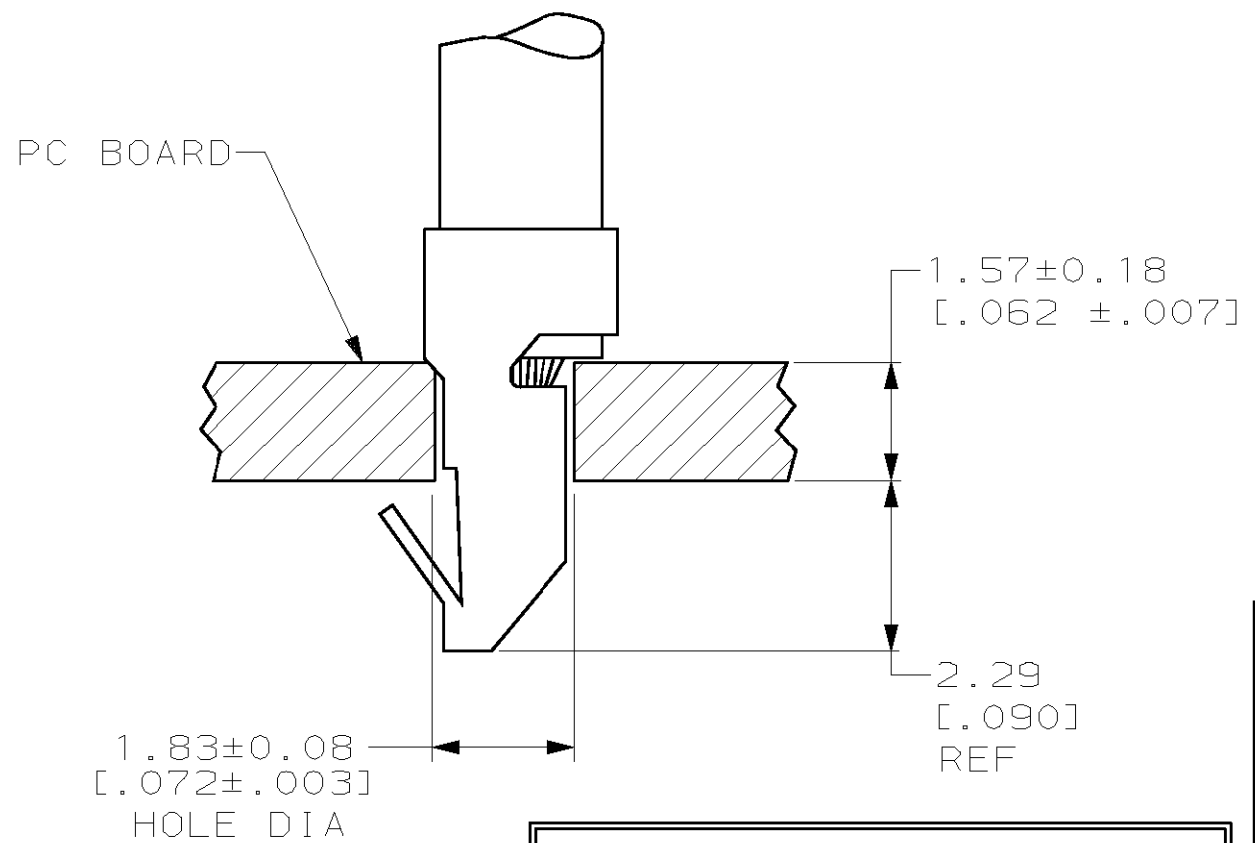

**METRIC**

| FINISH | MATERIAL                | PART NO  |
|--------|-------------------------|----------|
| △4 △7  | 0.20 [.008] BRASS       | 770565-3 |
| △5     | 0.20 [.008] PHOS BRONZE | 770565-2 |
| △4     | 0.20 [.008] BRASS       | 770565-1 |

THIS DRAWING IS A CONTROLLED DOCUMENT.

|                  |          |          |  |
|------------------|----------|----------|--|
| DWN              | B. LEWIS | 12-20-89 | <b>AMP</b> AMP Incorporated<br>Harrisburg, PA 17105-3608 |
| CHK              | R. SWING | 12-21-89 |  |
| APVD             | W. LONG  | 12-21-89 |  |
| NAME             |          |          | MINI AMP-IN  |
| PRODUCT SPEC     |          |          | SIZE CAGE CODE DRAWING NO RESTRICTED TO                  |
| APPLICATION SPEC |          |          | A3 00779 C- 770565 -                                     |
| WEIGHT           |          |          | SCALE 10:1 SHEET 1 OF 1 REV G                            |
| CUSTOMER DRAWING |          |          |  |