

81665-3 ✓ ACTIVE

AMP | AMP CPC

TE Internal #: 81665-3

Circular Connector Seals, Flange Seal, Panel Mount, -55 – 105 °C

[-67 – 221 °F], AMP CPC

[View on TE.com >](#)



Connectors > Circular Connectors > Circular Connector Accessories > Circular Connector Seals > CPC SEALED ACCESSORIES

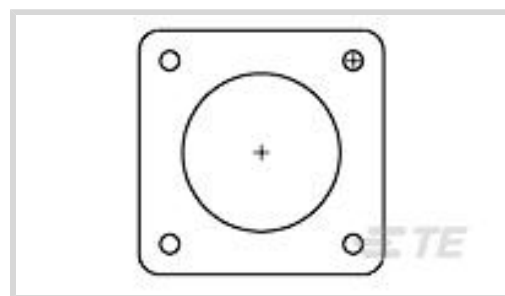

Connector Seal Type: **Flange Seal**

Connector Mounting Type: **Panel Mount**

Operating Temperature Range: -55 – 105 °C [-67 – 221 °F]

[All CPC SEALED ACCESSORIES \(5\)](#)

Features

Product Type Features

Connector Seal Type	Flange Seal
---------------------	-------------

Body Features

Color	Black
-------	-------

Mechanical Attachment

Connector Mounting Type	Panel Mount
-------------------------	-------------

Usage Conditions

Operating Temperature Range	-55 – 105 °C[-67 – 221 °F]
-----------------------------	----------------------------

Packaging Features

Packaging Quantity	1000
Packaging Method	Box

Product Compliance

[For compliance documentation, visit the product page on TE.com>](#)

EU RoHS Directive 2011/65/EU	Compliant
EU ELV Directive 2000/53/EC	Compliant
China RoHS 2 Directive MIIT Order No 32, 2016	No Restricted Materials Above Threshold
EU REACH Regulation (EC) No. 1907/2006	Current ECHA Candidate List: JUNE 2022 (224) Candidate List Declared Against: JAN 2022 (223)

SVHC > Threshold:
Not Yet Reviewed

Halogen Content

Not Yet Reviewed for halogen content

Solder Process Capability

Not applicable for solder process capability

Product Compliance Disclaimer

This information is provided based on reasonable inquiry of our suppliers and represents our current actual knowledge based on the information they provided. This information is subject to change. The part numbers that TE has identified as EU RoHS compliant have a maximum concentration of 0.1% by weight in homogenous materials for lead, hexavalent chromium, mercury, PBB, PBDE, DBP, BBP, DEHP, DIBP, and 0.01% for cadmium, or qualify for an exemption to these limits as defined in the Annexes of Directive 2011/65/EU (RoHS2). Finished electrical and electronic equipment products will be CE marked as required by Directive 2011/65/EU. Components may not be CE marked. Additionally, the part numbers that TE has identified as EU ELV compliant have a maximum concentration of 0.1% by weight in homogenous materials for lead, hexavalent chromium, and mercury, and 0.01% for cadmium, or qualify for an exemption to these limits as defined in the Annexes of Directive 2000/53/EC (ELV). Regarding the REACH Regulation, the information TE provides on SVHC in articles for this part number is based on the latest European Chemicals Agency (ECHA) 'Guidance on requirements for substances in articles' posted at this URL: <https://echa.europa.eu/guidance-documents/guidance-on-reach>

Compatible Parts



TE Part # CAT-AM71-C83998Y
CPC SERIES 1 SEALED ONE-PIECE



TE Part # CAT-AM71-C83998K
CPC SERIES 6

Also in the Series | AMP CPC



Circular Connector Adapters(7)



Circular Connector Boots & Strain Relief(6)

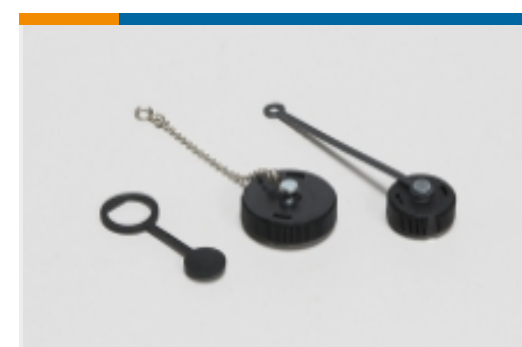

Circular Connector Caps & Covers(16)



Circular Connector Hardware(3)



Circular Connector Keying Plugs(2)



Circular Connector Seals(36)



Circular Power Connectors(516)



Insertion & Extraction Tools(1)

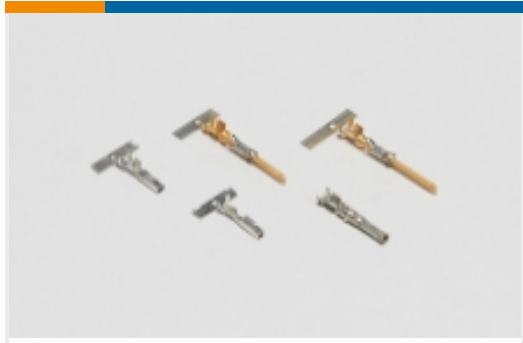

Power Contacts(6)

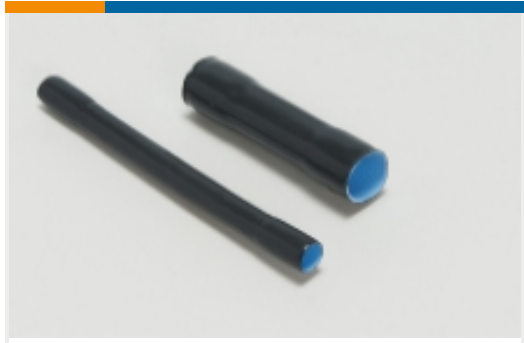

Sealing Sleeves(2)



Unscreened Circular Connector Backshells & Clamps(56)

Customers Also Bought



TE Part #54010-1
CPC STRAIN RELIEF, SIZE 11



TE Part #206061-2
CPC SERIES 6



TE Part #T4171010003-001
M12, REAR MOUNTING, MALE, A, 3P, 0.2 M WIRE



TE Part #1-770247-0
UMNL II SOK SN/AUNI/PHBZ LP



TE Part #9-1437621-9
KLN500B1/8=KNOB KNURL W/IND LI



TE Part #YDTS20W15-19SNV001
RECP ASSY



TE Part #1445420-2
SEAL, FLANGE, SIZE 11



TE Part #2-350376-0
MR SPLT GROMET .218 DIA BLK LF

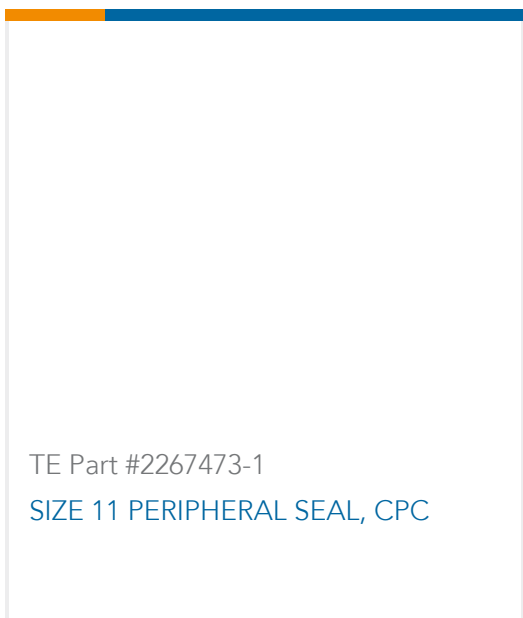

TE Part #2267473-1
SIZE 11 PERIPHERAL SEAL, CPC

Documents



Product Drawings

[ECONOSEAL, FLANGE GASKET](#)

English

CAD Files

[3D PDF](#)

English

Customer View Model

[ENG_CVM_81665-3_C.2d_dxf.zip](#)

English

Customer View Model

[ENG_CVM_81665-3_C.3d_igs.zip](#)

English

Customer View Model

[ENG_CVM_81665-3_C.3d_stp.zip](#)

English

[3D PDF](#)

3D

Customer View Model

[ENG_CVM_CVM_81665-3_E.2d_dxf.zip](#)

English

Customer View Model

[ENG_CVM_CVM_81665-3_E.3d_igs.zip](#)

English

Customer View Model

[ENG_CVM_CVM_81665-3_E.3d_stp.zip](#)

English

By downloading the CAD file I accept and agree to the [Terms and Conditions](#) of use.

Datasheets & Catalog Pages

[AMP Circular Connectors for Commercial Signal & Power Applications](#)

English

Product Specifications

[Application Specification](#)

English