

EM-87933-028

| SEE SHEET 3 EC NO: S2017-0234 DRWN: MRAMAKR SHINA 2016/10/12 CHKD: APPR: MRAMAKR SHINA 2016/10/21 | QUALITY SYMBOLS | GENERAL TOLERANCES (UNLESS SPECIFIED) | DIMENSION STYLE | SCALE | DESIGN UNITS | THIRD ANGLE PROJECTION | | | | | | | | | | | | | | | |
|--|---|--|--------------------|--------------------------------|---------------------|------------------------|-------|-------|----------|-------|-------|----------|--------|-------|---------|-------|-------|---------|-----|--------|--|
| | $\nabla A = 0$ $\nabla C = 0$ $\nabla P = 0$ | <table border="1"> <tr><th></th><th>mm</th><th>INCH</th></tr> <tr><td>4 PLACES</td><td>± ---</td><td>± ---</td></tr> <tr><td>3 PLACES</td><td>± ---</td><td>± ---</td></tr> <tr><td>2 PLACES</td><td>± 0.20</td><td>± ---</td></tr> <tr><td>1 PLACE</td><td>± ---</td><td>± ---</td></tr> </table> | | mm | INCH | 4 PLACES | ± --- | ± --- | 3 PLACES | ± --- | ± --- | 2 PLACES | ± 0.20 | ± --- | 1 PLACE | ± --- | ± --- | MM ONLY | NTS | METRIC | |
| | | mm | INCH | | | | | | | | | | | | | | | | | | |
| | 4 PLACES | ± --- | ± --- | | | | | | | | | | | | | | | | | | |
| 3 PLACES | ± --- | ± --- | | | | | | | | | | | | | | | | | | | |
| 2 PLACES | ± 0.20 | ± --- | | | | | | | | | | | | | | | | | | | |
| 1 PLACE | ± --- | ± --- | | | | | | | | | | | | | | | | | | | |
| DRAFT WHERE APPLICABLE MUST REMAIN WITHIN DIMENSIONS | DRAWN BY: MRAMAKR SHINA 2015/05/08 CHECKED BY: ATSEE 2015/05/08 APPROVED BY: MRAMAKR SHINA 2015/06/11 MATERIAL NO. | TITLE CUSTOM HEADER 1.27MM PITCH DUAL ROW HEADER, SINGLE WAFER, SMT | MOLEX INCORPORATED | DOCUMENT NO. SD-151159-0001 | SHEET NO. 1 OF 3 | | | | | | | | | | | | | | | | |
| SIZE A3 THIS DRAWING CONTAINS INFORMATION THAT IS PROPRIETARY TO MOLEX INCORPORATED AND SHOULD NOT BE USED WITHOUT WRITTEN PERMISSION | | | | | | | | | | | | | | | | | | | | | |

CIRCUITS POSITION CONFIGURATION

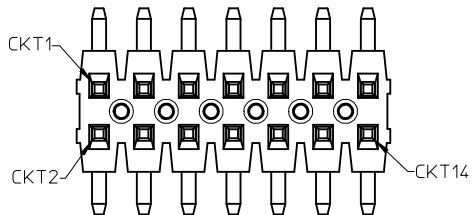

PART WITHOUT PEG AND CAP VERSION

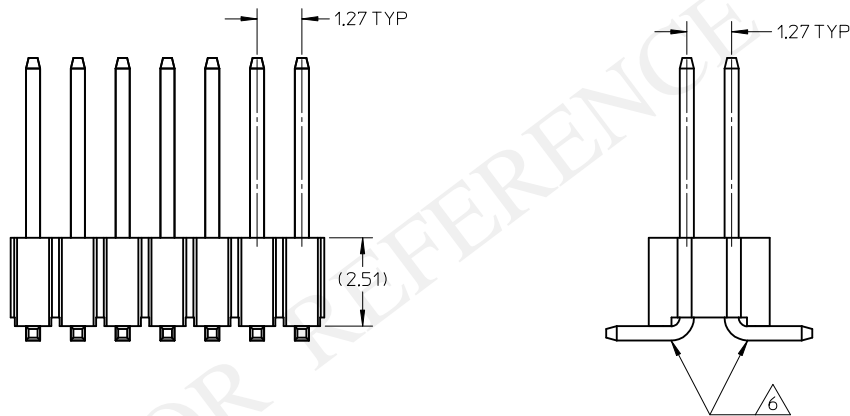

NOTES:

1. MATERIAL:
 - HSG: LCP, GLASS-FILLED, UL94V-0, COLOR: BLACK
 - CAP: NYLON, GLASS-FILLED, UL94V-0, COLOR: BLACK
 - PIN: 0.40MM SQ. COPPER ALLOY
2. PLATING TYPE:
 - (1) GOLD FLASH OVER
1.25µm MIN. NICKEL OVERALL.
 - (2) GOLD FLASH ON CONTACT AND
2.50µm MIN. TIN ON SOLDER TAIL OVER
1.25µm MIN. NICKEL OVERALL.
 - (3) 0.38µm MIN. GOLD PLATE ON CONTACT AND
2.00µm MIN. TIN ON SOLDER TAIL OVER
1.25µm MIN. NICKEL OVERALL.
 - (4) 0.76µm MIN. GOLD PLATE ON CONTACT AND
2.00µm MIN. TIN ON SOLDER TAIL OVER
1.25µm MIN. NICKEL OVERALL.
 - (5) 2.50µm MIN. TIN OVERALL
1.25µm MIN. NICKEL OVERALL
3. PACKAGING TYPE: SEE TABLE
4. PCB THICKNESS 1.60+/-0.10mm
5. PRODUCT SPECIFICATION: PS-87933-001
6. BEND DEPRESSION IS ACCEPTED SO LONG AS IT DOES NOT AFFECT THE OVERALL COPLANARITY OF TAIL
7. COPLANARITY IS TO BE MEASURED BY RESTING THE SOLDER TAIL ON A FLAT SURFACE
8. CAP POSITION TO BE LOCATED AT THE CENTER OF DIMENSION (A) REGARDLESS OF CIRCUIT SIZE
TOP SURFACE OF CAP TO BE FLAT FOR THE PURPOSE OF PICK & PLACE BY VACUUM SUCTION NOZZLE
9. IRREGULAR CIRCUIT CUTOFF WITHIN BREAKAWAY SECTION IS PERMISSIBLE. CUTTING OR CHIPPING OF THE MAIN BODY IS NOT ACCEPTABLE
10. PIN PUSH OUT FORCE: 0.4Kgf IN EITHER DIRECTION
11. THE ABOVE CKT 14 IS FOR ILLUSTRATION PURPOSE ONLY
12. PACKAGING SPECIFICATION:
 - T&R: PK-89990-567
 - TRAY: PK-89990-568

EM-87933-028

| | | | | | | | | |
|---|--------------------|--|---|--|---|---|------------------------|--|
| SEE SHEET 3 EC NO: S2017-0234 DRWN: MRAMAKRISHNA 2016/10/12 CHKD: APPR: MRAMAKRISHNA 2016/10/21 | DESCRIPTION REV | QUALITY SYMBOLS | GENERAL TOLERANCES (UNLESS SPECIFIED) | DIMENSION STYLE | SCALE | DESIGN UNITS | THIRD ANGLE PROJECTION | |
| | | $\nabla_A = 0$ $\nabla_C = 0$ $\nabla_P = 0$ | mm INCH 4 PLACES ± --- ± --- 3 PLACES ± --- ± --- 2 PLACES ± 0.20 ± --- 1 PLACE ± --- ± --- ANGULAR ± 3 ° | MM ONLY | NTS | METRIC | | |
| | | | DRAFT WHERE APPLICABLE MUST REMAIN WITHIN DIMENSIONS | DRAWN BY DATE MRAMAKRISHNA 2015/05/08 CHECKED BY DATE ATSEE 2015/05/08 APPROVED BY DATE MRAMAKRISHNA 2015/06/11 MATERIAL NO. | TITLE | CUSTOM HEADER 1.27MM PITCH DUAL ROW HEADER, SINGLE WAFER, SMT | | |
| | | | | SEE TABLE | MOLEX INCORPORATED DOCUMENT NO. SD-151159-0001 | SHEET NO. 2 OF 3 | | |

| CKT SIZE | DIMENSION | | |
|----------|-----------|-------|-------|
| | A | B | C |
| 04 | 2.54 | 1.27 | - |
| 06 | 3.81 | 2.54 | - |
| 08 | 5.08 | 3.81 | - |
| 10 | 6.35 | 5.08 | 3.81 |
| 12 | 7.62 | 6.35 | - |
| 14 | 8.89 | 7.62 | - |
| 16 | 10.16 | 8.89 | - |
| 18 | 11.43 | 10.16 | - |
| 20 | 12.70 | 11.43 | 10.16 |
| 22 | 12.70 | 11.43 | - |
| 24 | 13.97 | 12.70 | - |
| 26 | 15.24 | 13.97 | - |
| 28 | 16.51 | 15.24 | - |
| 30 | 17.78 | 16.51 | - |
| 32 | 19.05 | 17.78 | 16.51 |
| 34 | 20.32 | 19.05 | - |
| 36 | 21.59 | 20.32 | - |
| 38 | 22.86 | 21.59 | - |
| 40 | 24.13 | 22.86 | - |
| 42 | 25.40 | 24.13 | 22.86 |
| 44 | 26.67 | 25.40 | - |
| 46 | 27.94 | 26.67 | - |
| 48 | 29.21 | 27.94 | - |
| 50 | 30.48 | 29.21 | - |
| 52 | 31.75 | 30.48 | 29.21 |
| 54 | 33.02 | 31.75 | - |
| 56 | 34.29 | 33.02 | - |
| 58 | 35.56 | 34.29 | - |
| 60 | 36.83 | 35.56 | 34.29 |
| 62 | 38.10 | 36.83 | - |
| 64 | 40.64 | 39.37 | - |

| PART NUMBER IN PACKAGIN OPTION | | | | CKT SIZE | PEG | PLATE OPT. | VOID POSITION | DIMENSION | | | | | |
|--------------------------------|------------------------------|------------------|---------------|----------|-----|------------|---------------|-----------|-------|--------------|------|------|------|
| TRAY WITHOUT CAP | TAPE & REEL WITH CAP W/O PEG | TUBE WITHOUT CAP | TUBE WITH CAP | | | | | G | F | MATING END M | E | J | (K) |
| - | - | 151159-0400 | - | 04 | NO | 1 | - | - | 6.51 | 3.00 | 1.00 | 1.92 | 5.10 |
| - | 151159-0600 | - | - | 06 | NO | 5 | - | 10.81 | 10.01 | 6.50 | 1.00 | 2.36 | 6.00 |
| 151159-2000 | - | - | - | 20 | NO | 4 | - | - | 8.61 | 4.83 | 1.27 | 2.36 | 6.00 |
| - | 151159-2400 | - | - | 24 | NO | 5 | - | 13.31 | 12.51 | 9.00 | 1.00 | 2.36 | 6.00 |
| 151159-2401 | - | - | - | 24 | NO | 5 | - | - | 15.81 | 12.30 | 1.00 | 2.36 | 6.00 |
| - | 151159-6400 | - | - | 64 | NO | 1 | - | 7.21 | 5.96 | 3.05 | 0.40 | 2.28 | 5.84 |

CAP POSITION ILLUSTRATION FOR REFERENCE

FOR ILLUSTRATION 14 CKT AS SHOWN

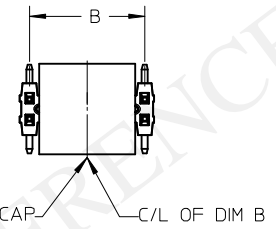

C/L OF DIM B = C/L OF CAP
FOR ODD CKT COLUMN

FOR ILLUSTRATION 64 CKT AS SHOWN

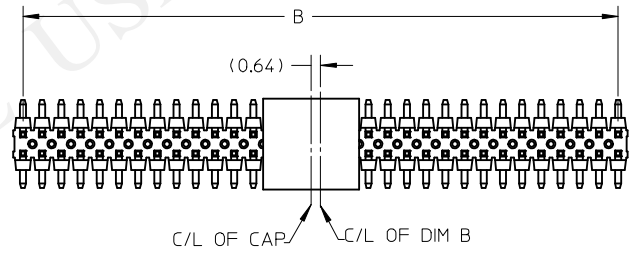

C/L OF DIM B IS OFFSET WITH C/L OF CAP
FOR EVEN CKT COLUMN

| | | | | | | | | | |
|---|-----------------|--|--------|---|--------------|--------------------|-------------------------|------------------------|--------|
| ADD P/N 151159-2401 EC NO: S2017-0234 DRWN:MRAMAKRISHNA 2016/10/12 CHKD: APPR:MRAMAKRISHNA 2016/10/21 | QUALITY SYMBOLS | GENERAL TOLERANCES (UNLESS SPECIFIED) | | DIMENSION STYLE | | SCALE | DESIGN UNITS | THIRD ANGLE PROJECTION | |
| | $F_A=0$ | mm | INCH | MM ONLY | | NTS | METRIC | | |
| | $F_C=0$ | 4 PLACES | ± --- | ± --- | DRAWN BY | DATE | TITLE | | |
| | $F_P=0$ | 3 PLACES | ± --- | ± --- | MRAMAKRISHNA | 2015/05/08 | CUSTOM HEADER | | |
| | | 2 PLACES | ± 0.20 | ± --- | CHECKED BY | DATE | 1.27MM PITCH DUAL ROW | | |
| | | 1 PLACE | ± --- | ± --- | ATSEE | 2015/05/08 | HEADER,SINGLE WAFER,SMT | | |
| | | ANGULAR ± 3 ° | | APPROVED BY | DATE | MOLEX INCORPORATED | | | |
| | | DRAFT WHERE APPLICABLE MUST REMAIN WITHIN DIMENSIONS | | MRAMAKRISHNA | 2015/06/11 | MOLEX INCORPORATED | | | |
| | | | | MATERIAL NO. | | DOCUMENT NO. | | SHEET NO. | |
| | | | | SIZE | A3 | SEE TABLE | | SD-151159-0001 | |
| | | | | THIS DRAWING CONTAINS INFORMATION THAT IS PROPRIETARY TO MOLEX INCORPORATED AND SHOULD NOT BE USED WITHOUT WRITTEN PERMISSION | | | | | 3 OF 3 |

EM-87933-028

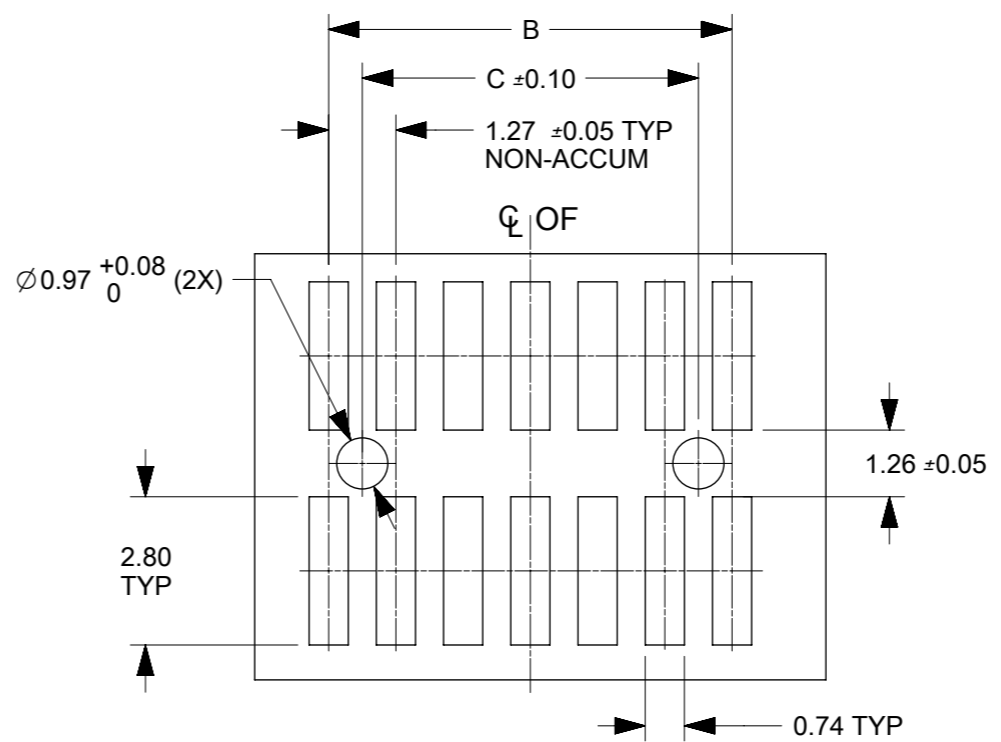
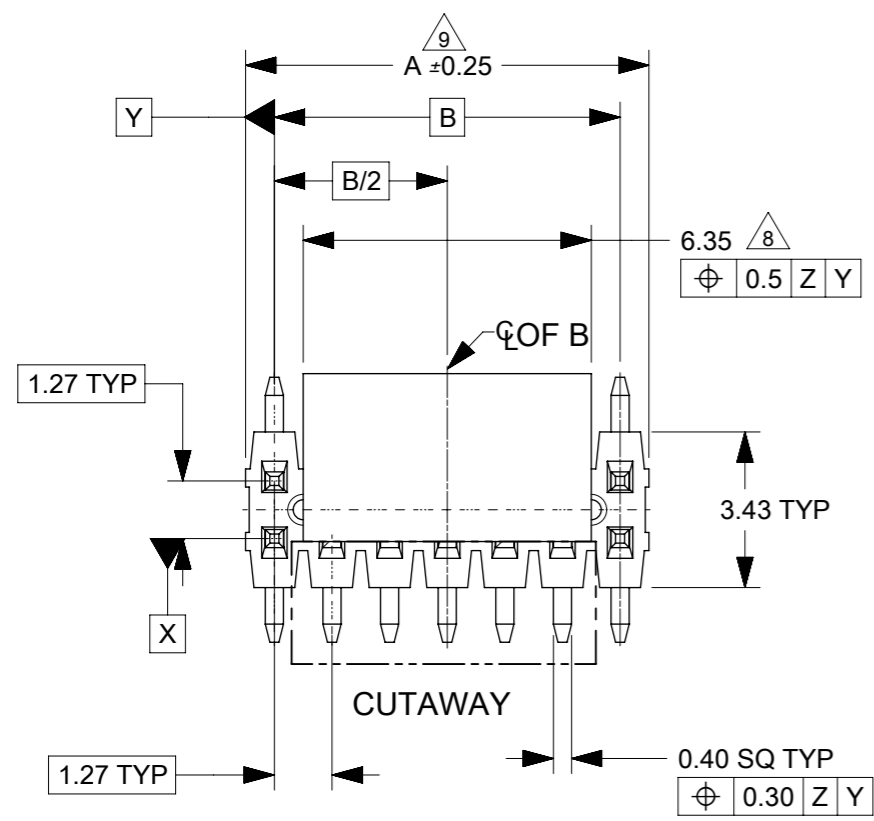

RECOMMENDED PCB LAYOUT : COMPONENT SIDE

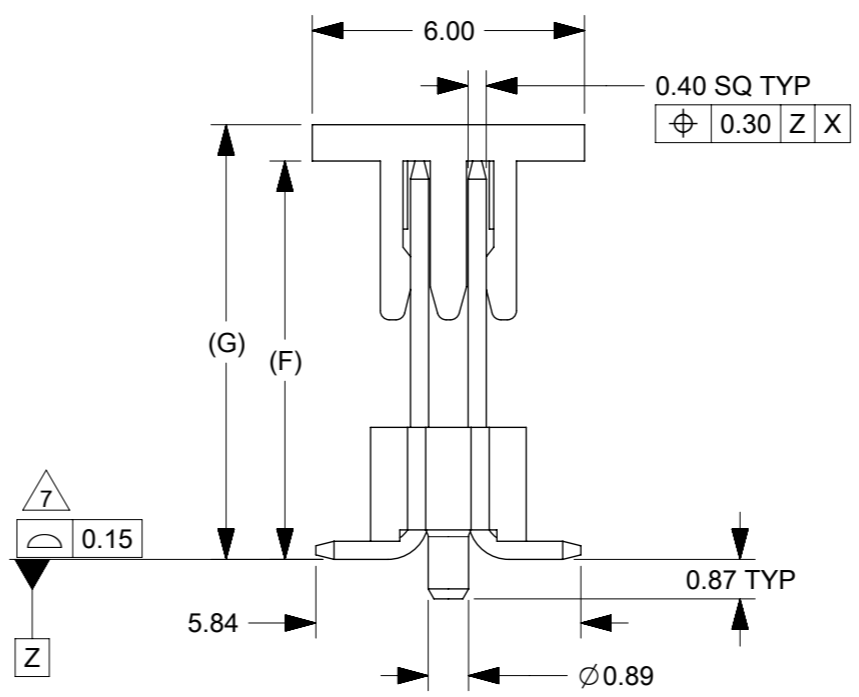
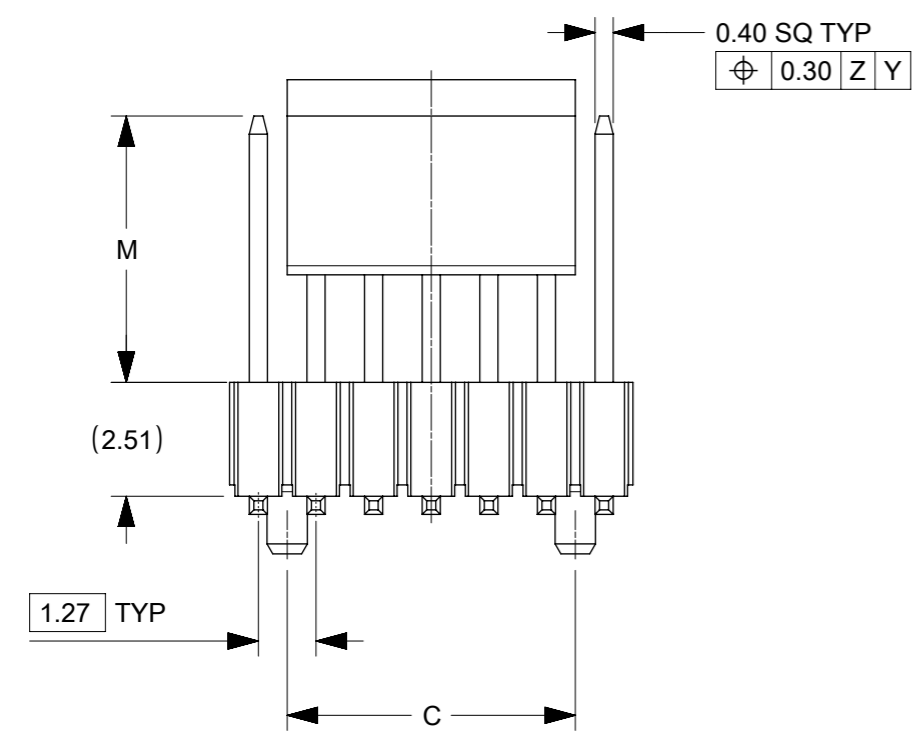
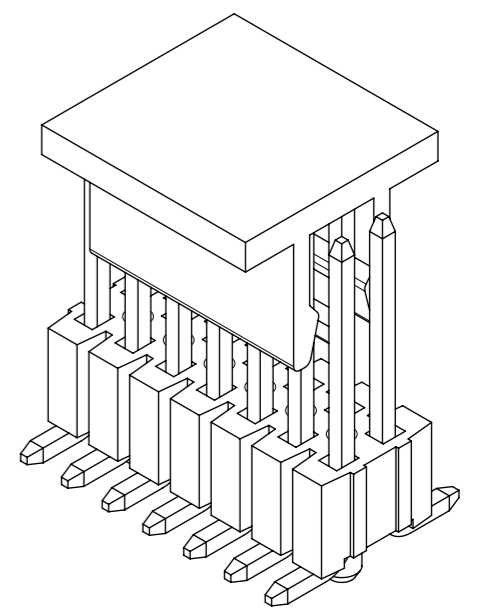

| THIS DRAWING CONTAINS INFORMATION THAT IS PROPRIETARY TO MOLEX ELECTRONIC TECHNOLOGIES, LLC AND SHOULD NOT BE USED WITHOUT WRITTEN PERMISSION | | | | | | | | | |
|---|---|------------|---------------------------------------|------------------------|---|----------|------------|--|--|
| QUALITY SYMBOLS ▽ = 0 ▽ = 0 ▽ = 0 ▼ = 0 ▽ = 0 ⊠ = 0 ■ = 0 ▽ = 0 | 2016/10/13 | 2017/03/20 | GENERAL TOLERANCES (UNLESS SPECIFIED) | | DIMENSION UNITS | SCALE | | | |
| | EC NO: 114621 DRWN: BGRSHOM CHK'D: REV APPR: ISHWARG | A6 | MM | INCH | MM | NTS | | | |
| | | | 4 PLACES | ± | ± | SKLIM01 | 2007/04/24 | | |
| | | | 3 PLACES | ± | ± | CHK'D BY | DATE | | |
| | | | 2 PLACES | ± | 0.2 | CWLAM | 2007/05/04 | | |
| | | | 1 PLACES | ± | ± | APPR BY | DATE | | |
| 0 PLACES | ± | ± | KWLEE | 2007/05/04 | | | | | |
| ANGULAR TOL = 3.0 | | | DRAWING SIZE | THIRD ANGLE PROJECTION | PRODUCT CUSTOMER DRAWING SERIES: 87933 MATERIAL NUMBER: SEE TABLE CUSTOMER: GENERAL MARKET DOCUMENT NUMBER: SD-87933-100 DOC TYPE: PSD DOC PART: 000 SHEET NUMBER: 1 OF 3 | | | | |
| DRAFT WHERE APPLICABLE MUST REMAIN WITHIN DIMENSIONS | | | A3 | | | | | | |

| | |
|----------------|--------------|
| RELEASE STATUS | RELEASE DATE |
|----------------|--------------|

CIRCUITS POSITION CONFIGURATION

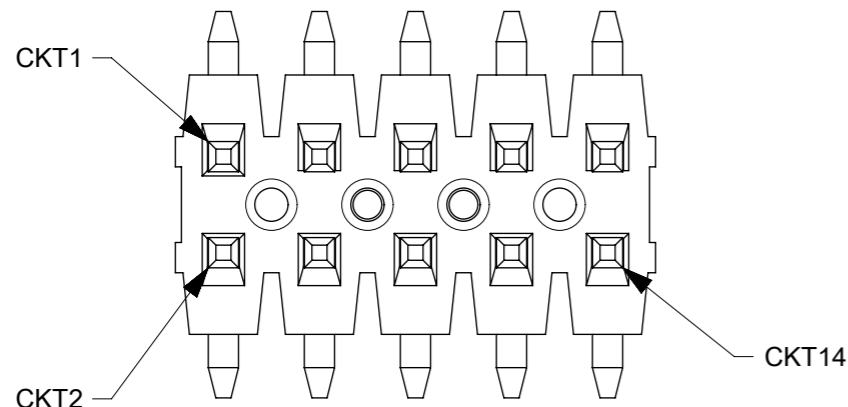

PART WITHOUT PEG AND CAP VERSION

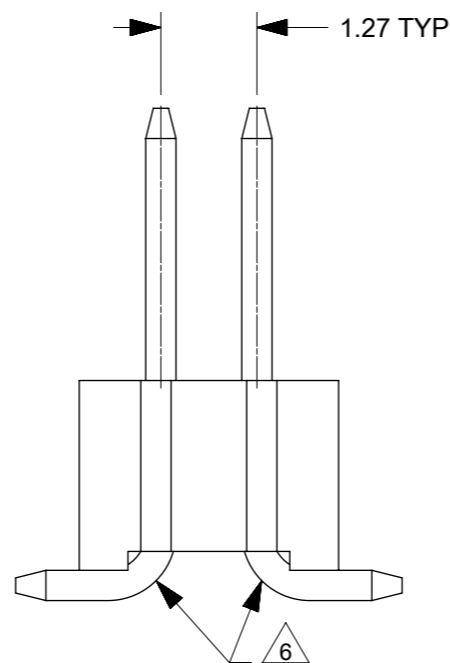
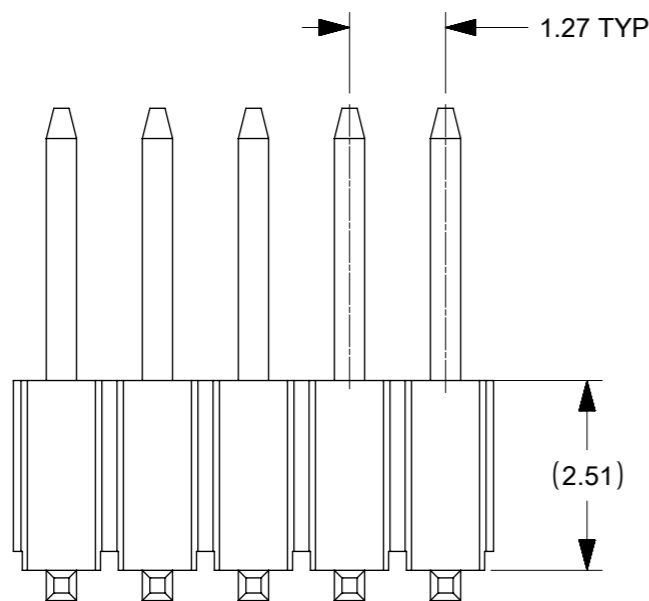

NOTES:

1. MATERIAL:
HSG: LCP, GLASS-FILLED, UL94V-0, COLOR: BLACK
CAP: NYLON, GLASS-FILLED, UL94V-0, COLOR: BLACK
PIN: 0.40MM SQ, COPPER ALLOY
2. PLATING TYPE:
(1) GOLD FLASH OVER
1.25µm MIN. NICKEL OVERALL.
(2) GOLD FLASH ON CONTACT AND
2.50µm MIN. TIN ON SOLDER TAIL OVER
1.25µm MIN. NICKEL OVERALL.
(3) 0.38µm MIN. GOLD PLATE ON CONTACT AND
2.00µm MIN. TIN ON SOLDER TAIL OVER
1.25µm MIN. NICKEL OVERALL.
(4) 0.76µm MIN. GOLD PLATE ON CONTACT AND
2.00µm MIN. TIN ON SOLDER TAIL OVER
1.25µm MIN. NICKEL OVERALL.
(5) 2.50µm MIN. TIN OVERALL
1.25µm MIN. NICKEL OVERALL
3. PACKAGING TYPE: SEE TABLE
4. PCB THICKNESS 1.60+/-0.10mm
5. PRODUCT SPECIFICATION: PS-87933-001
6. BEND DEPRESSION IS ACCEPTED SO LONG AS IT DOES NOT AFFECT THE OVERALL COPLANARITY OF TAIL
7. COPLANARITY IS TO BE MEASURED BY RESTING THE SOLDER TAIL ON A FLAT SURFACE
8. CAP POSITION TO BE LOCATED AT THE CENTER OF DIMENSION (A) REGARDLESS OF CIRCUIT SIZE
TOP SURFACE OF CAP TO BE FLAT FOR THE PURPOSE OF PICK & PLACE BY VACUUM SUCTION NOZZLE
9. IRREGULAR CIRCUIT CUTOFF WITHIN BREAKAWAY SECTION IS PERMISSIBLE. CUTTING OR CHIPPING OF THE MAIN BODY IS NOT ACCEPTABLE
10. PIN PUSH OUT FORCE: 0.4KgF IN EITHER DIRECTION
11. THE ABOVE CKT 14 IS FOR ILLUSTRATION PURPOSE ONLY
12. PACKAGING SPECIFICATION:
T&R: PK-89990-567
TRAY: PK-89990-568/ PK-87933-300

| THIS DRAWING CONTAINS INFORMATION THAT IS PROPRIETARY TO MOLEX ELECTRONIC TECHNOLOGIES, LLC AND SHOULD NOT BE USED WITHOUT WRITTEN PERMISSION | | | | | | | | | | | |
|---|---|--------------------------|---------------------------------------|------------------------|-----------------|-----------------|-----------------|--|----------|--------------|--|
| QUALITY SYMBOLS ▽ = 0 ▽ = 0 ▽ = 0 ▼ = 0 ▽ = 0 ⊠ = 0 ■ = 0 ▽ = 0 | EC NO: 114621 DRWN: BGRSHOM CHK'D: APPR: ISHWARG | 2016/10/13 2017/03/20 | GENERAL TOLERANCES (UNLESS SPECIFIED) | | DIMENSION UNITS | | SCALE | | | | |
| | | | MM | INCH | MM | NTS | | | | | |
| | | | 4 PLACES | ± | ± | DRWN BY | DATE | CUSTOM HEADER 1.27MM PITCH DUAL ROW HEADER, SINGLE WAFER, SMT | | | |
| | | | 3 PLACES | ± | ± | SKLIM01 | 2007/04/24 | | | | |
| | | | 2 PLACES | ± 0.2 | ± | CHK'D BY | DATE | | | | |
| | | | 1 PLACES | ± | ± | CWLAM | 2007/05/04 | PRODUCT CUSTOMER DRAWING | | | |
| 0 PLACES | ± | ± | APPR BY | DATE | | | | | | | |
| ANGULAR TOL = 3.0 | | DRAWING SIZE | | THIRD ANGLE PROJECTION | | SERIES | MATERIAL NUMBER | CUSTOMER | | | |
| DRAFT WHERE APPLICABLE MUST REMAIN WITHIN DIMENSIONS | | A3 | | | | 87933 | SEE TABLE | GENERAL MARKET | | | |
| | | | | | | DOCUMENT NUMBER | | DOC TYPE | DOC PART | SHEET NUMBER | |
| | | | | | | SD-87933-100 | | PSD | 000 | 2 OF 3 | |

| | |
|----------------|--------------|
| RELEASE STATUS | RELEASE DATE |
|----------------|--------------|

| CKT SIZE | DIMENSION | | |
|----------|-----------|-------|-------|
| | A | B | C |
| 04 | 2.54 | 1.27 | - |
| 06 | 3.81 | 2.54 | - |
| 08 | 5.08 | 3.81 | - |
| 10 | 6.35 | 5.08 | 3.81 |
| 12 | 7.62 | 6.35 | - |
| 14 | 8.89 | 7.62 | - |
| 16 | 10.16 | 8.89 | - |
| 18 | 11.43 | 10.16 | - |
| 20 | 12.70 | 11.43 | 10.16 |
| 22 | 13.97 | 12.70 | - |
| 24 | 15.24 | 13.97 | - |
| 26 | 16.51 | 15.24 | - |
| 28 | 17.78 | 16.51 | - |
| 30 | 19.05 | 17.78 | 16.51 |
| 32 | 20.32 | 19.05 | - |
| 34 | 21.59 | 20.32 | - |
| 36 | 22.86 | 21.59 | - |
| 38 | 24.13 | 22.86 | - |
| 40 | 25.40 | 24.13 | 22.86 |
| 42 | 26.67 | 25.40 | - |
| 44 | 27.94 | 26.67 | - |
| 46 | 29.21 | 27.94 | - |
| 48 | 30.48 | 29.21 | - |
| 50 | 31.75 | 30.48 | 29.21 |

| PART NUMBER IN PACKAGING OPTION | | | | | CKT SIZE | PEG | PLATE OPT. | VOID POSITION | DIMENSION | | |
|---------------------------------|---------------|----------------------|------------------|---------------|----------|-----|------------|---------------|-----------|------|------------|
| TRAY WITHOUT CAP | TRAY WITH CAP | TAPE & REEL WITH CAP | TUBE WITHOUT CAP | TUBE WITH CAP | | | | | G | F | MATING END |
| - | - | 87933-1228 | - | - | 12 | NO | 3 | - | 7.21 | 5.96 | 3.05 |
| - | - | 87933-2020 | - | - | 20 | NO | 5 | - | 9.21 | 8.01 | 5.10 |
| - | - | 87933-5028 | - | - | 50 | NO | 3 | - | 7.21 | 5.96 | 3.05 |

| | | | | | | | | | | |
|----------------------------|---|--------------|---------------------------------------|---|------------------|---|---------------|----------------------|--|--|
| QUALITY SYMBOLS | THIS DRAWING CONTAINS INFORMATION THAT IS PROPRIETARY TO MOLEX ELECTRONIC TECHNOLOGIES, LLC AND SHOULD NOT BE USED WITHOUT WRITTEN PERMISSION | | | | | | | | | |
| | 2016/10/13 | 2017/03/20 | GENERAL TOLERANCES (UNLESS SPECIFIED) | | DIMENSION UNITS | SCALE | | | | |
| | | | MM | INCH | MM | NTS | | | | |
| | 4 PLACES | ± | ± | DRWN BY | DATE | CUSTOM HEADER 1.27MM PITCH DUAL ROW HEADER,SINGLE WAFER,SMT | | | | |
| | 3 PLACES | ± | ± | SKLIM01 | 2007/04/24 | | | | | |
| | 2 PLACES | ± 0.2 | ± | CHK'D BY | DATE | | | | | |
| | 1 PLACES | ± | ± | CWLAM | 2007/05/04 | PRODUCT CUSTOMER DRAWING | | | | |
| | 0 PLACES | ± | ± | APPR BY | DATE | | | | | |
| | ANGULAR TOL = 3.0 | | DRAWING SIZE | THIRD ANGLE PROJECTION | KWLEE 2007/05/04 | | | | | |
| | DRAFT WHERE APPLICABLE MUST REMAIN WITHIN DIMENSIONS | | A3 | | | | | | | |
| A6 | | REV | APP | SERIES: 87933 MATERIAL NUMBER: SEE TABLE CUSTOMER: GENERAL MARKET | | | | | | |
| RELEASE STATUS | | RELEASE DATE | | DOCUMENT NUMBER: SD-87933-100 | | DOC TYPE: PSD | DOC PART: 000 | SHEET NUMBER: 3 OF 3 | | |

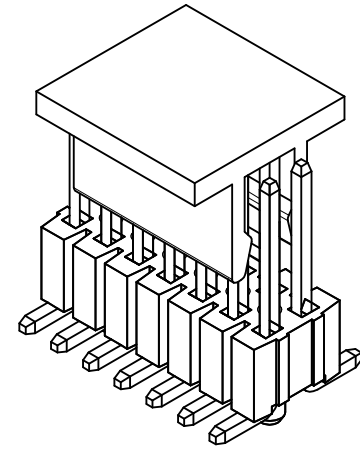
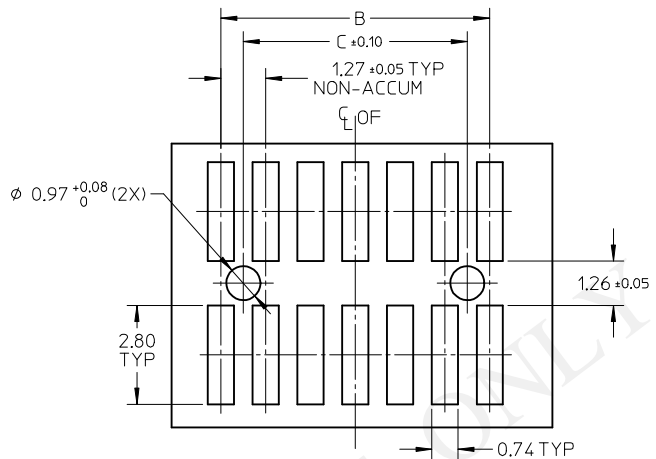
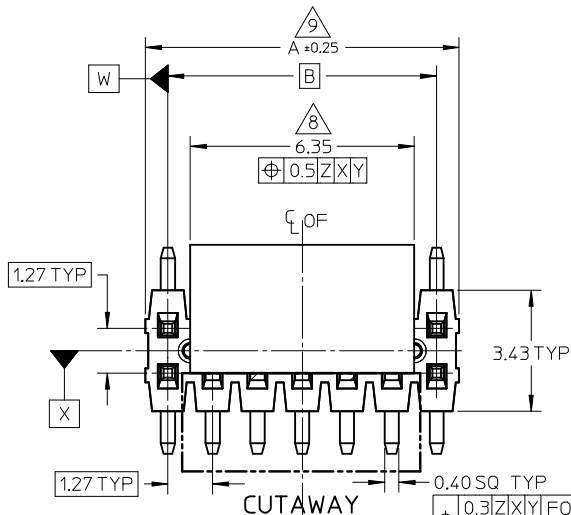

RECOMMENDED PCB LAYOUT: COMPONENT SIDE

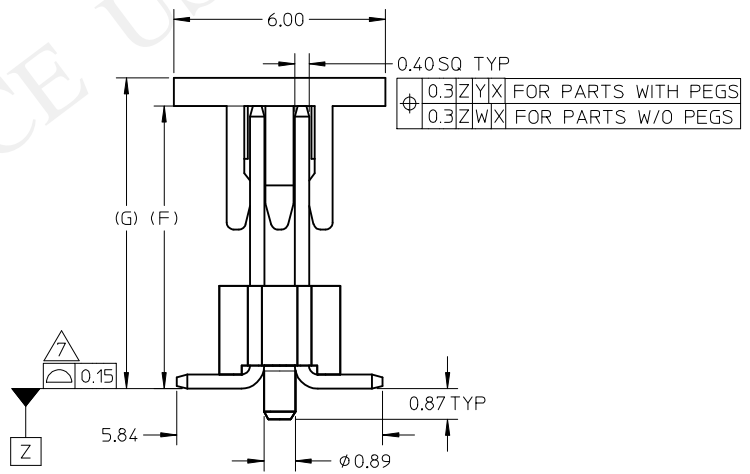
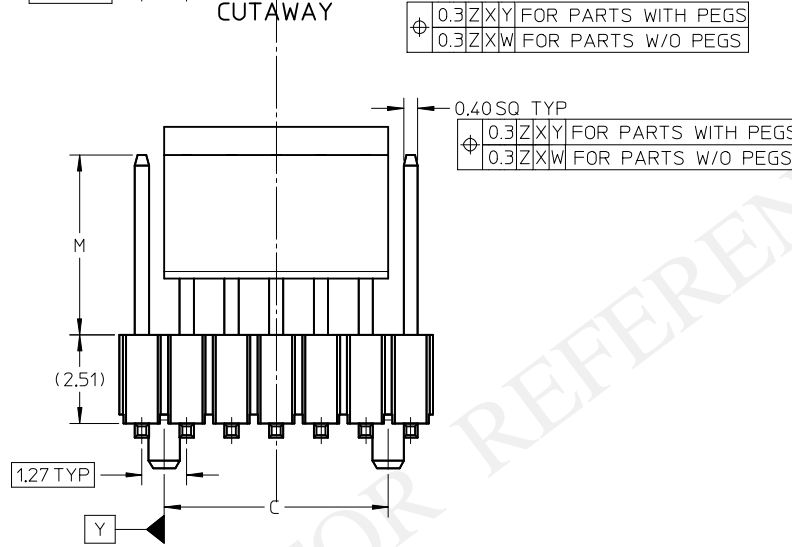

EM-87933-028

| | | | | | | |
|--|--|---|--|--|---|---------------------|
| SEE SHEET 3 EC NO: S2015-1260 DRWN: MRAMAKR SHINA 2015/05/04 CHKD: ATSEE 2015/05/04 APPR: MRAMAKR SHINA 2015/05/08 | QUALITY SYMBOLS $F_A=0$ $F_G=0$ $F_P=0$ | GENERAL TOLERANCES (UNLESS SPECIFIED) mm INCH 4 PLACES ± --- ± --- 3 PLACES ± --- ± --- 2 PLACES ± 0.20 ± --- 1 PLACE ± --- ± --- ANGULAR ± 3 ° | DIMENSION STYLE MM ONLY DRAWN BY DATE MRAMAKR SHINA 2015/05/04 CHECKED BY DATE ATSEE 2015/05/04 APPROVED BY DATE MRAMAKR SHINA 2015/05/08 MATERIAL NO. | SCALE NTS DESIGN UNITS METRIC THIRD ANGLE PROJECTION | TITLE CUSTOM HEADER 1.27MM PITCH DUAL ROW HEADER, SINGLE WAFER, SMT MOLEX INCORPORATED DOCUMENT NO. SD-87933-101 | SHEET NO. 1 OF 3 |
| | DRAFT WHERE APPLICABLE MUST REMAIN WITHIN DIMENSIONS | SEE TABLE | THIS DRAWING CONTAINS INFORMATION THAT IS PROPRIETARY TO MOLEX INCORPORATED AND SHOULD NOT BE USED WITHOUT WRITTEN PERMISSION | | | |
| | REV 1 | DESCRIPTION | SIZE A3 | | | |
| | 1 | 6 | 5 | 4 | 3 | 2 |

CIRCUITS POSITION CONFIGURATION

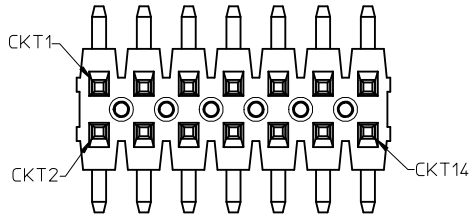

PART WITHOUT PEG AND CAP VERSION

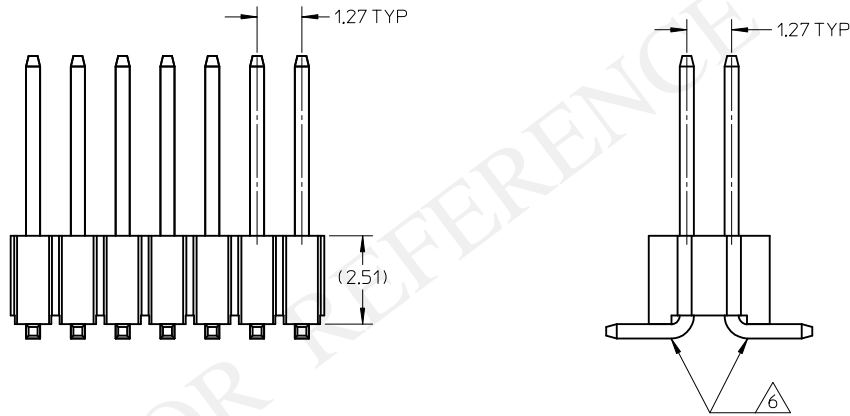

NOTES:

1. MATERIAL:
 - HSG: LCP, GLASS-FILLED, UL94V-0, COLOR: BLACK
 - CAP: NYLON, GLASS-FILLED, UL94V-0, COLOR: BLACK
 - PIN: 0.40MM SQ. COPPER ALLOY
2. PLATING TYPE:
 - (1) GOLD FLASH OVER
1.25µm MIN. NICKEL OVERALL.
 - (2) GOLD FLASH ON CONTACT AND
2.50µm MIN. TIN ON SOLDER TAIL OVER
1.25µm MIN. NICKEL OVERALL.
 - (3) 0.38µm MIN. GOLD PLATE ON CONTACT AND
2.00µm MIN. TIN ON SOLDER TAIL OVER
1.25µm MIN. NICKEL OVERALL.
 - (4) 0.76µm MIN. GOLD PLATE ON CONTACT AND
2.00µm MIN. TIN ON SOLDER TAIL OVER
1.25µm MIN. NICKEL OVERALL.
 - (5) 2.50µm MIN. TIN OVERALL
1.25µm MIN. NICKEL OVERALL.
3. PACKAGING TYPE: SEE TABLE
4. PCB THICKNESS 1.60+/-0.10mm
5. PRODUCT SPECIFICATION: PS-87933-001
6. BEND DEPRESSION IS ACCEPTED SO LONG AS IT DOES NOT AFFECT THE OVERALL COPLANARITY OF TAIL
7. COPLANARITY IS TO BE MEASURED BY RESTING THE SOLDER TAIL ON A FLAT SURFACE
8. CAP POSITION TO BE LOCATED AT THE CENTER OF DIMENSION (A) REGARDLESS OF CIRCUIT SIZE
TOP SURFACE OF CAP TO BE FLAT FOR THE PURPOSE OF PICK & PLACE BY VACUUM SUCTION NOZZLE
9. IRREGULAR CIRCUIT CUTOFF WITHIN BREAKAWAY SECTION IS PERMISSIBLE. CUTTING OR CHIPPING OF THE MAIN BODY IS NOT ACCEPTABLE
10. PIN PUSH OUT FORCE: 0.4Kgf IN EITHER DIRECTION
11. THE ABOVE CKT 14 IS FOR ILLUSTRATION PURPOSE ONLY
12. PACKAGING SPECIFICATION:
 - T&R: PK-89990-567
 - TRAY: PK-89990-568

EM-87933-028

| | | | | | | | | | | |
|--|---|---------------------------------------|--------------|----------------------------|---|--------------|---|------------------------|--|--|
| SEE SHEET 3 EC NO: S2015-1260 DRWN: MRAMAKRISHNA 2015/05/04 CHKD: ATSEE 2015/05/04 APPR: MRAMAKRISHNA 2015/05/08 | DESCRIPTION QUALITY SYMBOLS $F_A=0$ $F_C=0$ $F_P=0$ | GENERAL TOLERANCES (UNLESS SPECIFIED) | | DIMENSION STYLE MM ONLY | | SCALE NTS | DESIGN UNITS METRIC | THIRD ANGLE PROJECTION | | |
| | | | mm | INCH | DRAWN BY | DATE | TITLE | | | |
| | | 4 PLACES | ± --- | ± --- | MRAMAKRISHNA | 2015/05/04 | CUSTOM HEADER 1.27MM PITCH DUAL ROW HEADER, SINGLE WAFER, SMT | | | |
| | | 3 PLACES | ± --- | ± --- | CHECKED BY | DATE | | | | |
| 2 PLACES | ± 0.20 | ± --- | ATSEE | 2015/05/04 | MOLEX INCORPORATED | | | | | |
| 1 PLACE | ± --- | ± --- | APPROVED BY | DATE | | | | | | |
| | ANGULAR ± 3 ° | | MATERIAL NO. | | DOCUMENT NO. | | SHEET NO. | | | |
| | DRAFT WHERE APPLICABLE MUST REMAIN WITHIN DIMENSIONS | | SEE TABLE | | SD-87933-101 | | 2 OF 3 | | | |
| | | | SIZE A3 | | THIS DRAWING CONTAINS INFORMATION THAT IS PROPRIETARY TO MOLEX INCORPORATED AND SHOULD NOT BE USED WITHOUT WRITTEN PERMISSION | | | | | |

| CKT SIZE | DIMENSION | | |
|----------|-----------|-------|-------|
| | A | B | C |
| 04 | 2.54 | 1.27 | - |
| 06 | 3.81 | 2.54 | - |
| 08 | 5.08 | 3.81 | - |
| 10 | 6.35 | 5.08 | 3.81 |
| 12 | 7.62 | 6.35 | - |
| 14 | 8.89 | 7.62 | - |
| 16 | 10.16 | 8.89 | - |
| 18 | 11.43 | 10.16 | - |
| 20 | 12.70 | 11.43 | 10.16 |
| 22 | 13.97 | 12.70 | - |
| 24 | 15.24 | 13.97 | - |
| 26 | 16.51 | 15.24 | - |
| 28 | 17.78 | 16.51 | - |
| 30 | 19.05 | 17.78 | 16.51 |
| 32 | 20.32 | 19.05 | - |
| 34 | 21.59 | 20.32 | - |
| 36 | 22.86 | 21.59 | - |
| 38 | 24.13 | 22.86 | - |
| 40 | 25.40 | 24.13 | 22.86 |
| 42 | 26.67 | 25.40 | - |
| 44 | 27.94 | 26.67 | - |
| 46 | 29.21 | 27.94 | - |
| 48 | 30.48 | 29.21 | - |
| 50 | 31.75 | 30.48 | 29.21 |
| 64 | 40.64 | 39.37 | - |

| PART NUMBER IN PACKAGIN OPTION | | | | | CKT SIZE | PEG | PLATE OPT. | VOID POSITION | DIMENSION | | |
|--------------------------------|---------------|------------------------------|------------------|---------------|----------|-----|------------|---------------|-----------|------|--------------|
| TRAY WITHOUT CAP | TRAY WITH CAP | TAPE & REEL WITH CAP W/O PEG | TUBE WITHOUT CAP | TUBE WITH CAP | | | | | G | F | MATING END M |
| - | - | 87933-6400 | - | - | 64 | NO | 1 | - | 7.21 | 5.96 | 3.05 |

CAP POSITION ILLUSTRATION FOR REFERENCE

FOR ILLUSTRATION 14 CKT AS SHOWN

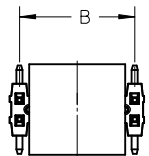

C/L OF CAP C/L OF DIM B

C/L OF DIM B = C/L OF CAP
FOR ODD CKT COLUMN

FOR ILLUSTRATION 64 CKT AS SHOWN

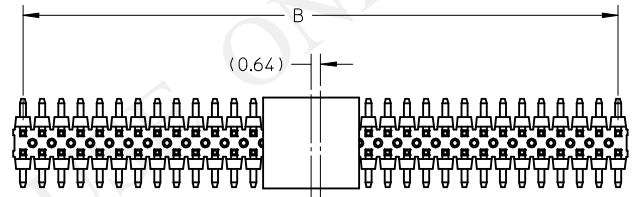

C/L OF DIM B IS OFFSET WITH C/L OF CAP
FOR EVEN CKT COLUMN

FOR REFERENCE

| | | | | | | | | | | | | |
|--|----------|---|--|-------|----------------------------|-----------------------------|--|--|------------------------|--|--|--|
| ADD P/N 87933-6400 EC NO: S2015-1260 DRWN:MRAMAKRISHNA 2015/05/04 CHKD:ATSEE 2015/05/04 APPR:MRAMAKRISHNA 2015/05/08 | REV 1 | DESCRIPTION QUALITY SYMBOLS $F_A=0$ $F_G=0$ $F_P=0$ | GENERAL TOLERANCES (UNLESS SPECIFIED) | | DIMENSION STYLE MM ONLY | | SCALE NTS | DESIGN UNITS METRIC | THIRD ANGLE PROJECTION | | | |
| | | | | mm | INCH | DRAWN BY MRAMAKRISHNA | DATE 2015/05/04 | TITLE CUSTOM HEADER 1.27MM PITCH DUAL ROW HEADER,SINGLE WAFER,SMT | | | | |
| | | | 4 PLACES | ± --- | ± --- | CHECKED BY ATSEE | DATE 2015/05/04 | MOLEX INCORPORATED | | | | |
| | | | 3 PLACES | ± --- | ± --- | APPROVED BY MRAMAKRISHNA | DATE 2015/05/08 | DOCUMENT NO. SD-87933-101 | | | | |
| 2 PLACES | ± 0.20 | ± --- | ANGULAR ± 3 ° | | MATERIAL NO. SEE TABLE | | SHEET NO. 3 OF 3 | | | | | |
| 1 PLACE | ± --- | ± --- | DRAFT WHERE APPLICABLE MUST REMAIN WITHIN DIMENSIONS | | SIZE A3 | | THIS DRAWING CONTAINS INFORMATION THAT IS PROPRIETARY TO MOLEX INCORPORATED AND SHOULD NOT BE USED WITHOUT WRITTEN PERMISSION | | | | | |

EM-87933-028