

PRODUCT NUMBER	QUANTITY PER REEL	PACKAGING
76785-Y01(LF)	15000	CARDBOARD REEL
76785-Y11(LF)	3000	CARDBOARD REEL

WHEN NEEDED, SUFFIX LETTER "LF" INDICATES THE PRODUCT IS RoHS COMPATIBLE, SEE NOTE 3

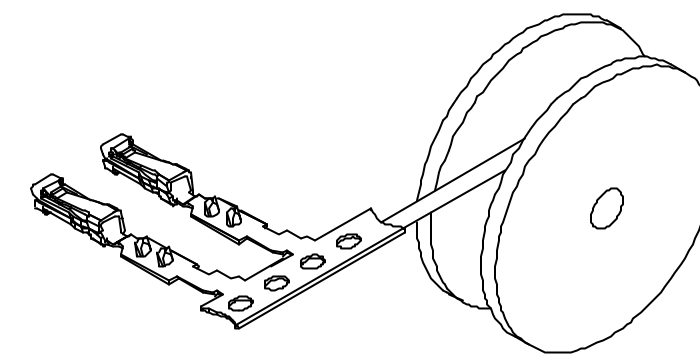

REELING AFTER STAMPING

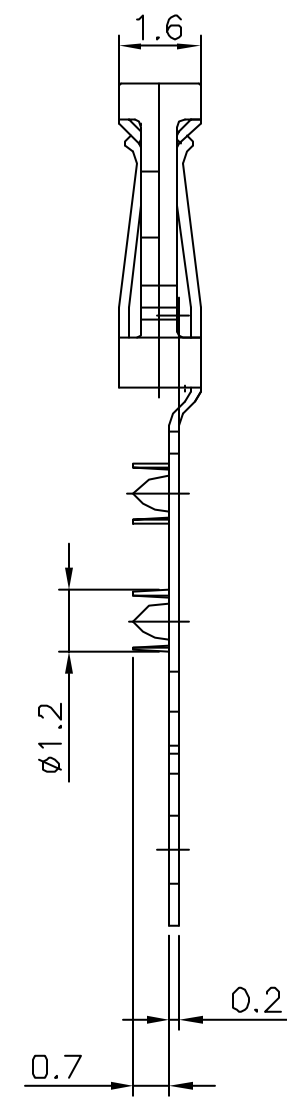
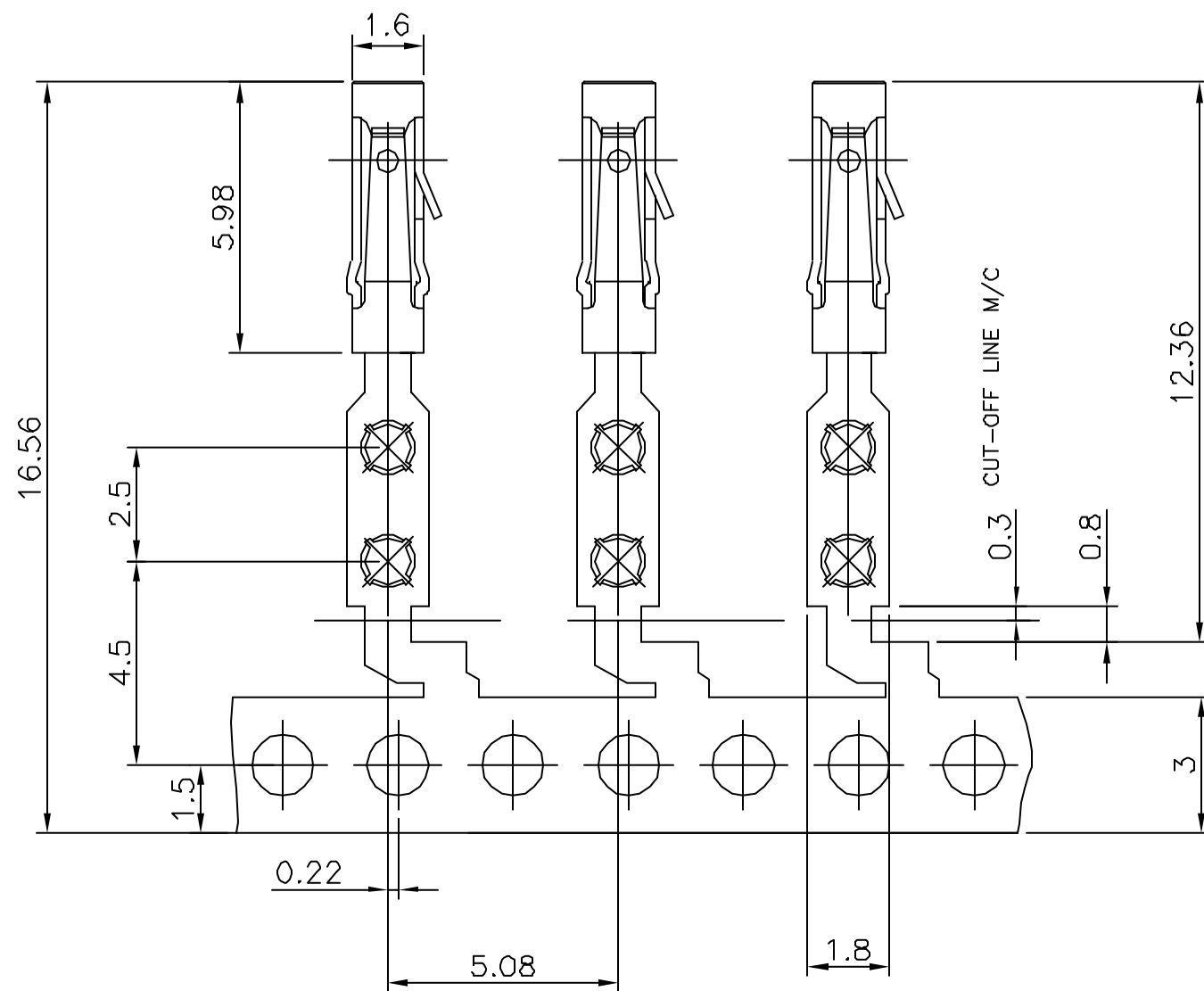

NOTES:

- 1 - MATERIAL: PHOSPHOR BRONZE, EXTRA HARD
- 2 - FOR APPLICATION DATA, SEE TA 338
- 3 - RoHS COMPATIBLE PRODUCT SPECIFICATIONS
 - a - PLATING:
 - "LF" MEANS THE PRODUCT IS LEAD-FREE, 2µm MINIMUM MATTE TIN OVER 1.27µm MINIMUM NICKEL UNDERPLATE.
 - b - LABELING:
 - MEETS PACKAGING SPECS AS PER GS-14-920
 - c - LEGAL STATEMENT: SEE GS-22-008

THE PRODUCT IS NOT INTENDED TO BE EXPOSED TO A MANUFACTURING SOLDER PROCESS.

76785-3XXLF	0.75µm Au MIN. OVER 1.3µm Ni MIN.	Sn OVER Ni	0.3 N MIN
			0.6 N MAX
76785-4XXLF	5µm Sn MIN. OVER 1.27µm Ni MIN.	Sn OVER Ni	0.3 N MIN
			0.6 N MAX
76785-3XX	0.75µm Au MIN. OVER 1.3µm Ni MIN.	SnPb OVER Ni	0.3 N MIN
			0.6 N MAX
76785-4XX	5µm SnPb MIN. OVER 0.1µm Ni MIN.	SnPb OVER Ni	0.3 N MIN
			0.6 N MAX
PLATING CODE	CONTACT AREA	SOLDER TAIL	WITHDRAWAL FORCE USING SQUARE PIN
PLATING EXPLANATION			0.61

mat'l. code		surface	tolerance	projection	product family
SEE NOTE		ISO 1302	ISO 406 ISO 111	1:1	DUFLEX
Ltr	ecn no	dr	date	tolerances unless otherwise specified	title
M	F05-0288	DLE	05.11.07	angle	DUFLEX
N	F06-0198	DLE	06.06.13	linear	TERMINAL
				0±2'	scale 10:1
				dr	D LEGRAND 06.06.12
				engr	P NIZZI 06.06.12
				chr	D LE 06.06.12
				appd	P NZ 06.06.12
sheet index	revision sheet				dwg no
					76785
					sheet 1 of 1 size A2
					type Product Customer Drawing