

LOC		DIST		REVISIONS			
CM	00	REV	DATE	BY	APPV	DATE	BY
G3	REVISED PER ECR-17-018755		16APR2018	BDA	SG		

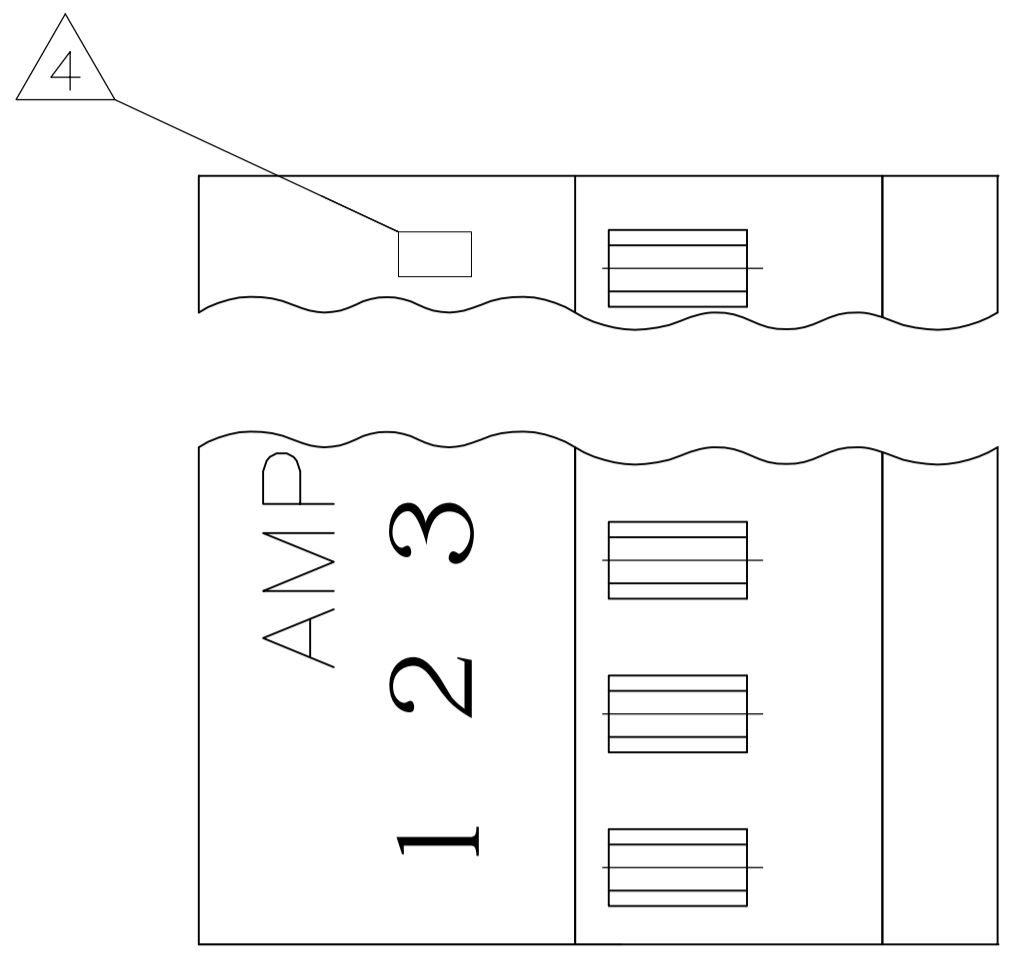

- 1 MATERIAL: CONNECTOR-NYLON UL94V-2 (RED).  
CONTACTS-0.30 [.012] THICK COPPER ALLOY  
BRIGHT TIN-LEAD 0.00203 [.000080] MINIMUM  
THICK FOR CONTACTS 641534-2 THRU 641534-8,  
MATTE WHISKER MITIGATED TIN PLATE 0.00203 [.000080]  
MINIMUM THICK OVER NICKEL UNDERPLATE FOR CONTACTS  
3-641534-2 THRU 3-641534-8.
- 2 CONTACTS ACCEPT 22 AWG WIRE WITH 1.52 [.060] MAXIMUM INSULATION DIAMETER.
- 3 CONTACTS MUST ACCEPT 0.36-0.51 [.014-.020] SQUARE OR ROUND POST AND REMAINED LOCKED IN POSITION.
- 4 IDENTIFICATION NUMBER FOR LAST CIRCUIT MAY NOT APPEAR ON ALL ASSEMBLIES.
- 5 DIMENSIONS IN BRACKETS ARE IN INCHES.
- 6 HOUSING FEATURES ARE: CLOSED END WITH LOCKING RAMP & LED CONTACT.
- 7 OBSOLETE PARTS: OBSOLETE CIS STREAMLINING PER D.RENAUD/D.SINISI
- 8 OBSOLETE PARTS

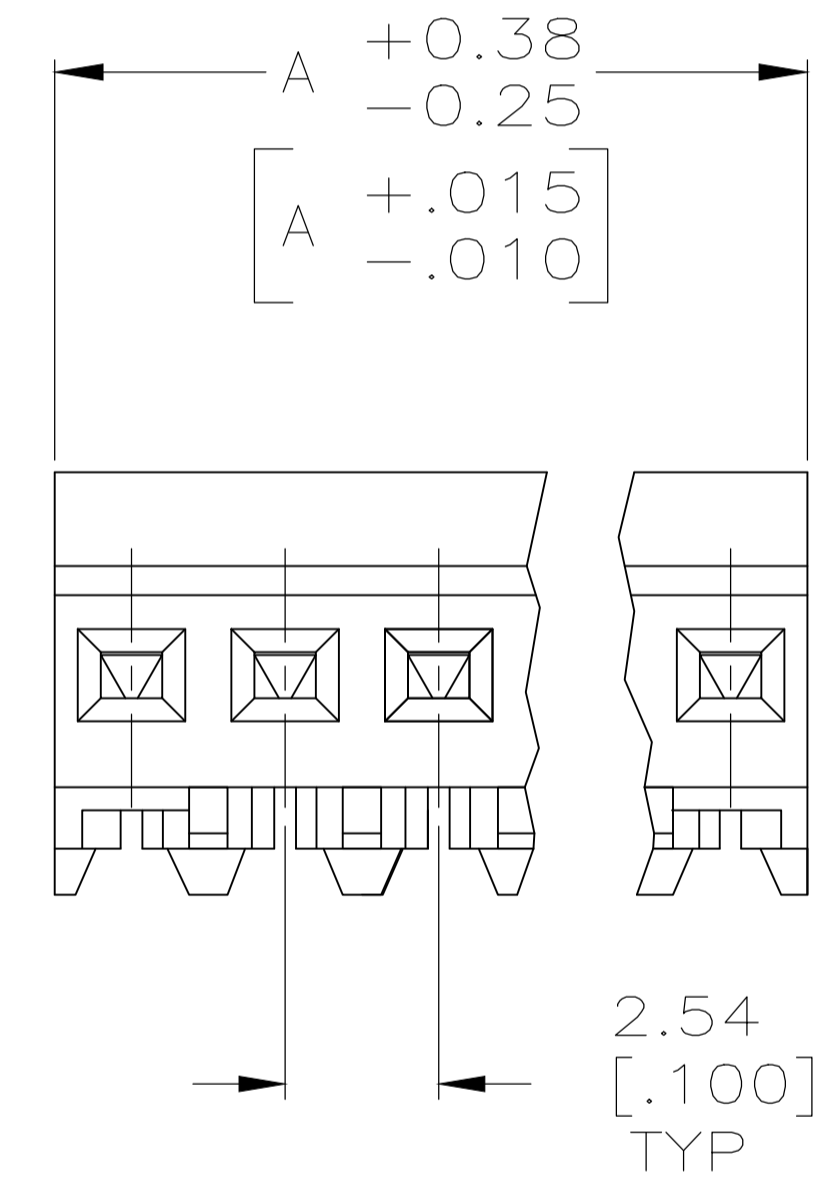
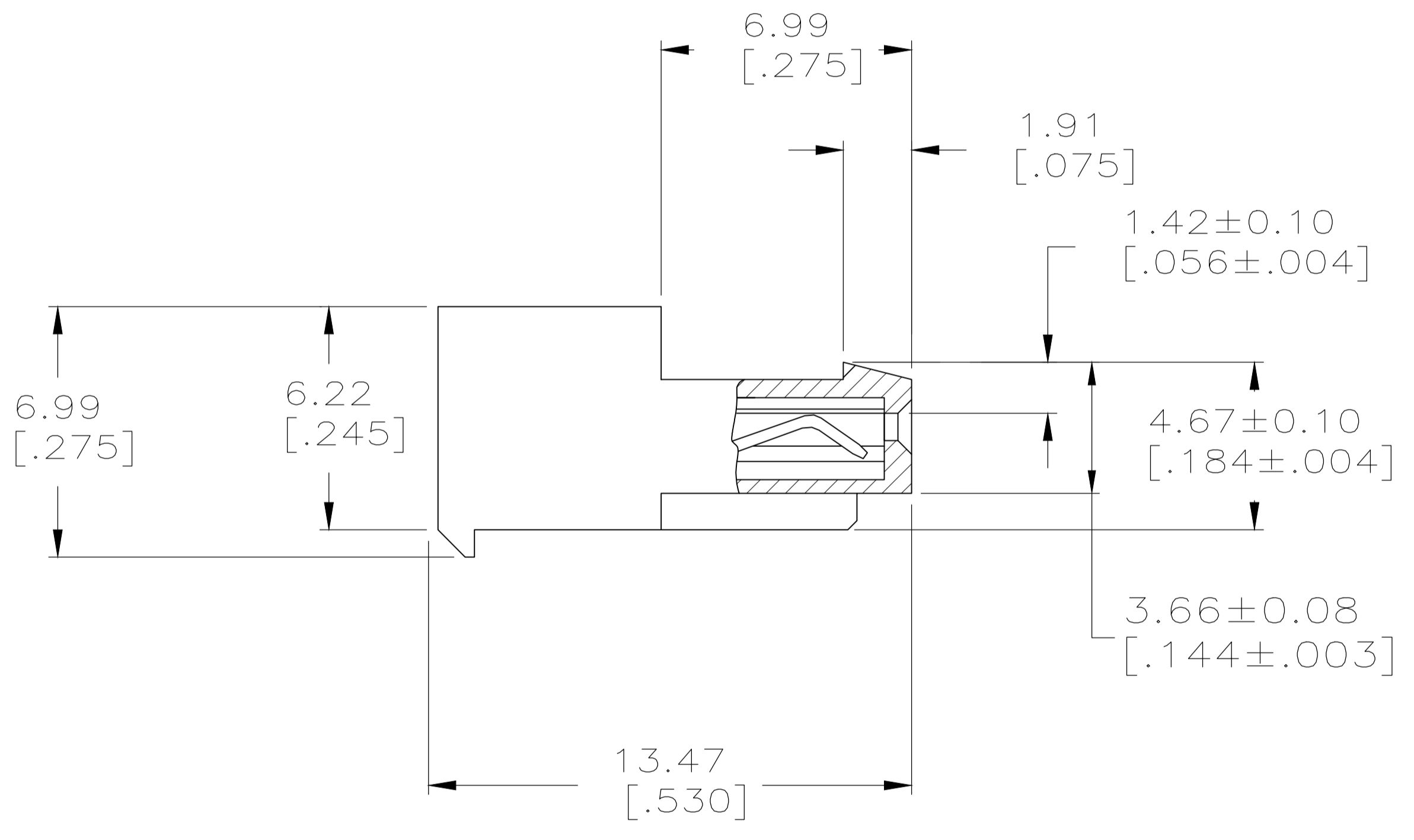

LEAD FREE	DIM A	NO.OF POSN	ASSEMBLY
	20.32 [.800]	8	3-641534-8
	10.16 [.400]	4	3-641534-4
	7.62 [.300]	3	3-641534-3
	5.08 [.200]	2	3-641534-2

CONTAINS LEAD	DIM A	NO.OF POSN	ASSEMBLY
8 SUPERSEDED	20.32 [.800]	8	<del>3-641534-8</del>
7 SUPERSEDED	10.16 [.400]	4	<del>3-641534-4</del>
8 SUPERSEDED	7.62 [.300]	3	<del>3-641534-3</del>
OBSOLETE	5.08 [.200]	2	<del>3-641534-2</del>

THIS DRAWING IS A CONTROLLED DOCUMENT.

DIMENSIONS: mm [INCHES]  
 TOLERANCES UNLESS OTHERWISE SPECIFIED:  
 0. PLC ±  
 1. PLC ±  
 2. PLC ± 0.13 [.005]  
 3. PLC ±  
 4. PLC ±  
 ANGLES ±

THIS DRAWING IS A CONTROLLED DOCUMENT.  
 S. HOOVER 10-DEC-2004  
 CJK 10-DEC-2004  
 D. ROSSI  
 D. ROSSI 10-DEC-2004  
 NAME: MTA-100 CONNECTOR ASSEMBLY, 22 AWG, FOR .014 TO .020 POST, SPECIAL  
 PRODUCT SPEC: 108-1050  
 APPLICATION SPEC: 114-1019

MATERIAL: 1  
 FINISH: 1  
 WEIGHT: A1 00779 641534  
 CUSTOMER DRAWING SCALE: 8:1 SHEET: 1 OF 1 REV: G3