

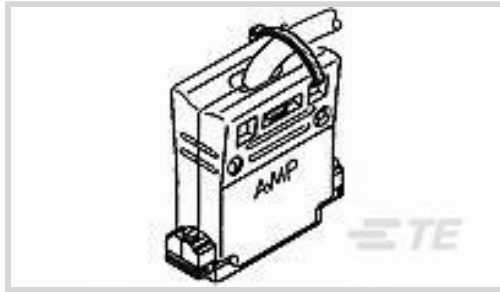

Connectors > D-Shaped Connectors > D-Sub Accessories > D-Sub Backshells & Clamps



D-Shaped Connector Accessories: **Cable Clamp Kit**

Cable Clamp Type: **Clam Shell**

Number of Positions: **37**

Compatible With Connector Shell Size: **4**

Shielded: **No**

Features

Product Type Features

Grommets	Without
Product Type	Accessory
D-Shaped Connector Accessories	Cable Clamp Kit

Configuration Features

Number of Positions	37
---------------------	----

Body Features

Shield Plating Material	None
Cable Clamp Material	Thermoplastic
Cable Clamp Type	Clam Shell
Cable Exit Angle	180° (In-Line), 90° (Right Angle)

Mechanical Attachment

Screw & Hole Thread Size	4-40
--------------------------	------

Dimensions

Cable Insulation Diameter Range	17.15 mm[.675 in]
---------------------------------	-------------------

Operation/Application

Compatible With Connector Shell Size	4
Shielded	No

Packaging Features

Packaging Quantity	1
--------------------	---

Packaging Method

Kit

Other

Comment

All parts are packaged unassembled., Straight or 90° cable exit is achieved by inserting AMP-TY Cable Ties through cable tie openings and clamping the cable to one housing half only.

Product Compliance

[For compliance documentation, visit the product page on TE.com>](#)

EU RoHS Directive 2011/65/EU

Compliant with Exemptions

EU ELV Directive 2000/53/EC

Not Compliant

China RoHS 2 Directive MIIT Order No 32, 2016

Restricted Materials Above Threshold

EU REACH Regulation (EC) No. 1907/2006

Current ECHA Candidate List: JUNE 2022 (224)
Candidate List Declared Against: JUL 2019 (201)
SVHC > Threshold:
Not Yet Reviewed

Halogen Content

Not Low Halogen - contains Br or Cl > 900 ppm.

Solder Process Capability

Not applicable for solder process capability

Product Compliance Disclaimer

This information is provided based on reasonable inquiry of our suppliers and represents our current actual knowledge based on the information they provided. This information is subject to change. The part numbers that TE has identified as EU RoHS compliant have a maximum concentration of 0.1% by weight in homogenous materials for lead, hexavalent chromium, mercury, PBB, PBDE, DBP, BBP, DEHP, DIBP, and 0.01% for cadmium, or qualify for an exemption to these limits as defined in the Annexes of Directive 2011/65/EU (RoHS2). Finished electrical and electronic equipment products will be CE marked as required by Directive 2011/65/EU. Components may not be CE marked. Additionally, the part numbers that TE has identified as EU ELV compliant have a maximum concentration of 0.1% by weight in homogenous materials for lead, hexavalent chromium, and mercury, and 0.01% for cadmium, or qualify for an exemption to these limits as defined in the Annexes of Directive 2000/53/EC (ELV). Regarding the REACH Regulation, the information TE provides on SVHC in articles for this part number is based on the latest European Chemicals Agency (ECHA) 'Guidance on requirements for substances in articles' posted at this URL: <https://echa.europa.eu/guidance-documents/guidance-on-reach>

Also in the Series | [AMPLIMITE Kit](#)



D-Sub Backshells & Clamps(135)



D-Sub Contact Accessories(1)



D-Sub Covers(3)



D-Sub Locking & Mounting(122)

Customers Also Bought

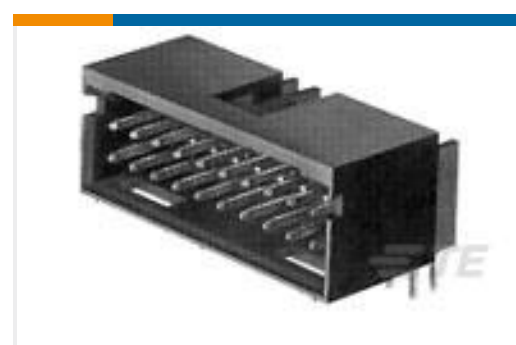
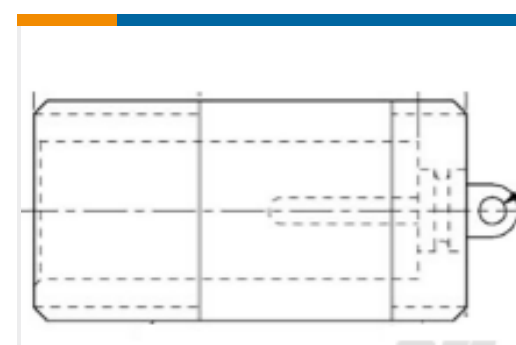
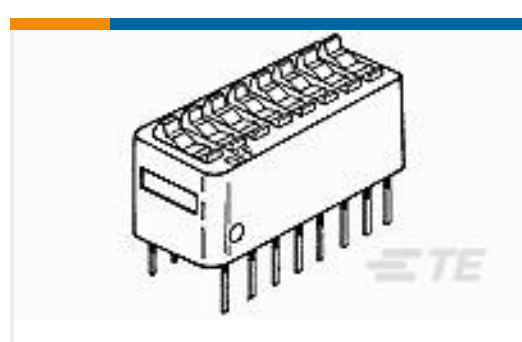
TE Part #5414946-2
PLUG, CBL, STR, SMB, PB FREETE Part #5787973-1
36 .8MM CHAMP RCPT ASSYTE Part #1-103673-9
20 MTE HDR SRRA LATCH W/HLDWNTE Part #532434-8
HDI RECP ASSY 4 ROW 220 POSTE Part #787003-3
.8MM LATCHING POST,BRDMT,BULKTE Part #104655-7
60 50/50 HDR DRST SFMNT .250TE Part #5-103167-3
12 MODII HDR DRRA SHRD LFTE Part #868092-1
LGH-1 RECEPTACLETE Part #3-435640-6
DIP SW 5 POSN SEALEDTE Part #5787131-2
36 .8MM CHAMP PLUG KIT

Documents

Product Drawings

[2 PC STRAIN RELIEF KIT,37P](#)

English

CAD Files

Customer View Model

[ENG_CVM_CVM_5745081-1_A.2d_dxf.zip](#)

English

[3D PDF](#)



3D

Customer View Model

[ENG_CVM_CVM_5745081-1_A.3d_igs.zip](#)

English

Customer View Model

[ENG_CVM_CVM_5745081-1_A.3d_stp.zip](#)

English

By downloading the CAD file I accept and agree to the [Terms and Conditions](#) of use.

Datasheets & Catalog Pages

[AMPLIMITE Subminiature D Connectors - Cable Connectors](#)

English

[AMPLIMITE Cable Connectors and Shielding Hardware Kits QRG](#)

English

Product Environmental Compliance

[TE Material Declaration](#)

English

Instruction Sheets

[Instruction Sheet \(U.S.\)](#)

English