

PRODUCT NUMBER  
SEE TABLE

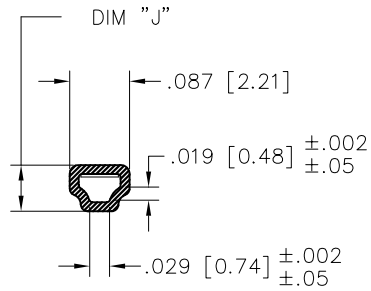

SECTION A-A

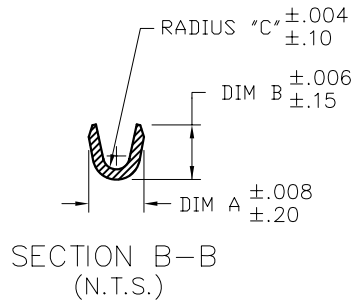

SECTION B-B  
(N.T.S.)

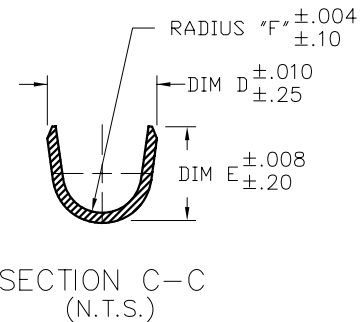

SECTION C-C  
(N.T.S.)

SIDES OF SPRING MAY NOT  
EXTEND BEYOND SIDE OF  
TERMINAL MORE THAN .004/.10

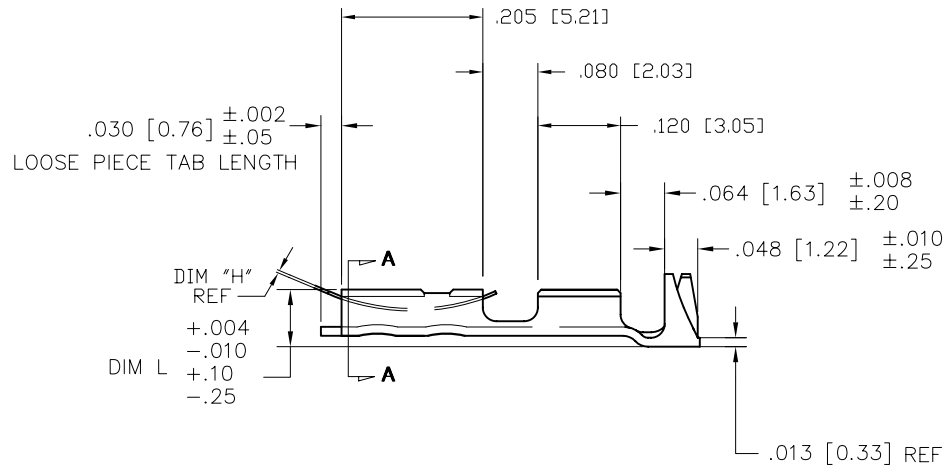
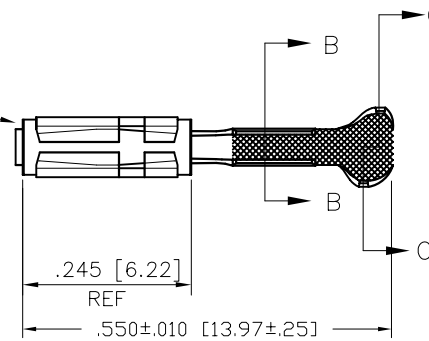

mat'l. code				surface	tolerance	projection	product family
SEE TABLE					✓		PV TERMINALS
ltr	ecn no	dr	date	tolerances unless otherwise specified		INCH/MM	title
AA	v08-0113	HTB	2008-03-28	angles	.XX±.01/.X±.3		MAXI PV™ RECEPTACLE CRIMP TO WIRE
AB	v08-0510	HTB	2008-12-02	linear	XXX+.005/XX+.13	scale 4:1	
-	-	-	-		XXXX+.0020/XXX+.051		
V	v05-0468	HTB	2005-05-27	dr	T. BREWBAKER	2006-04-18	sheet 1 of 3
W	v06-0218	HTB	2006-03-07	engr	T. BREWBAKER	2006-04-18	size
X	v06-0303	HTB	2006-04-18	chr	T. BREWBAKER	2006-04-18	A3
Y	v07-0218	HTB	2007-03-16	appd	T. BREWBAKER	2006-04-18	
sheet	revision	AB	AB	AB			type
index	sheet	1	2	3			Product Customer Drawing

PRODUCT NUMBER		AWG RANGE	MATERIAL AND PLATING		SPRING THICKNESS		BODY			
REELED	LOOSE PC.		BODY : 1/4 HD BRASS	SPRING : BE-CU HEAT TREATED	DIM H	DIM J	DIM L			
					ENGLISH	METRIC	ENGLISH	METRIC	ENGLISH	METRIC
46220-000	46224-000	18-20	OBS.							
46230-000	46234-000	22-26	OBS.							
46240-000	46244-000	28-32	OBS.							
46221-000LF	46225-000LF	18-20		40µ"/1.02µm MIN GOLD OVER		0.0058	0.147	0.067	1.70	0.083
46231-000LF	46235-000LF	22-26		50µ"/1.27µm MIN NICKLE IN	GOLD FLASH	0.0058	0.147	0.067	1.70	0.083
46241-000	46245-000	28-32	OBS.	CONTACT AREA (NOTE 4)						
46222-000LF	47418-000LF	18-20		75µ"/1.91µm MIN GOLD OVER		0.0075	0.191	0.067	1.70	0.083
46232-000LF	47419-000LF	22-26		50µ"/1.27µm MIN NICKLE IN	GOLD FLASH	0.0075	0.191	0.067	1.70	0.083
46242-000	47420-000	28-32	OBS.	CONTACT AREA (NOTE 4)						
46223-000LF	47387-000LF	18-20		40µ"/1.02µm MIN GOLD OVER		0.0075	0.191	0.067	1.70	0.083
46233-000LF	47384-000LF	22-26		50µ"/1.27µm MIN NICKLE IN	GOLD FLASH	0.0075	0.191	0.067	1.70	0.083
46243-000	47403-000	28-32	OBS.	CONTACT AREA (NOTE 4)						
46226-000LF	46227-000LF	18-20		40µ"/1.02µm MIN GOLD OVER		0.0048	0.122	0.067	1.70	0.083
46236-000LF	46237-000LF	22-26		50µ"/1.27µm MIN NICKLE IN	GOLD FLASH	0.0048	0.122	0.067	1.70	0.083
46246-000	46247-000	28-32	OBS.	CONTACT AREA (NOTE 4)						
46228-000	46229-000	18-20	OBS.							
46238-000	46239-000	22-26	OBS.	OBSOLETE						
46248-000	46249-000	28-32	OBS.							
46580-000	46581-000	18-20	OBS.							
46590-000	46591-000	22-26	OBS.	OBSOLETE						
46600-000	46601-000	28-32	OBS.							
47388-000	47391-000	18-20	OBS.							
47389-000	47392-000	22-26	OBS.	OBSOLETE						
47390-000	47393-000	28-32	OBS.							
47612-000			OBS.							
47613-000			OBS.	OBSOLETE						
47614-000			OBS.							
47621-000			OBS.	OBSOLETE						
47622-000			OBS.	OBSOLETE						
47653-000			OBS.	OBSOLETE						
47733-000			OBS.							
47734-000			OBS.	OBSOLETE						
47735-000			OBS.							
47736-000	46582-000	18-20	OBS.							
47737-000	46592-000	22-26	OBS.	OBSOLETE						
47738-000	46602-000	28-32	OBS.							
48188-000	48189-000	22-26	OBS.	OBSOLETE						

SEE SHEET 3 FOR PRODUCTS WITH LEAD-FREE TIN PLATING.

mat'l. code SEE TABLE				surface ✓	tolerance	projection ⊕	product family PV TERMINALS	
ltr	ecn no	dr	date	tolerances unless otherwise specified		INCH/MM scale 1:1	title MAXI PV™ RECEPTACLE CRIMP TO WIRE	
AB				angles	.XX±.01/.X±.3		dwg no 46220	
				linear	.XXX±.005/.XX±.13 XXXX±.0020/.XXX±.051		sheet 2 of 3 A3	
				dr	T. BREWBAKER	2006-04-18	type Product Customer Drawing	
				engr	T. BREWBAKER	2006-04-18		
				chr	T. BREWBAKER	2006-04-18		
				appd	T. BREWBAKER	2006-04-18		
sheet index	revision							
	sheet							

PRODUCT NUMBER		AWG RANGE	MATERIAL AND PLATING		SPRING THICKNESS		BODY					
REELED	LOOSE PC.				DIM H		DIM J		DIM L			
ENGLISH	METRIC				ENGLISH	METRIC	ENGLISH	METRIC	ENGLISH	METRIC		
46580-000LF	46581-000LF	18-20	BODY : 1/4 HD BRASS		SPRING : BE-CU HEAT TREATED		0.0075	0.191	0.067	1.70	0.083	2.11
46590-000LF	46591-000LF	22-26	HOT DIPPED TIN (NOTE 7)		TIN PLATED		0.0075	0.191	0.067	1.70	0.083	2.11
46600-000LF	46601-000LF	28-32					0.0075	0.191	0.067	1.70	0.083	2.11
47388-000LF	47391-000LF	18-20					0.0058	0.147	0.067	1.70	0.083	2.11
47389-000LF	47392-000LF	22-26	HOT DIPPED TIN (NOTE 7)		TIN PLATED		0.0058	0.147	0.067	1.70	0.083	2.11
47390-000LF	47393-000LF	28-32					0.0058	0.147	0.067	1.70	0.083	2.11
47736-000LF	46582-000LF	18-20					0.0048	0.122	0.067	1.70	0.083	2.11
47737-000LF	46592-000LF	22-26	HOT DIPPED TIN (NOTE 7)		TIN PLATED		0.0048	0.122	0.067	1.70	0.083	2.11
47738-000LF	46602-000LF	28-32					0.0048	0.122	0.067	1.70	0.083	2.11

AWG RANGE	WIRE BARREL						INSULATION BARREL									
	DIM A		DIM B		DIM C		INSULATION DIA. RANGE FOR DISCRETE TERMINALS		INSULATION DIA. RANGE WHEN USED WITH MAXI LATCH HSG.		DIM D		DIM E		DIM F	
	ENGLISH	METRIC	ENGLISH	METRIC	ENGLISH	METRIC	ENGLISH	METRIC	ENGLISH	METRIC	ENGLISH	METRIC	ENGLISH	METRIC	ENGLISH	METRIC
18-20	0.110	2.79	0.110	2.79	0.021	0.53	0.042 - 0.103	1.07 - 2.62	0.042 - 0.060	1.07 - 1.52	0.139	3.53	0.123	3.12	0.050	1.27
22-26	0.070	1.78	0.070	1.78	0.017	0.43	0.036 - 0.103	0.91 - 2.62	0.036 - 0.060	0.91 - 1.52	0.139	3.53	0.123	3.12	0.050	1.27
28-30	0.054	1.37	0.058	1.47	0.011	0.28	0.028 - 0.054	0.71 - 1.37	0.028 - 0.054	0.71 - 1.37	0.115	2.92	0.110	2.79	0.040	1.02

NOTES:

- FOR DIMENSIONS OF WIRE BARREL AND INSULATION BARREL SEE TABLE.
- PART TO MATE WITH .025±.002 [0.64±0.05] SQ. PIN.
- APPLICABLE SPECIFICATIONS:
  - BUS-12-096 : PRODUCT SPECIFICATION
  - TA-213 : CRIMP SPECIFICATION FOR TERMINALS USED WITH MAXI-LATCH HOUSINGS.
  - TA-356 : CRIMP SPECIFICATION FOR CONTACTS NOT USED IN HOUSINGS.
- FINISH TO BE AS SPECIFIED IN CONTACT AREA. REMAINDER OF TOP OF PART TO BE GOLD FLASH OVER 50µ"/1.27µm NICKEL. BACKSIDE OF TERMINALS PLATED WITH 30µ"/0.76µm NICKEL ONLY.
- PRODUCT MEETS EUROPEAN UNION DIRECTIVES AND OTHER COUNTRY REGULATIONS AS DESCRIBED IN GS-22-008.
- THIS PRODUCT IS NOT INTENDED TO BE EXPOSED TO MANUFACTURING SOLDER PROCESSES.
- THIS PRODUCT HAS 100% TIN PLATING IN THE INTERFACE AND HAS NOT BEEN TESTED FOR WHISKER GROWTH IN ALL INTERCONNECT ENVIRONMENTS.

mat'l. code SEE TABLE				surface <input checked="" type="checkbox"/>		tolerance		projection		product family PV TERMINALS	
ltr	ecn no	dr	date	tolerances unless otherwise specified				INCH/MM		title MAXI PV™ RECEPTACLE CRIMP TO WIRE	
AB				angles	linear	.XX±.01/.X±.3 .XXX±.005/.XX±.13 .XXXX±.0020/.XXX±.051		scale 1:1		sheet 3 of 3 size 46220 A3	
				dr	T. BREWBAKER	2006-04-18				dwg no 46220	
				engr	T. BREWBAKER	2006-04-18				type Product Customer Drawing	
				chr	T. BREWBAKER	2006-04-18					
				appd	T. BREWBAKER	2006-04-18					
sheet index	revision sheet										