

NOTES

1. MATERIAL: BRASS, 0.39mm THICK
2. FINISH: UNPLATED (35725-3000/1800/1900)  
POST-TIN PLATED (35725-3010/1810/1910)
3. MATING RECEPTACLE TERMINAL: 35725-36\*0(L)  
35725-37\*0(M)  
35725-38\*0(S)

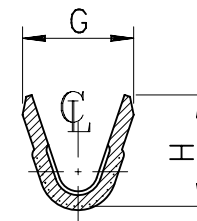

SECTION A-A'

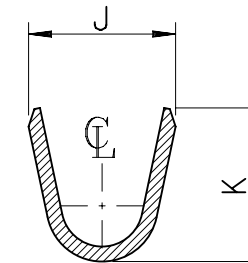

SECTION B-B'

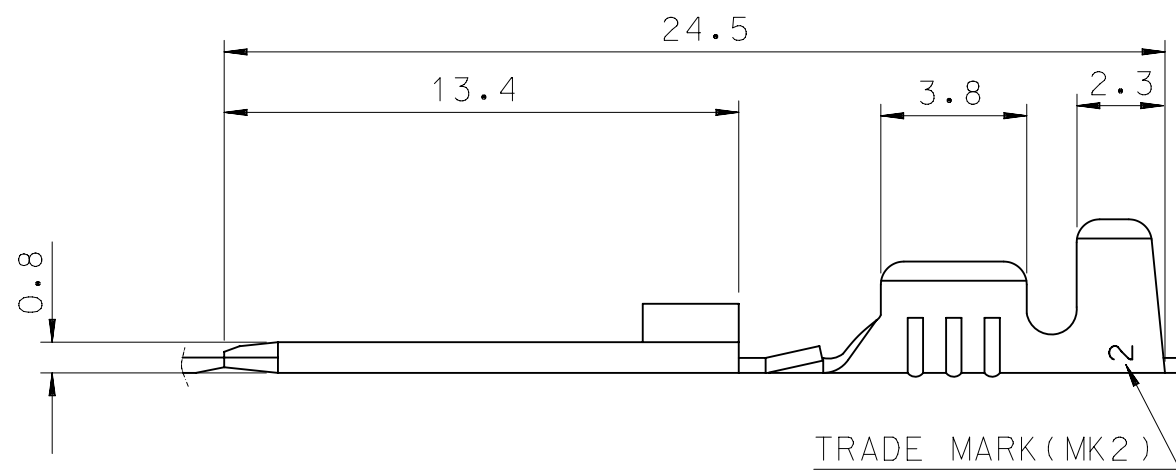

| ENG.NO.    | G    | H   | J   | K   | WIRE RANGE | SIZE |
|------------|------|-----|-----|-----|------------|------|
| 35725-30*0 | 2.85 | 2.9 | 3.8 | 4.0 | AWG#22-#20 | S    |
| 35725-18*0 | 3.4  | 3.6 | 5.2 | 5.2 | AWG#18-#14 | M    |
| 35725-19*0 | 5.3  | 4.5 | 6.2 | 5.6 | AWG#14-#12 | L    |

|   |  |                     |      |                                    |  |            |  |                            |  |
|---|--|---------------------|------|------------------------------------|--|------------|--|----------------------------|--|
| THIS DRAWING CONTAINS INFORMATION THAT IS PROPRIETARY TO MOLEX ELECTRONIC TECHNOLOGIES, LLC AND SHOULD NOT BE USED WITHOUT WRITTEN PERMISSION |  |                     |      |                                    |  |            |  |                            |  |
| DIMENSION UNITS<br><b>mm</b>  |  | SCALE<br><b>5:1</b> |      | CURRENT REV DESC: OBSOLETE PART NO |  |            |  | <b>molex</b>               |  |
| GENERAL TOLERANCES (UNLESS SPECIFIED)   |  |                     |      | EC NO: 628886                      |  |            |  |                            |  |
|   |  | MM                  | INCH | DRWN: VLOKESHA                     |  | 2019/10/11 |  | .250 SLIP-ON TAB           |  |
| 4 PLACES ±  |  |                     |      | CHK'D: GGA                         |  | 2020/01/13 |  | PRODUCT CUSTOMER DRAWING   |  |
| 3 PLACES ±  |  |                     |      | APPR: GGA                          |  | 2020/01/13 |  | DOCUMENT NUMBER            |  |
| 2 PLACES ±  |  |                     |      | INITIAL REVISION:                  |  | 1993/03/05 |  | SD-35725-XXX0              |  |
| 1 PLACE ±   |  |                     |      | DRWN: W.Y.YANG                     |  | 1993/03/05 |  | DOC TYPE DOC PART REVISION |  |
| 0 PLACES ±  |  |                     |      | APPR: C.W.LEE                      |  | 1993/03/05 |  | PSD 001 C1                 |  |
| ANGULAR TOL ± 0.5°  |  |                     |      | THIRD ANGLE PROJECTION             |  | DRAWING    |  | MATERIAL NUMBER            |  |
| DRAFT WHERE APPLICABLE MUST REMAIN WITHIN DIMENSIONS  |  |                     |      | B-SIZE                             |  | SERIES     |  | CUSTOMER                   |  |
|   |  |                     |      |                                    |  | 35725      |  | SEE CHART                  |  |
|   |  |                     |      |                                    |  |            |  | GENERAL MARKET             |  |
|   |  |                     |      |                                    |  |            |  | SHEET NUMBER               |  |
|   |  |                     |      |                                    |  |            |  | 1 OF 1                     |  |