

SECT. A-A
(SCALE 10 : 1)

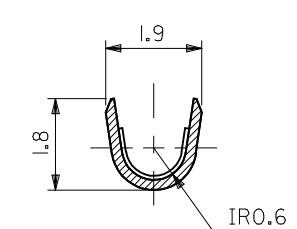

SECT. B-B
(SCALE 10 : 1)

注記 NOTES:
1. 一般公差 : ±0.4
GENERAL TOLERANCES: ±0.4

材料 MATERIAL 黄銅 BRASS 0.2 t
仕上げ FINISH —
適用電線範囲 WIRE RANGE AWG#22-#28
被覆外径 INS. RANGE φ 1.1~1.5

REVISED EC NO.: J2017-0317 DRAWINGS CHKD: APPR: MSASAO	2017/03/06 2017/03/15	DESCRIPTION	
GENERAL TOLERANCES (UNLESS SPECIFIED)			
0.25 UNDER	±0.03	DRAWN BY DATE H.HASEGAWA 1993/07/09 CHECKED BY DATE H.HIRAMOTO 1993/07/09 APPROVED BY DATE M.FUKUSHIMA 1993/07/09 MATERIAL NO. SEE CHART	
0.25 OVER 0.5 UNDER	±0.05		
0.5 OVER 0 UNDER	±0.1		
0 OVER 10 UNDER	±0.2		
10 OVER 30 UNDER	±0.25		
30 OVER	±0.3		
ANGULAR	±3 °		
DRAFT WHERE APPLICABLE MUST REMAIN WITHIN DIMENSIONS			
SIZE A3	THIS DRAWING CONTAINS INFORMATION THAT IS PROPRIETARY TO MOLEX ELECTRONIC TECHNOLOGIES, LLC AND SHOULD NOT BE USED WITHOUT WRITTEN PERMISSION		

ニッケル (2 μm MIN.) 下地 金 (0.35 μm MIN.) GOLD (0.35 μm MIN.) OVER NICKEL (2 μm MIN.)	39-00-0337	I854GL	バラ端子 LOOSE
銅 (0.5 μm MIN.) 下地 錫 (0.9 μm MIN.) TIN (0.9 μm MIN.) OVER COPPER (0.5 μm MIN.)	39-00-0335	I854TL	バラ端子 LOOSE
	39-00-0280	I854T	連鎖状端子 CHAIN
メッキ PLATING	EDP.NO.	ENG.NO.	形状 FORM

DIMENSION STYLE MM ONLY	SCALE 5:1	DESIGN UNITS METRIC	THIRD ANGLE PROJECTION
TITLE 0.62 DIA CRIMP MALE TERM			
DOCUMENT NO. SD-1854*			SHEET NO. 1 OF 1

