

KEY OPTION
SEE TABLE
SCALE 2:1

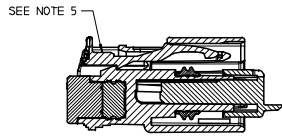

SECTION B-B
SCALE 2:1

(RECEPTACLE INSERT WITH SHORTING BAR
SHOWN IN THE PRE-LOCK POSITION)
SEE NOTE #2

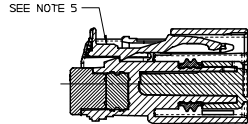

SECTION B-B
SCALE 2:1

(RECEPTACLE INSERT WITH SHORTING BAR
SHOWN IN THE FULL-LOCK POSITION)
SEE NOTE #2

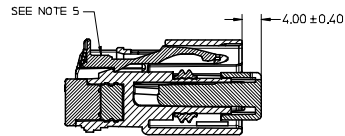

SECTION B-B
SCALE 2:1

(RECEPTACLE INSERT WITH SHOWN
IN THE PRE-LOCK POSITION)
SEE NOTE #2

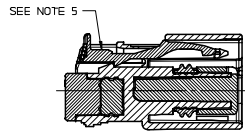

SECTION B-B
SCALE 2:1

(RECEPTACLE INSERT WITH SHOWN
IN THE FULL-LOCK POSITION)
SEE NOTE #2

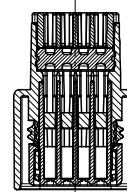
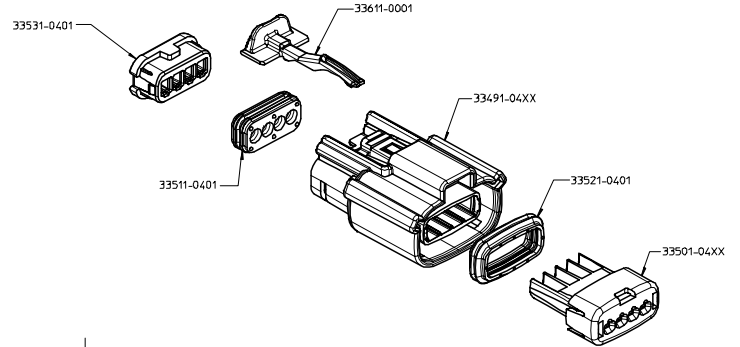

SECTION A-A
SCALE 2:1

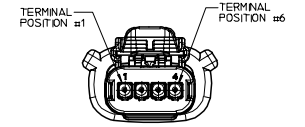

REAR VIEW
(WIRE HARNESS SIDE)

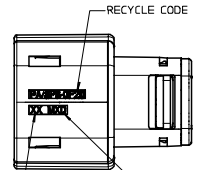
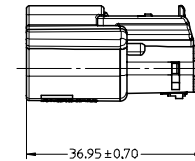
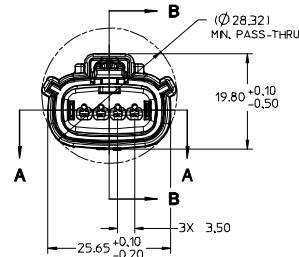

HOUSING MOLD CAVITY ID.

NOTES: UNLESS OTHERWISE SPECIFIED

- DESIGNED TO MATE WITH THE BLADE HOUSING ASSEMBLY SPECIFIED IN MOLEX CHARTERED DRAWING SD-33481-041 OR DEVICE CONNECTION AS SPECIFIED IN DRAWING E-33581-041.
- ASSEMBLY SHIPPED WITH RECEPTACLE INSERT IN PRE-LOCK POSITION (SEE SECTION B-B PRE-LOCK). UPON FULL TERMINAL ASSEMBLY, EACH RECEPTACLE INSERT MUST BE SNAPPED INTO ITS FINAL-LOCK POSITION.
- FOR RECEPTACLE TERMINALS TO BE USED WITH THIS ASSEMBLY, SEE DRAWING SD-33012-001.
- SYSTEM TO BE USED WITH WIRE WITHIN DIAMETER RANGE OF 1.2mm TO 2.4mm.
- OPTIONAL CPA SHOWN IN ALL VIEWS. SEE TABLE FOR SPECIFIC ASSEMBLY OPTION AND NUMBER. CPA MUST BE INSERTED TO THE PRE-LOCK POSITION, AS SHOWN IN SECTION B-B. WHEN SEATED CORRECTLY, CPA DOES NOT MOVE FREELY. ENGAGEMENT FORCE TO MOVE CPA FROM PRE-LOCK TO FINAL LOCK POSITION WHEN UNMATED: 40N MIN. DISENGAGEMENT FORCE TO MOVE CPA FROM FINAL LOCK TO PRE-LOCK POSITION: 3N MIN.
- MATERIAL: SPS/NYLON BLEND, 20% GLASS FILLED.
- SHALL CONFORM TO PACKAGING SPECIFICATION PK-30907-896.
- SHALL CONFORM TO PRODUCT SPECIFICATION PS-33471-000.
- PACKAGING: IN THE EVENT THAT INSERT IS FOUND IN THE SEATED (FINAL LOCK) POSITION. REFER TO MOLEX SPECIFICATION PS-34646-001. AVAILABLE AT WWW.MOLEX.COM.



SCALE 1:1

REDRAWN EEC NO: UAL2006-0435 DRWING:RFFIHS 2006/02/26 CHKDRG:RFFIHS 2006/02/27 APPR:SHARTEAU 2006/02/27	QUALITY SYMBOLS	GENERAL TOLERANCES (UNLESS SPECIFIED)		DIMENSION STYLE		SCALE	DESIGN UNITS	THIRD ANGLE PROJECTION
	 	mm	INCH	MM ONLY		1:1	METRIC	
	4 PLACES ± 0.10 3 PLACES ± 0.15 2 PLACES ± 0.20 1 PLACE ± 0.30			DRAWN BY: D.GRIFFITHS DATE: 05-02-03		TITLE: MX150 STANDARD CONNECTOR RCPT 1 ROW HSG SEALED, 4 WAY		
	ANGULAR ± 3°			CHECKED BY: DATE: 05-02-03		MOLEX MOLEX INCORPORATED		
			APPROVED BY: DATE: 05-02-03		DOCUMENT NO. SD-33471-041		SHEET NO. 1 OF 2	
DRAFT WHERE APPLICABLE MUST REMAIN WITHIN DIMENSIONS			SEE TABLE		THIS DRAWING CONTAINS INFORMATION THAT IS PROPRIETARY TO MOLEX INCORPORATED AND SHOULD NOT BE USED WITHOUT WRITTEN PERMISSION			

ASSEMBLY PART NUMBER	HOUSING PART NUMBER	COLOR	KEYING OPTION	DIMENSIONS (DEGREES)		CAVITY TYPE & STATUS X = PLUGGED				MAT SEAL CAP	CPA	INTERFACE SEAL	MAT SEAL	INSERT / TPA
				A	B	1	2	3	4					
33471-0401	33491-0401	BLACK	A	60	60					33531-0401	-	33521-0401	33511-0401	33501-0401
33471-0402	33491-0402	LT.GRAY	B	60	30					33531-0401	-	33521-0401	33511-0401	33501-0401
33471-0403	33491-0403	BROWN	C	30	60					33531-0401	-	33521-0401	33511-0401	33501-0401
33471-0404	33491-0404	GREEN	D	30	30					33531-0401	-	33521-0401	33511-0401	33501-0401
33471-0405	33491-0405	CUSTOM	TBD	TBD	TBD					33531-0401	-	33521-0401	33511-0401	33501-0401
33471-0406	33491-0401	BLACK	A	60	60					33531-0401	33611-0001	33521-0401	33511-0401	33501-0401
33471-0407	33491-0402	LT.GRAY	B	60	30					33531-0401	33611-0001	33521-0401	33511-0401	33501-0401
33471-0408	33491-0403	BROWN	C	30	60					33531-0401	33611-0001	33522-0401	33511-0401	33501-0401
33471-0409	33491-0404	GREEN	D	30	30					33531-0401	33611-0001	33521-0401	33511-0401	33501-0401
33471-0410	33491-0405	CUSTOM	TBD	TBD	TBD					33531-0401	33611-0001	33521-0401	33511-0401	33501-0401
33471-0411	33491-0401	BLACK	A	60	60				X	33531-0401	-	33521-0401	33511-0401	33501-0401
33471-0412	33491-0402	LT.GRAY	B	60	30				X	33531-0401	-	33522-0401	33511-0401	33501-0401
33471-0413	33491-0403	BROWN	C	30	60				X	33531-0401	-	33522-0401	33511-0401	33501-0401
33471-0414	33491-0404	GREEN	D	30	30				X	33531-0401	-	33522-0401	33511-0401	33501-0401
33471-0415	33491-0405	CUSTOM	TBD	TBD	TBD				X	33531-0401	-	33522-0401	33511-0401	33501-0401
33471-0416	33491-0401	BLACK	A	60	60				X	33531-0401	33611-0001	33522-0401	33511-0401	33501-0401
33471-0417	33491-0402	LT.GRAY	B	60	30				X	33531-0401	33611-0001	33522-0401	33511-0401	33501-0401
33471-0418	33491-0403	BROWN	C	30	60				X	33531-0401	33611-0001	33522-0401	33511-0401	33501-0401
33471-0419	33491-0404	GREEN	D	30	30				X	33531-0401	33611-0001	33522-0401	33511-0401	33501-0401
33471-0420	33491-0405	CUSTOM	TBD	TBD	TBD				X	33531-0401	33611-0001	33522-0401	33511-0401	33501-0401
33471-0421	33491-0401	BLACK	A	60	60	X			X	33531-0401	-	33522-0401	33511-0401	33501-0401
33471-0422	33491-0402	LT.GRAY	B	60	30	X			X	33531-0401	-	33522-0401	33511-0401	33501-0401
33471-0423	33491-0403	BROWN	C	30	60	X			X	33531-0401	-	33522-0401	33511-0401	33501-0401
33471-0424	33491-0404	GREEN	D	30	30	X			X	33531-0401	-	33522-0401	33511-0401	33501-0401
33471-0425	33491-0405	CUSTOM	TBD	TBD	TBD	X			X	33531-0401	-	33522-0401	33511-0401	33501-0401
33471-0426	33491-0401	BLACK	A	60	60	X			X	33531-0401	33611-0001	33522-0401	33511-0401	33501-0401
33471-0427	33491-0402	LT.GRAY	B	60	30	X			X	33531-0401	33611-0001	33522-0401	33511-0401	33501-0401
33471-0428	33491-0403	BROWN	C	30	60	X			X	33531-0401	33611-0001	33522-0401	33511-0401	33501-0401
33471-0429	33491-0404	GREEN	D	30	30	X			X	33531-0401	33611-0001	33522-0401	33511-0401	33501-0401
33471-0430	33491-0405	CUSTOM	TBD	TBD	TBD	X			X	33531-0401	33611-0001	33522-0401	33511-0401	33501-0401
33471-0431	33491-0401	BLACK	A	60	60					33531-0401	-	33522-0401	-	33501-0401
33471-0432	33491-0402	LT.GRAY	B	60	30					33531-0401	-	33522-0401	-	33501-0401
33471-0433	33491-0403	BROWN	C	30	60					33531-0401	-	33522-0401	-	33501-0401
33471-0434	33491-0404	GREEN	D	30	30					33531-0401	-	33522-0401	-	33501-0401
33471-0435	33491-0405	CUSTOM	TBD	TBD	TBD					33531-0401	-	33522-0401	-	33501-0401
33471-0436	33491-0401	BLACK	A	60	60					33531-0401	-	33522-0401	33511-0401	33501-0402
33471-0437	33491-0402	LT.GRAY	B	60	30					33531-0401	-	33522-0401	33511-0401	33501-0402
33471-0438	33491-0403	BROWN	C	30	60					33531-0401	-	33522-0401	33511-0401	33501-0402
33471-0439	33491-0404	GREEN	D	30	30					33531-0401	-	33522-0401	33511-0401	33501-0402
33471-0440	33491-0405	CUSTOM	TBD	TBD	TBD					33531-0401	-	33522-0401	33511-0401	33501-0402
33471-0441	33491-0401	BLACK	A	60	60	X	X	X	X	33531-0401	-	33522-0401	33511-0401	33501-0401
33471-0442	33491-0402	LT.GRAY	B	60	30	X	X	X	X	33531-0401	-	33522-0401	33511-0401	33501-0401
33471-0443	33491-0403	BROWN	C	30	60	X	X	X	X	33531-0401	-	33522-0401	33511-0401	33501-0401
33471-0444	33491-0404	GREEN	D	30	30	X	X	X	X	33531-0401	-	33522-0401	33511-0401	33501-0401
33471-0445	33491-0405	CUSTOM	TBD	TBD	TBD	X	X	X	X	33531-0401	-	33522-0401	33511-0401	33501-0401
33471-0446	33491-0401	BLACK	A	60	60					33531-0401	33611-0001	33522-0401	33511-0401	33501-0402
33471-0447	33491-0402	LT.GRAY	B	60	30					33531-0401	33611-0001	33522-0401	33511-0401	33501-0402
33471-0448	33491-0403	BROWN	C	30	60					33531-0401	33611-0001	33522-0401	33511-0401	33501-0402
33471-0449	33491-0404	GREEN	D	30	30					33531-0401	33611-0001	33522-0401	33511-0401	33501-0402
33471-0450	33491-0405	CUSTOM	TBD	TBD	TBD					33531-0401	33611-0001	33522-0401	33511-0401	33501-0402
33471-0451	33491-0401	BLACK	A	60	60				X	33531-0401	-	33522-0401	33511-0401	33501-0402
33471-0452	33491-0401	BLACK	A	60	60	X	X	X	X	33531-0401	-	33522-0401	33511-0401	33501-0402
33471-0453	33491-0402	LT.GRAY	B	60	30	X	X	X	X	33531-0401	-	33522-0401	33511-0401	33501-0402
33471-0454	33491-0403	BROWN	C	30	60	X	X	X	X	33531-0401	-	33522-0401	33511-0401	33501-0402
33471-0455	33491-0404	GREEN	D	30	30	X	X	X	X	33531-0401	-	33522-0401	33511-0401	33501-0402
33471-0456	33491-0405	CUSTOM	TBD	TBD	TBD	X	X	X	X	33531-0401	-	33522-0401	33511-0401	33501-0402
33471-0457	33491-0404	GREEN	D	30	30				X	33531-0401	-	33522-0401	33511-0401	33501-0402

REDRAWN EC NO: UAU2006-0435 DRWNGR/H/HS 2006/07/26 CHKDRG/H/HS 2006/07/21 APPR: SHARTEAU 2006/07/21	QUALITY SYMBOLS	GENERAL TOLERANCES (UNLESS SPECIFIED)	DIMENSION STYLE	SCALE	DESIGN UNITS	THIRD ANGLE PROJECTION	
	▽=0 ▽=0	mm INCH 4 PLACES ± --- ± --- 3 PLACES ± --- ± --- 2 PLACES ± 0.10 ± --- 1 PLACE ± 0.3 ± --- ANGULAR ± 3°	MM ONLY	1:1	METRIC	DRAWN BY DATE D.GR IFF ITHS 05-02-03 CHECKED BY DATE D.GR IFF ITHS 05-02-03 APPROVED BY DATE D.GR IFF ITHS 05-02-03	TITLE MX150 STANDARD CONNECTOR RCPT 1 ROW HSG SEALED, 4 WAY
	DRAFT WHERE APPLICABLE MUST REMAIN WITHIN DIMENSIONS	SEE TABLE	MATERIAL NO.	DOCUMENT NO.	SHEET NO.	MOLEX INCORPORATED SD-33471-041 2 OF 2	
	THIS DRAWING CONTAINS INFORMATION THAT IS PROPRIETARY TO MOLEX INCORPORATED AND SHOULD NOT BE USED WITHOUT WRITTEN PERMISSION						