

PLEASE CHECK WWW.MOLEX.COM FOR LATEST PART INFORMATION

Part Number: **0191930152**
Status: **Active**
Overview: VersaKrimp Terminals and Splices
Description: VersaKrimp Ring Tongue Terminal for 8 AWG Wire, Stud Size 1/4" (M6)

Documents:

Drawing (PDF) Product Specification PS-19902-013-001 (PDF)
Product Specification PS-19902-011-001 (PDF) RoHS Certificate of Compliance (PDF)

Agency Certification

CSA LR18689
 UL E32244

General

Product Family Ring and Spade Terminals
 Series 19193
 Crimp Quality Equipment Yes
 Overview VersaKrimp Terminals and Splices
 Product Name VersaKrimp
 Type Ring
 UPC 800755049992

Physical

Barrel Type Closed - Brazed
 Insulation None
 Material - Plating Mating Tin
 Net Weight 2.939/g
 Packaging Type Bag
 Plating min - Mating 2.540µm
 Plating min - Termination 2.540µm
 Stud Size 1/4" (M6)
 Termination Interface: Style Crimp or Compression
 Wire Size AWG 8
 Wire Size mm² 6.60-10.50

Solder Process Data

Lead-freeProcess Capability N/A

Material Info

Engineering Number D-350-14

Reference - Drawing Numbers

Product Specification PS-19902-011-001, PS-19902-013-001
 Sales Drawing SD-19193-016-001

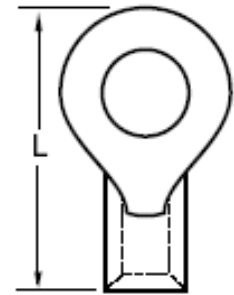

Series image - Reference only

EU ELV

Not Relevant

EU RoHS

Compliant

China RoHS

REACH SVHC

Not Contained Per -
 D(2020)4578-DC (25
 June 2020)

Halogen-Free

Status

Low-Halogen

For more information, please visit [Contact US](#)

China ROHS

Green Image

ELV

Not Relevant

RoHS Phthalates

Not Contained

Search Parts in this Series

19193 Series

Application Tooling | FAQ

Tooling specifications and manuals are found by selecting the products below. Crimp Height Specifications are then contained in the Application Tooling Specification document.

Global

Description	Product #
Manual Putt Pump Hydraulic System, Die set required	<u>192860117</u>
Die Set (large) for the HHLS Hydraulic Crimper	<u>192900001</u>
Manual tool for Crimping non-insulated 8AWG thru 4/0 Terminals	<u>192940008</u>
Hydraulic Dieless Crimping Tool	<u>638161700</u>
Hand Crimp Tool	<u>640013900</u>

RHT1080 Hand Crimp Tool	<u>640034400</u>
Square "DIN" style dies for 8 AWG	<u>640037670</u>
Crimp Head for the AT-200 Pneumatic Hand Tool	<u>640074400</u>

This document was generated on 07/15/2020

PLEASE CHECK WWW.MOLEX.COM FOR LATEST PART INFORMATION