

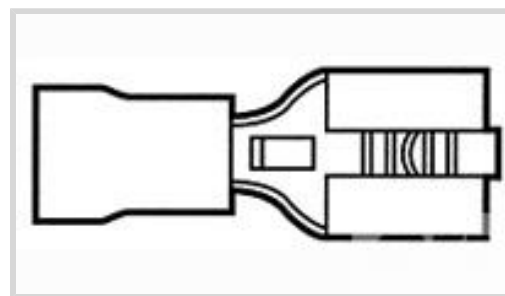

Terminals & Splices > Quick Disconnects



Terminal & Splice Type: **Receptacle**

Wire Size: 2050 – 5180 CMA

Mating Tab Width: 6.35 mm [.25 in]

Features

Product Type Features

Wire Stop	No
Terminates To	Wire & Cable
Insertion Force	Normal
Sealable	No
Insulated	Yes

Configuration Features

Connection Capacity	Single
---------------------	--------

Electrical Characteristics

Voltage (Max)	300 V
---------------	-------

Body Features

Insulation Material	Nylon
Fully Insulated	No
Plating Material	Tin

Contact Features

Terminal Type	Receptacle
Terminal & Splice Type	Receptacle
Terminal Orientation	Straight
Contact Base Material	Brass
Crimp Type	Compression
Barrel Type	Closed

Mechanical Attachment



Mating Retention Type	Dimple
Wire Insulation Support	With

Dimensions

Accepts Wire Insulation Diameter Range	4.06 mm[.16 in]
Overall Length	21.3 mm[.838 in]
Wire Size	2050 – 5180 CMA
Mating Tab Width	6.35 mm[.25 in]
Mating Tab Thickness	.81 mm[.032 in]

Usage Conditions

Operating Temperature Range	105 °C[221 °F]
-----------------------------	----------------

Packaging Features

Packaging Quantity	500
Packaging Method	Loose Piece

Other

Barrel Color	Blue
--------------	------

Product Compliance

[For compliance documentation, visit the product page on TE.com>](#)

EU RoHS Directive 2011/65/EU	Compliant
EU ELV Directive 2000/53/EC	Compliant
China RoHS 2 Directive MIIT Order No 32, 2016	No Restricted Materials Above Threshold
EU REACH Regulation (EC) No. 1907/2006	Current ECHA Candidate List: JAN 2019 (197) Candidate List Declared Against: JAN 2019 (197)
Halogen Content	Not Low Halogen - contains Br or Cl > 900 ppm.
Solder Process Capability	Not applicable for solder process capability

Product Compliance Disclaimer

This information is provided based on reasonable inquiry of our suppliers and represents our current actual knowledge based on the information they provided. This information is subject to change. The part numbers that TE has identified as EU RoHS compliant have a maximum concentration of 0.1% by weight in homogenous materials for lead, hexavalent chromium, mercury, PBB, PBDE, DBP, BBP, DEHP, DIBP, and 0.01% for cadmium, or qualify for an exemption to these limits as defined in the Annexes of Directive 2011/65/EU (RoHS2). Finished electrical and electronic equipment products will be CE marked as required by Directive 2011/65/EU. Components may not be CE marked. Additionally, the part numbers that TE has identified as EU ELV compliant have a maximum concentration of 0.1% by weight in homogenous materials for lead, hexavalent chromium, and mercury, and 0.01% for cadmium, or qualify for an exemption to these limits

as defined in the Annexes of Directive 2000/53/EC (ELV). Regarding the REACH Regulations, TE's information on SVHC in articles for this part number is still based on the European Chemical Agency (ECHA) 'Guidance on requirements for substances in articles'(Version: 2, April 2011), applying the 0.1% weight on weight concentration threshold at the finished product level. TE is aware of the European Court of Justice ruling of September 10th, 2015 also known as O5A (Once An Article Always An Article) stating that, in case of 'complex object', the threshold for a SVHC must be applied to both the product as a whole and simultaneously to each of the articles forming part of its composition. TE has evaluated this ruling based on the new ECHA "Guidance on requirements for substances in articles" (June 2017, version 4.0) and will be updating its statements accordingly.

Compatible Parts



Also in the Series | FASTON 250

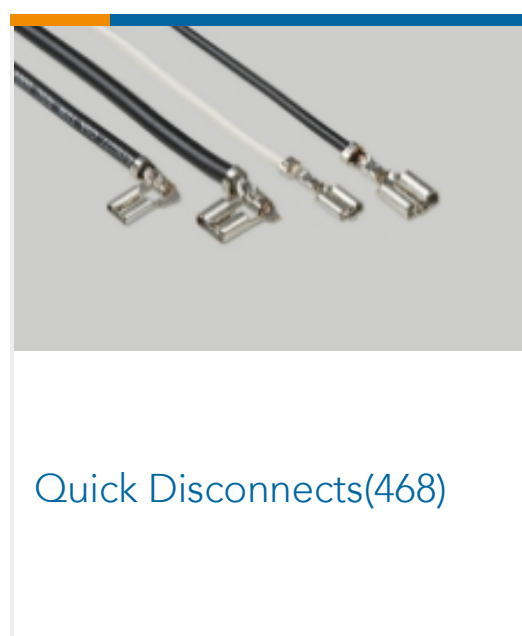

Customers Also Bought

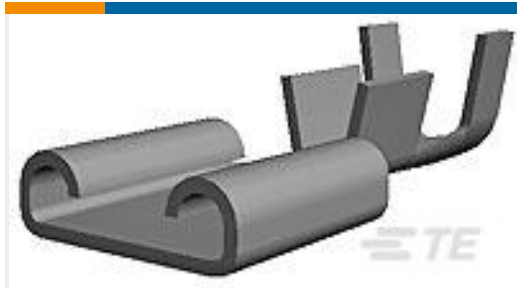

TE Part #170187-2
FASTON 250
RECEPTACLE 22-18 AWG
TPBR

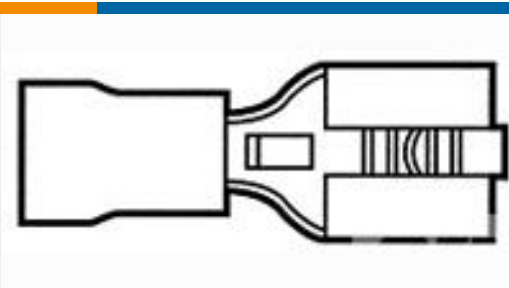

TE Part #170603-1
.130 PIDG FASTON

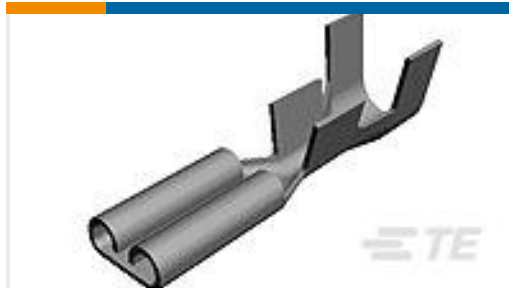

TE Part #170048-2
FASTON 110 20-24AWG
TPBR



TE Part #170121-1
MATE-N-LOK SKT L.P.



TE Part #2-179555-6
DYNAMIC D-3200 WTW
TAB HSG 12P



TE Part #1-171197-0
9 POS MATE-N-LOK S

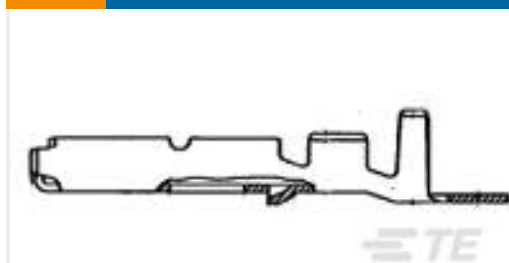

TE Part #172776-1
MIC MARK-2 REC
CONTACT L.P

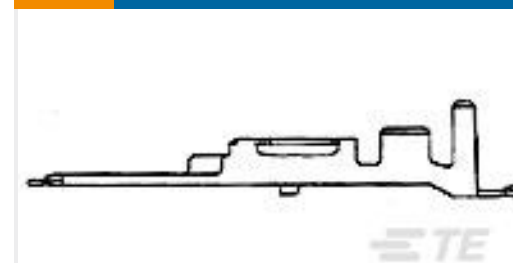

TE Part #172780-1
MIC MARK-2 TAB
CONTACT L.P



TE Part #2-178288-8
DYNAMIC 3100 REC HSG
10P



TE Part #170021-1
SHUR PLUG RECEPTACLE
20-16 AWG TPBR

Documents

Product Drawings

[.250 PIDG FASTON RECEIPT](#)

Japanese

CAD Files

Customer View Model

[ENG_CVM_CVM_170604-1_E.2d_dxf.zip](#)

English

3D PDF

3D

Customer View Model

[ENG_CVM_CVM_170604-1_E.3d_igs.zip](#)

English

Customer View Model

[ENG_CVM_CVM_170604-1_E.3d_stp.zip](#)

English

Product Specifications

[Product Specification](#)



English

[Agency Approvals](#)

[UL Report](#)

English