

REVISIONS					
P	LTR	DESCRIPTION	DATE	DWN	APVD
	C4	REVISED PER ECR-17-003845	18MAY2017	FV	TD

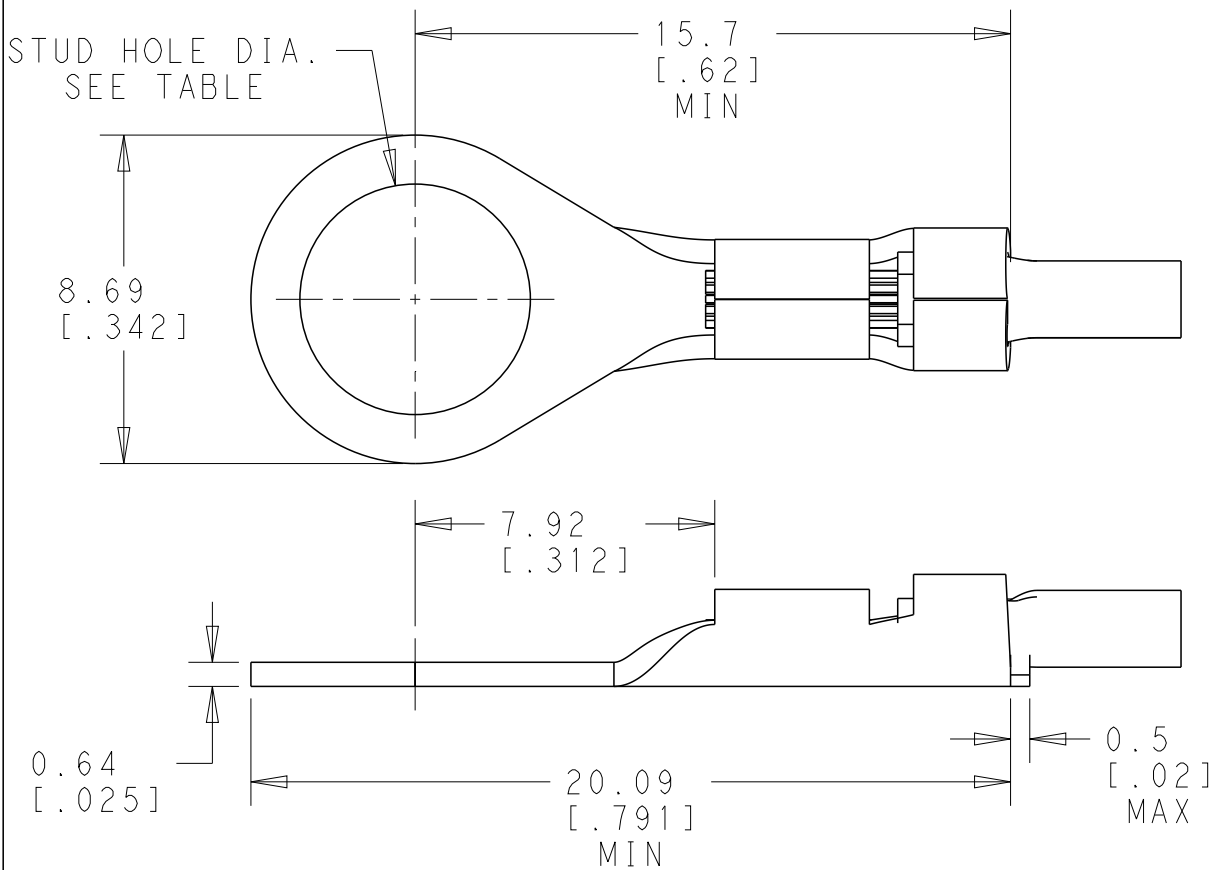

- 1 OBSOLETE PARTS: OBSOLETE CIS STREAMLINING PER D.RENAUD/D.SINISI
- 2 OBSOLETE
- 3 REELED WITH INTERLEAVING PAPER

* FOR USE ON AMP_O_MATOR

WIRE RANGE	INSL. RANGE
20-16 AWG 0.5-1.5mm ²	Ø.080-Ø.120 (2.0-3.0)

FOR STUD	STUD DIA	PLATING	MATERIAL	PART NO.
M4 #8	4.3 [.171]	-	PH. BR	2 +60101-3
			BRASS	2 +60102-4
M5 #10	5.2 [.207]	-	PH. BR	2 +60102-3
		TIN	BRASS	160102-2
		-		160102-1
M4 #8	4.3 [.171]	TIN		160101-2
		-		160101-1
		TIN		3 160341-3
		TIN		160341-2
M2.6 #4	3.0 [.119]	-		160341-1
		TIN		1 +60100-2
		-		2 +60100-1

20
 RELEASED FOR PUBLICATION
 ALL RIGHTS RESERVED.
 BY - TE CONNECTIVITY
 COPYRIGHT 20

DIMENSIONS: mm [INCHES]		DWN -	21MAR2017	MATERIAL -	FINISH -		
TOLERANCES UNLESS OTHERWISE SPECIFIED:		CHK -		TE Connectivity			
0 PLC ±-		APVD -					
1 PLC ±-		PRODUCT SPEC	-	NAME RING TONGUE WITH INS. SUPPORT			
2 PLC ±0.25 [.010]		APPLICATION SPEC	-	SIZE	CAGE CODE	DRAWING NO	RESTRICTED TO
3 PLC ±-				A4	-	C-160100	-
4 PLC ±-							
ANGLES ±1°		WEIGHT	-				
CUSTOMER DRAWING				SCALE	SHEET	OF	REV
				5:1	1	1	C4