



What can we help you find?



[Home](#) > [Products](#) > [Automotive](#) > [Product Feature Selector](#) > [Product Details](#)

# 1452671-2 Product Details

[Share](#) [Print](#) [Email](#)

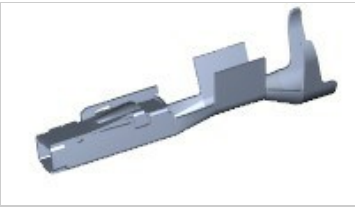

## Multiple Contact Point (MCP) & MCON Contact Systems

MCON 1.2 - LL (SWS)

**1452671-2**

TE Internal Number: 1452671-2

**Active**

[View 3D PDF](#)

### Product Highlights [View All](#)

- MCON Product Line, Multiple Contact Point (MCP) Product Line
- Wire-to-Wire
- Applies To Wire/Cable
- Contact
- Contact Type = Socket

[Pricing & Availability](#)

[Request Sample](#)

[Add to My Part List](#)

[Buy Product through Distributor](#)

[Documents](#) [Features](#) [Compliance](#)

Product Drawings	
<a href="#">MCON 1.2 LL (LOCKING-LANCE)</a> (PDF, English)	
<a href="#">AMP MCP1.2 LL- CONTACT AMP MCP1.2 LL- Kontakt</a> (PDF, German)	<a href="#">.tif available</a>
CAD Files	
<a href="#">2D Drawing</a> (DXF, Version B, ZIP)	
<a href="#">3D Model</a> (IGES, Version B, ZIP)	
<a href="#">3D Model</a> (STEP, Version B, ZIP)	
Product Specifications	
<b>Application Specification</b>	
<a href="#">Allgemeine Crimpspezifikation / GENERAL CRIMP SPEC.</a> (PDF, German)	
<a href="#">MCON 1.2 Contact</a> (PDF, German)	

**Related Products**

Not quite the product you're looking for?

[Find Similar Products](#)

[View Part in Product Feature Selector](#)

[View Mating Products \(5\)](#)

[View Terminals \(1\)](#)

[View Seals \(4\)](#)

[Check for Tooling](#)

### Corporate Information

- [About TE](#)
- [Investors](#)
- [News Room](#)
- [Supplier Portal](#)
- [Careers](#)
- [Terms & Conditions](#)
- [Privacy Policy](#)
- [Global Accessibility Statement](#)

### Quick Links

- [Distributor Inventory](#)
- [Product Cross Reference](#)
- [Documents & Drawings](#)
- [Product Compliance Support Center](#)
- [Site Map](#)

### Customer Support

- [Email or Chat With Us](#)
- [Find a Phone Number](#)
- [Knowledge Base](#)
- [Manage Your Account](#)

### Keep Me Informed

