



PIDG

TE Internal #: 141456-1

Crimp Wire Pins, Tabs & Ferrules, Shur-Plug Receptacle, 20 – 16 AWG Wire Size, .5 – 1.31 mm² Wire Size, 1022 – 2583 CMA Wire Size, Closed, PIDG

[View on TE.com >](#)

Terminals & Splices > Crimp Wire Pins, Tabs & Ferrules > PIDG SHUR PLUGS



Crimp Wire Pin, Tab & Ferrule Terminal Type: **Shur-Plug Receptacle**

Accepts Wire Insulation Diameter Range: **3.3 mm [.13 in]**

Wire Size: **1022 – 2583 CMA**

[All PIDG SHUR PLUGS \(7\)](#)

Features

Product Type Features

Sealable	No
Wire Insulation Support Retention Type	Insulation Support

Configuration Features

Compatible With Wire & Cable Type	Discrete Wire
-----------------------------------	---------------

Body Features

Sleeve Material	Copper
Insulation Sleeve Material	Nylon
Double Wire	No

Contact Features

Crimp Wire Pin, Tab & Ferrule Terminal Type	Shur-Plug Receptacle
Barrel Type	Closed
Terminal Plating Material	Tin
Pin Type	Crimp
Terminal Orientation	Straight



Termination Features

Bullet Terminal	Without
-----------------	---------

Mechanical Attachment

Wire Insulation Support	With
-------------------------	------

Dimensions

Accepts Wire Insulation Diameter Range	3.3 mm[.13 in]
Wire Size	1022 – 2583 CMA
Terminal Material Thickness	.79 mm[.031 in]
Overall Product Length	25 mm[.983 in]

Usage Conditions

Insulation Option	Fully Insulated
Operating Temperature Range	105 °C[221 °F]

Operation/Application

Heavy Duty	No
------------	----

Packaging Features

Packaging Quantity	1000
Packaging Method	Box

Other

Barrel Color	Red
--------------	-----

Product Compliance

[For compliance documentation, visit the product page on TE.com>](#)

EU RoHS Directive 2011/65/EU	Compliant
EU ELV Directive 2000/53/EC	Compliant
China RoHS 2 Directive MIIT Order No 32, 2016	No Restricted Materials Above Threshold
EU REACH Regulation (EC) No. 1907/2006	Current ECHA Candidate List: JAN 2022 (223) Candidate List Declared Against: JAN 2022 (223) Does not contain REACH SVHC
Halogen Content	Low Halogen - Br, Cl, F, I < 900 ppm per homogenous material. Also BFR/CFR/PVC Free
Solder Process Capability	Not applicable for solder process capability

Product Compliance Disclaimer

This information is provided based on reasonable inquiry of our suppliers and represents our current actual knowledge based on the information they provided. This information is subject to change. The part numbers that TE has identified as EU RoHS compliant have a maximum concentration of 0.1% by weight in homogenous materials for lead, hexavalent chromium, mercury, PBB, PBDE, DBP, BBP, DEHP, DIBP, and 0.01% for cadmium, or qualify for an exemption to these limits as defined in the Annexes of Directive 2011/65/EU (RoHS2). Finished electrical and electronic equipment products will be CE marked as required by Directive 2011/65/EU. Components may not be CE marked. Additionally, the part numbers that TE has identified as EU ELV compliant have a maximum concentration of 0.1% by weight in homogenous materials for lead, hexavalent chromium, and mercury, and 0.01% for cadmium, or qualify for an exemption to these limits as defined in the Annexes of Directive 2000/53/EC (ELV). Regarding the REACH Regulation, the information TE provides on SVHC in articles for this part number is based on the latest European Chemicals Agency (ECHA) 'Guidance on requirements for substances in articles' posted at this URL: <https://echa.europa.eu/guidance-documents/guidance-on-reach>

Compatible Parts



Also in the Series | PIDG

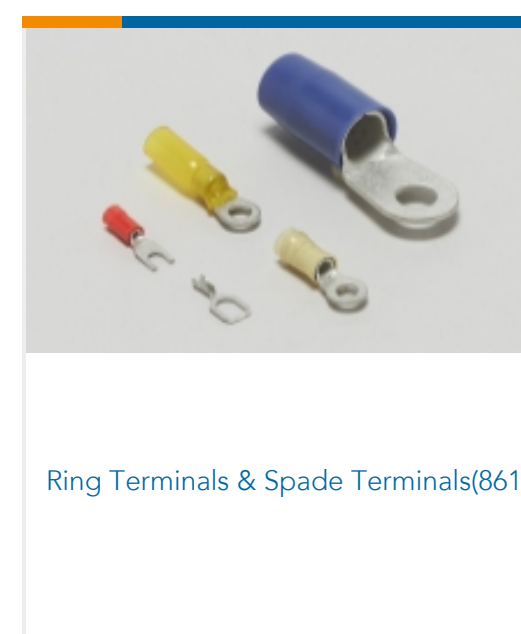
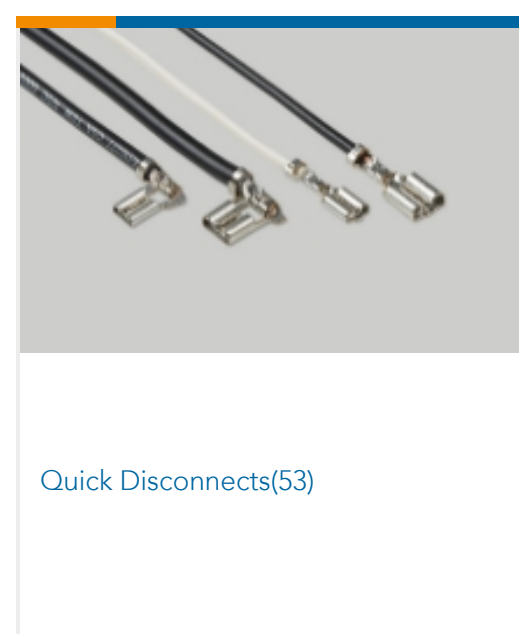
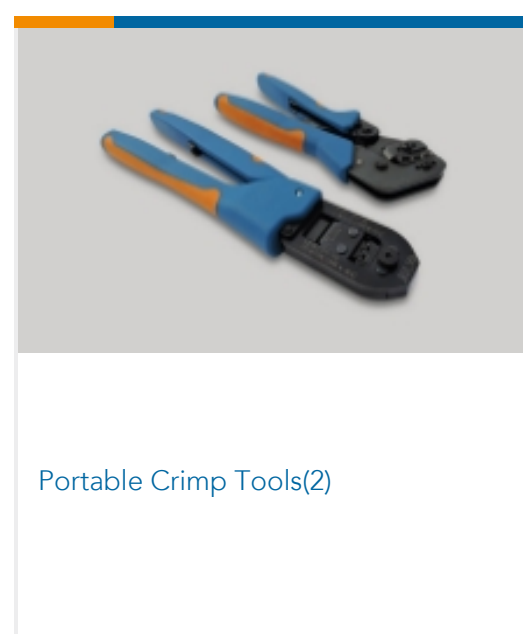
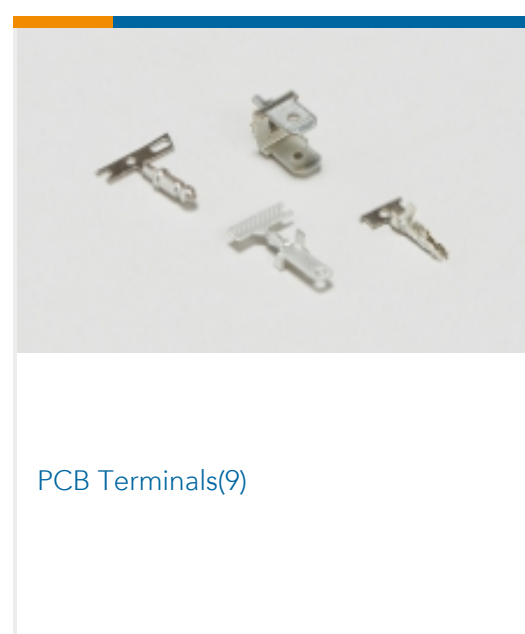
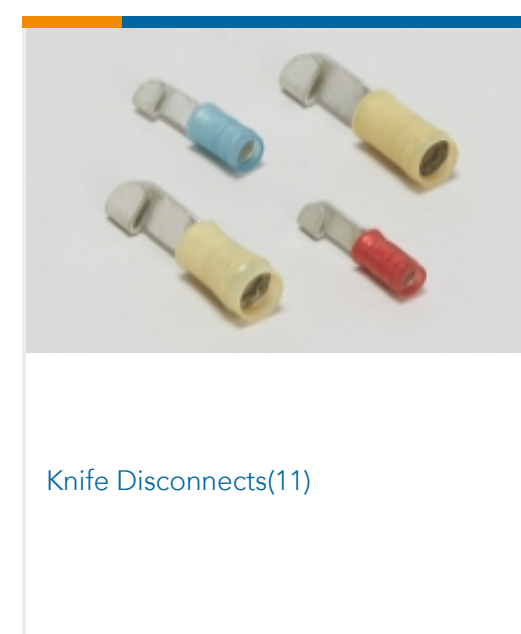
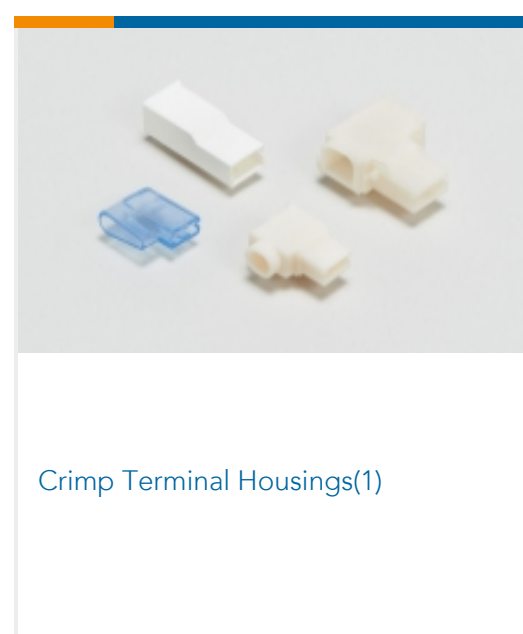
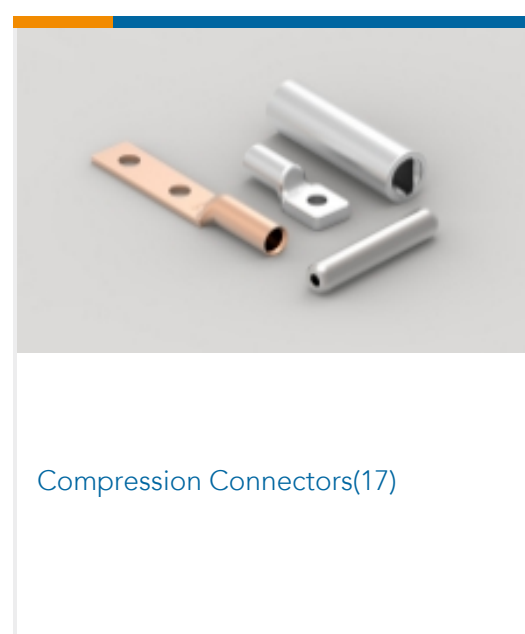



Special Purpose Terminals(1)



Splices(48)

Customers Also Bought



TE Part #554902-1
EMI RCPT ASSY,50 POSN,SHLD



TE Part #160018-2
RING TONGUE 176 20-16 AWG 0.251 NIBR



TE Part #63896-1
250 FASTON REC 16-12 AWG BR



TE Part #5069944006
CGPT-3.2/1.6-9-SP



TE Part #5052934055
RNF-100-1/16-9-SP

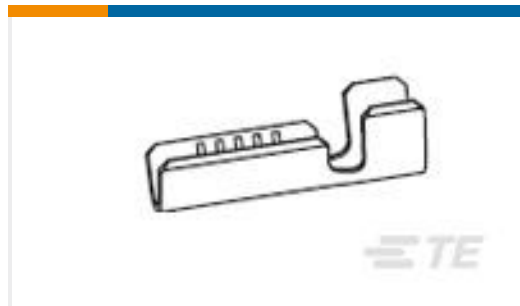

TE Part #160644-3
SPLICE 20-15 AWG .016 TPBR



TE Part #166633-1
IEC-F F.CONT.COSI

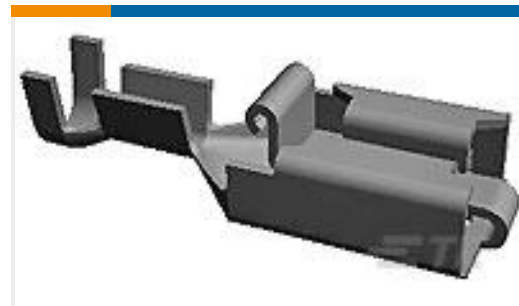

TE Part #160831-9
PL REC 1.0-2.5 MM2 NICKEL SILVER



TE Part #1-971111-9
6W FRC MADISON SPEC 100-4703 REV. 7

Documents

Product Drawings

SKT ASSY, SHUR,INS, 4 MM DIA, 22-16 AWG

English

CAD Files

Customer View Model

ENG_CVM_CVM_141456-1_C.2d_dxf.zip

English

3D PDF



3D

Customer View Model

[ENG_CVM_CVM_141456-1_C.3d_igs.zip](#)

English

Customer View Model

[ENG_CVM_CVM_141456-1_C.3d_stp.zip](#)

English

By downloading the CAD file I accept and agree to the [Terms and Conditions](#) of use.

Datasheets & Catalog Pages

[PIDG TERMINALS & SPLICES Quick Reference Guide](#)

English