

2.0mm (0.079") Female Header SMD Bottom Entry Dual Row Board to Board Contacts

1318 Series

APPLICATION AND FEATURES

1. Low profile: 2.5mm height.
2. High quality dual beam phosphor bronze contacts.
3. Designed for board to board small spacing interconnection.
4. Mating with 2.0mm pitch \square 0.5mm Pin Headers such as 1202,1204D,1205 & 1302 series.

SPECIFICATIONS

Current Rating: 1 Amp
 Insulator resistance: 5000 Megohms min.
 Contact resistance: 20 m ohm Max.
 Dielectric withstanding: AC 500 V
 Operating Temperature: -40° to $+105^{\circ}$ C
 Max Processing Temp: 230° for 30~60 seconds
 (260° for 10 seconds)
 Contact Material: Phosphor bronze
 Insulator Material: Polyester, UL 94V-0
 ©Standard: Nylon-6T

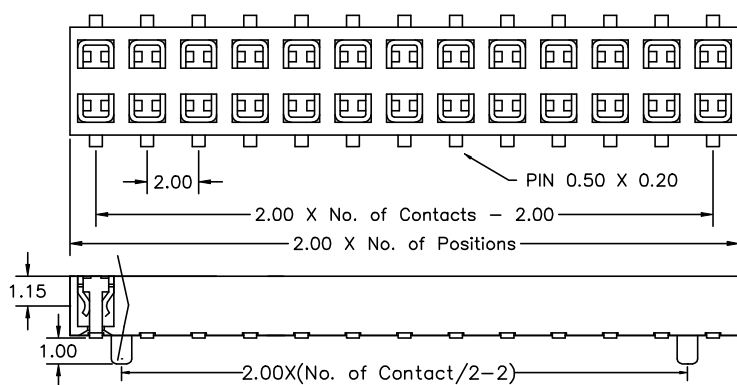
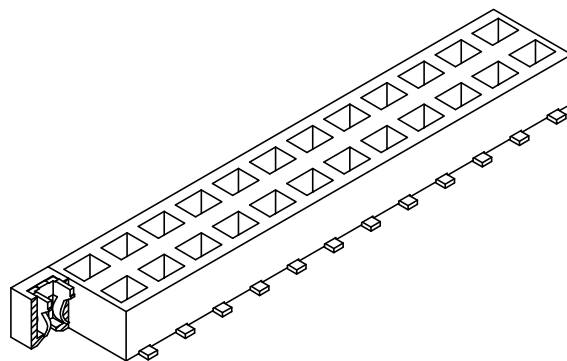

Recommended P.C.Board
SMT Layout

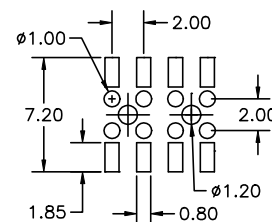
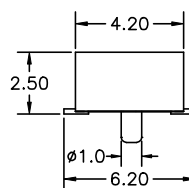

Order Information 1318 Series

Example: 1318 - 20 - 02 - 1

Series No.	Number of Contacts	Contact Plating	Locating Peg
1318	10 to 60 Contacts	Tin Plated 01	W/O Locating peg 0
		Gold Plated	W Locating peg 1
		Flash 02	
		10 μ " 10	
		30 μ " 30	