

Unimate Range - SLA/BLA

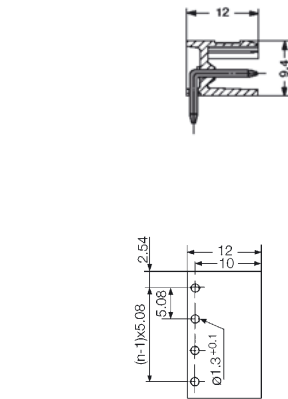

Pin headers SLA 90

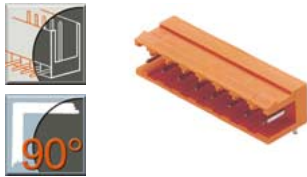

Technical Data		VDE	UL	CSA
Rated voltage	V	250*	300	300
Rated current	A	10	10	10

*Overvoltage category III / Pollution severity 3
Additional technical data see page 227

Pin headers SLA 90B

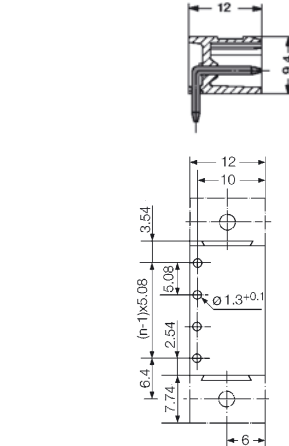
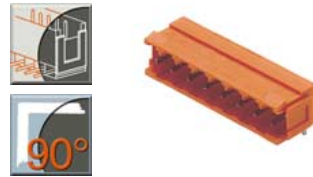

Technical Data		VDE	UL	CSA
Rated voltage	V	250*	300	300
Rated current	A	10	10	10

*Overvoltage category III / Pollution severity 3
Additional technical data see page 227

Pin headers SLA 180

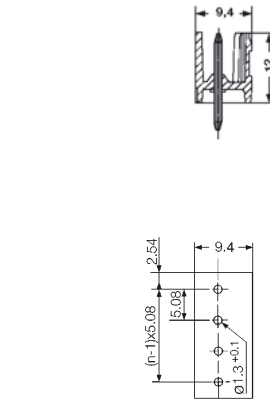

Technical Data		VDE	UL	CSA
Rated voltage	V	250*	300	300
Rated current	A	10	10	10

*Overvoltage category III / Pollution severity 3
Additional technical data see page 227

Solder pin length		3.2 mm	4.5 mm		
Colour		●	●		
Poles	Type	Cat. No.	Cat. No.	Qty.	
2	SLA 2/90	1238060000	1346810000	100	
3	SLA 3/90	1238160000	1346910000	100	
4	SLA 4/90	1238260000	1347010000	100	
5	SLA 5/90	1238360000	1347110000	50	
6	SLA 6/90	1238460000	1347210000	50	
7	SLA 7/90	1238560000	1347310000	50	
8	SLA 8/90	1238660000	1347410000	50	
9	SLA 9/90	1238760000	1347510000	50	
10	SLA 10/90	1238860000	1347610000	50	
11	SLA 11/90	1238960000	1347710000	50	
12	SLA 12/90	1239060000	1347810000	50	
13	SLA 13/90	1239160000	1347910000	50	
14	SLA 14/90	1239260000	1348010000	50	
15	SLA 15/90	1239360000	1348110000	50	
16	SLA 16/90	1239460000	1348210000	50	
17	SLA 17/90	1271760000	1348310000	20	
18	SLA 18/90	1271860000	1348410000	20	
19	SLA 19/90	1271960000	1348510000	20	
20	SLA 20/90	1272060000	1348610000	20	
21	SLA 21/90	1272160000	1348710000	20	
22	SLA 22/90	1315960000	1348810000	20	
23	SLA 23/90	1316060000	1348910000	20	
24	SLA 24/90	1316160000	1349010000	20	

Accessories	Page
Fixing	-
Marking	196
Coding	199
Miscellaneous	205

Solder pin length		3.2 mm	4.5 mm		
Colour		●	●		
Poles	Type	Cat. No.	Cat. No.	Qty.	
2	SLA 2/90B	1241060000	1351410000	100	
3	SLA 3/90B	1241160000	1351510000	100	
4	SLA 4/90B	1241260000	1351610000	100	
5	SLA 5/90B	1241360000	1351710000	50	
6	SLA 6/90B	1241460000	1351810000	50	
7	SLA 7/90B	1241560000	1351910000	50	
8	SLA 8/90B	1241660000	1352010000	50	
9	SLA 9/90B	1241760000	1352110000	50	
10	SLA 10/90B	1241860000	1352210000	50	
11	SLA 11/90B	1241960000	1352310000	50	
12	SLA 12/90B	1242060000	1352410000	50	
13	SLA 13/90B	1242160000	1352510000	50	
14	SLA 14/90B	1242260000	1352610000	50	
15	SLA 15/90B	1242360000	1352710000	50	
16	SLA 16/90B	1242460000	1352810000	50	
17	SLA 17/90B	1270260000	1352910000	20	
18	SLA 18/90B	1270360000	1353010000	20	
19	SLA 19/90B	1270460000	1353110000	20	
20	SLA 20/90B	1270560000	1353210000	20	
21	SLA 21/90B	1270660000	1353310000	20	
22	SLA 22/90B	1315660000	1353410000	20	
23	SLA 23/90B	1315760000	1353510000	20	
24	SLA 24/90B	1315860000	1353610000	20	

Accessories	Page
Fixing	193
Marking	196
Coding	199
Miscellaneous	205

Solder pin length		3.2 mm	4.5 mm		
Colour		●	●		
Poles	Type	Cat. No.	Cat. No.	Qty.	
2	SLA 2/180	1239560000	1349110000	100	
3	SLA 3/180	1239660000	1349210000	100	
4	SLA 4/180	1239760000	1349310000	100	
5	SLA 5/180	1239860000	1349410000	50	
6	SLA 6/180	1239960000	1349510000	50	
7	SLA 7/180	1240060000	1349610000	50	
8	SLA 8/180	1240160000	1349710000	50	
9	SLA 9/180	1240260000	1349810000	50	
10	SLA 10/180	1240360000	1349910000	50	
11	SLA 11/180	1240460000	1350010000	50	
12	SLA 12/180	1240560000	1350110000	50	
13	SLA 13/180	1240660000	1350210000	50	
14	SLA 14/180	1240760000	1350310000	50	
15	SLA 15/180	1240860000	1350410000	50	
16	SLA 16/180	1240960000	1350510000	50	
17	SLA 17/180	1271260000	1350610000	20	
18	SLA 18/180	1271360000	1350710000	20	
19	SLA 19/180	1271460000	1350810000	20	
20	SLA 20/180	1271560000	1350910000	20	
21	SLA 21/180	1271660000	1351010000	20	
22	SLA 22/180	1315060000	1351110000	20	
23	SLA 23/180	1315160000	1351210000	20	
24	SLA 24/180	1315260000	1351310000	20	

Accessories	Page
Fixing	-
Marking	196
Coding	199
Miscellaneous	-