

THIS DRAWING AND DESIGN HEREON CONSTITUTES A PROPRIETARY DESIGN OF PACKARD ELECTRIC DIVISION AND IS NOT TO BE DUPLICATED OR REPRODUCED EXCEPT TO PRODUCE GOODS AND SERVICES TO GENERAL MOTORS CORP.
DO NOT SCALE

PART NO
1204 8451

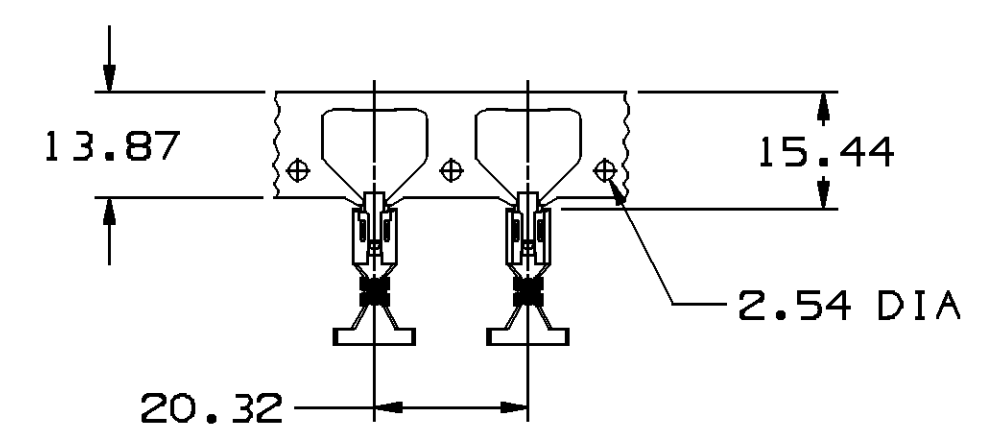

CARRIER STRIP VIEW
SCALE 2:1

DATE	SYM	REVISION RECORD	AUTH	DR	CK
17AP93	-	REDRAWN & REVISED			
		REV LEVEL REMAINS			
		AT "G"	154495	DE	DE
30JA93	H	REV LEVEL ADVANCED	154898	RLB	BKD
14FE96	-	20.0+0.3/-0.6 DIM			
		WAS 20.0	168490	HH	HH
16MR96	-	REVISED	164943	JVS	JVS
01AU06	H3	MAT'L SPEC WAS 425 TIN			
		BRS EX HD SN PLTD	283052	MDH	JAA

PART NO
1204 8451

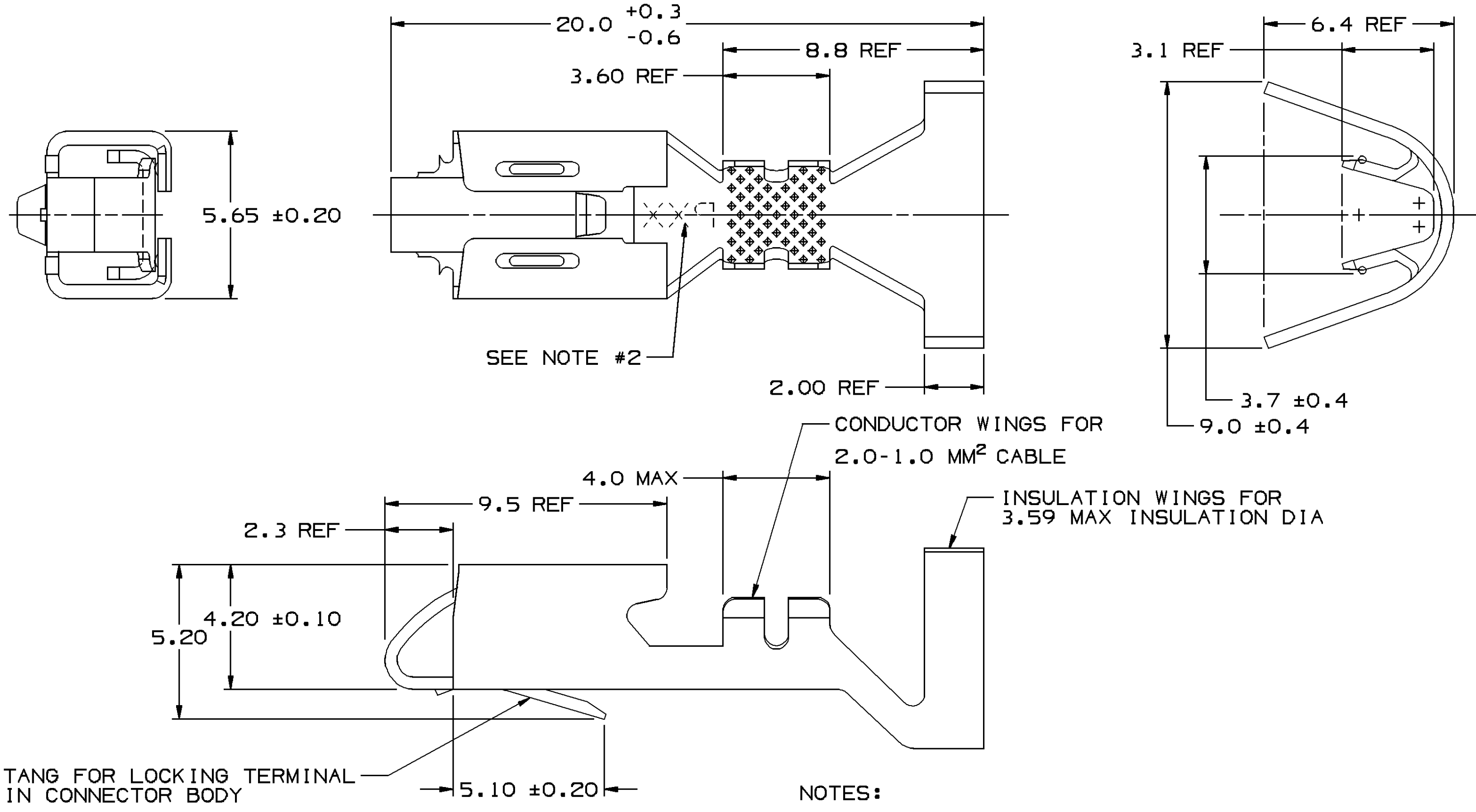

- NOTES:
1. RECOMMENDED MATING BLADE 0.81 X 4.80 WIDE.
 2. "PXX" INDICATES "P" PLUS LAST TWO DIGITS OF MAKE DIE SERIES NUMBER (P01, P02, P03, ETC).
 3. TERMINALS TO HAVE TERMINAL ENGAGE OF 8N TO 28N WHEN MATED TO A 4.80 X 0.81 HARDENED STEEL BLADE.
 4. REF GAGE #G-6904
 5. DIMENSIONS MARKED "REF" ARE FOR REFERENCE ONLY AND NO TOLERANCE LIMITS ARE ESTABLISHED.
 6. UNLESS OTHERWISE SPECIFIED AND/OR INDICATED: DIMENSIONS ARE TO FACE OF VIEW SHOWN AND AUTOMATICALLY ROUNDED BY COMPUTER FOR INSPECTION.

PACKARD ELECTRIC DIVISION
GENERAL MOTORS CORPORATION
WARREN, OHIO

		METRIC DIMENSIONS ARE IN MILLIMETERS UNLESS OTHERWISE SPECIFIED	
THIRD ANGLE PROJECTION 		TOLERANCE UNLESS OTHERWISE SPECIFIED DECIMAL: ANGULAR ± 2° ONE PLACE ± 0.3 TWO PLACE ± 0.15	
CODE NO	QC	DES	
6900			
DWG DATE	17JL84	DR	
SCALE	NONE	CK A. LAZORCHAK 26JL84	
REFERENCE NO	SHT #01	APPR J. DAUGHERTY 28AUB4	
	12088010 "R5" SIZE	VOL CM³	
MATERIAL SPEC			
M1574028 NONFERROUS C42500 EX HD			
NAME			
TERM F M/P 480			
PART NUMBER		SIZE	
1204 8451		A2	
PRODUCT INFORMATION DWG			