

Aptiv Connection Systems Catalog

Customer Service Samples Request

Find by Feature Browse by Category Browse by Application

Comparison List (0) Share

12084689

Enter part number or keyword

Search Results (1) Search Options

- 1 Result(s): [All] - 12084689
- Compare
 - 12084689 - Clip Splice Unsealed Tin Plating Terminal, Cable Range 3.00 - 5.00 mm2
 - Compare

« 1 2 »

Clip Splice Unsealed Tin Plating Terminal, Cable Range 3.00 - 5.00 mm2

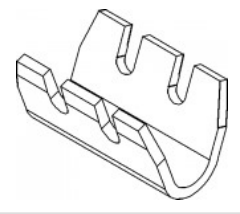

Part # 12084689

[Question about this product?](#)

Attributes	Documents (2)
Part # :	12084689
Description :	Clip Splice Unsealed Tin Plating Terminal, Cable Range 3.00 - 5.00 mm2
Product Type :	Terminal
Status :	✔ Active
Terminal Family :	SPLICE
Series :	CLIP
Sealable :	Unsealed
Material :	CuSn3Zn9
Weight [g] :	0
Plating :	Tin
Minimum Cable Core Cross Section [mm2] :	3.00
Maximum Cable Core Cross Section [mm2] :	5.00
RoHs compliant :	✔ Yes
ELV compliant :	✔ Yes

Certain products listed on this website may be subject to restricted usage or distribution or may not be available. For additional information, please contact your local sales office.