

THIS DRAWING AND DESIGN HEREON CONSTITUTE A PROPRIETARY DESIGN OF PACKARD ELECTRIC DIVISION AND IS NOT TO BE DUPLICATED OR REPRODUCED WITHOUT AUTHORITY OF PACKARD ELECTRIC DIVISION
DO NOT SCALE

DATE	SYM	REVISION RECORD	AUTH	DR	CK
01JL92	C	REDRAWN & REDESIGNED	148267	JC	JC
08JL92	C1	22.60 WAS 22.50	150068	JC	JC
25JA93	D	REVISED CONNECTOR ASM	153752	JK	JS

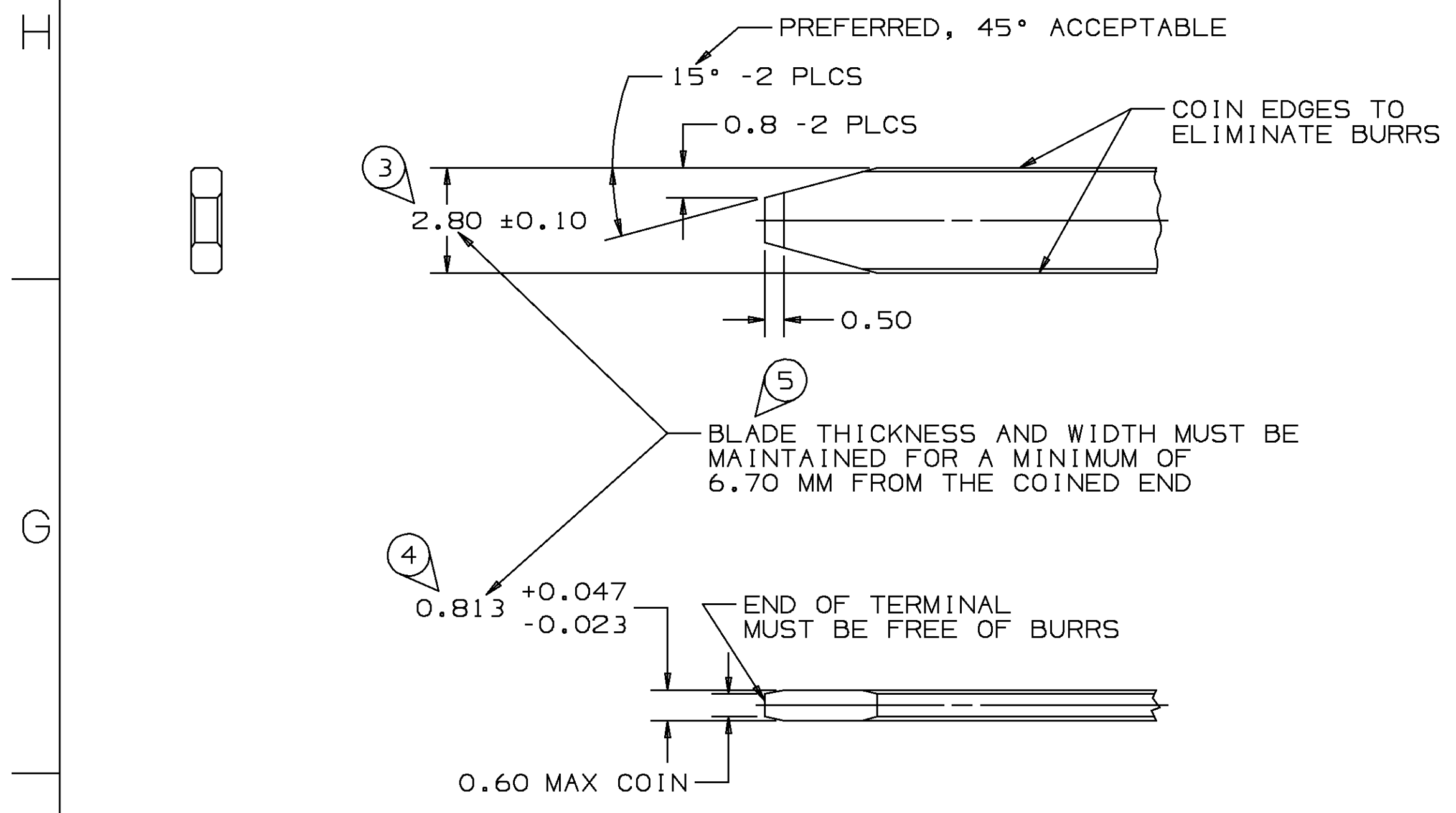

MATERIAL SPECIFICATIONS

RECOMMENDED
 BASE METAL - CDA-210, GILDING, EXTRA SPRING TEMPER
 PLATING - 0.0050±0.0025 MM THICK TIN

MINIMUMS
 ELECTRICAL CONDUCTIVITY - ≥20% IACS AT 20°C. USE OF A MATERIAL WITH CONDUCTIVITY < 20% IACS MUST BE APPROVED BY PACKARD ELECTRIC MATERIALS ENGINEERING.
 TENSILE STRENGTH - 407 MPa
 PLATING - FOR LOW ENERGY (≤5V) AND NON-PASSENGER COMPARTMENT POWER CIRCUITS, 0.0050±0.0025 MM THICK TIN. FOR MATERIALS CONTAINING 10% OR MORE ZINC, AN UNDERPLATE OF COPPER 0.0050±0.0025 MM THICK IS REQUIRED.

MATING BLADE INFORMATION
 SCALE 8:1

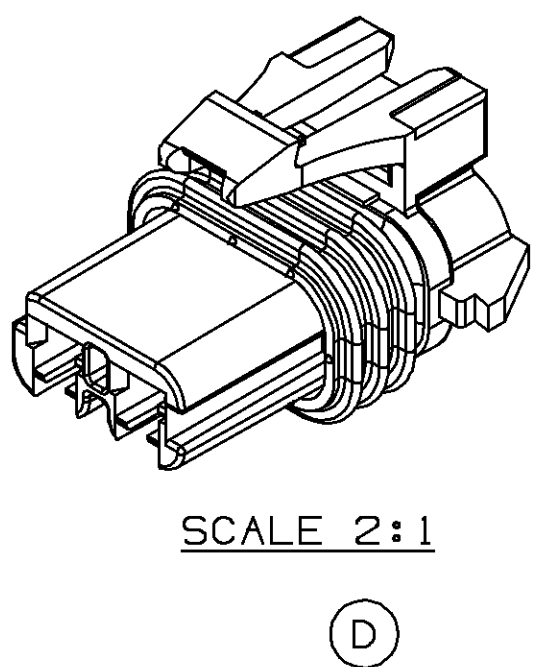
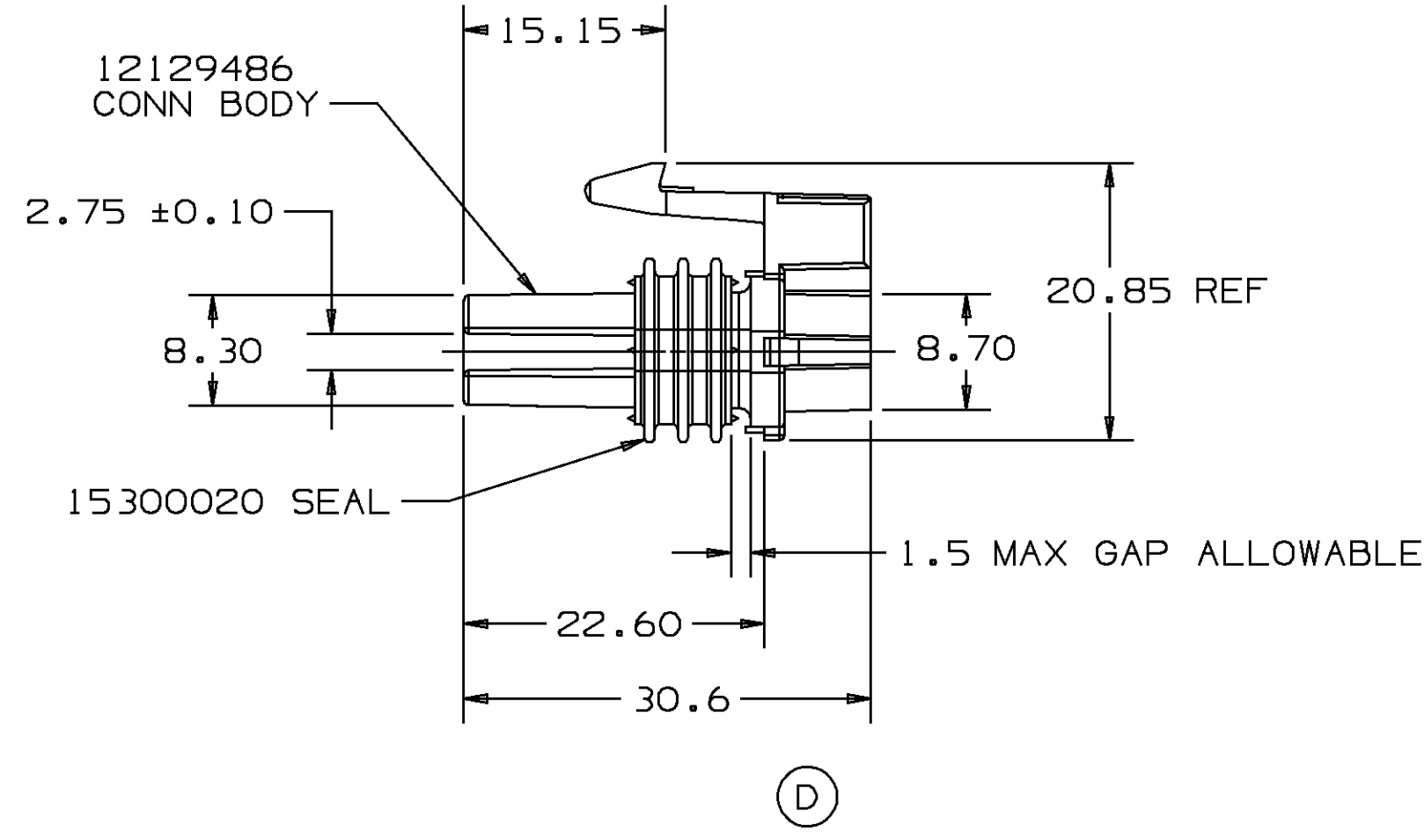
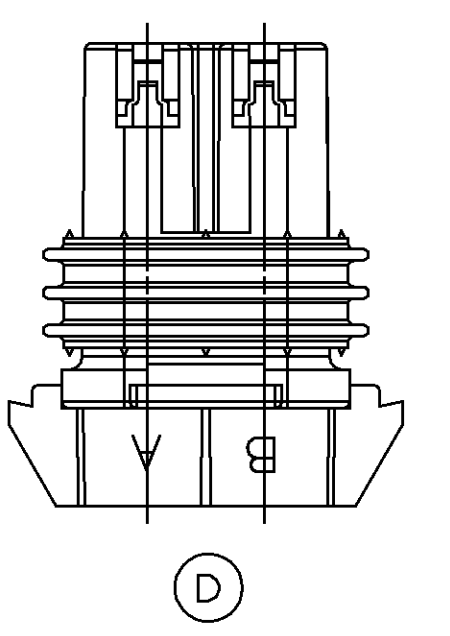
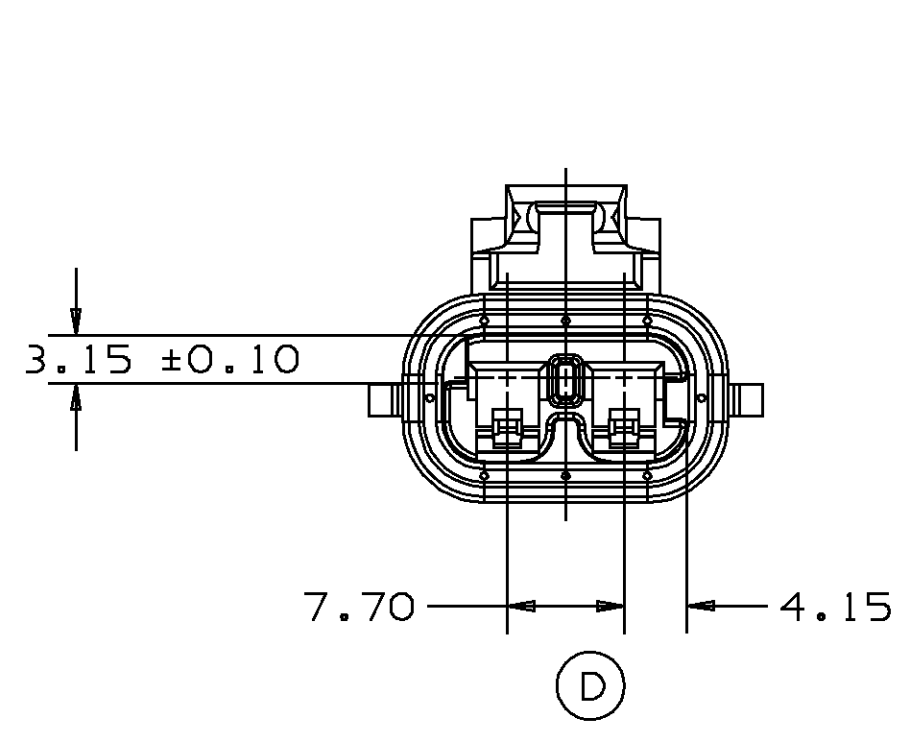
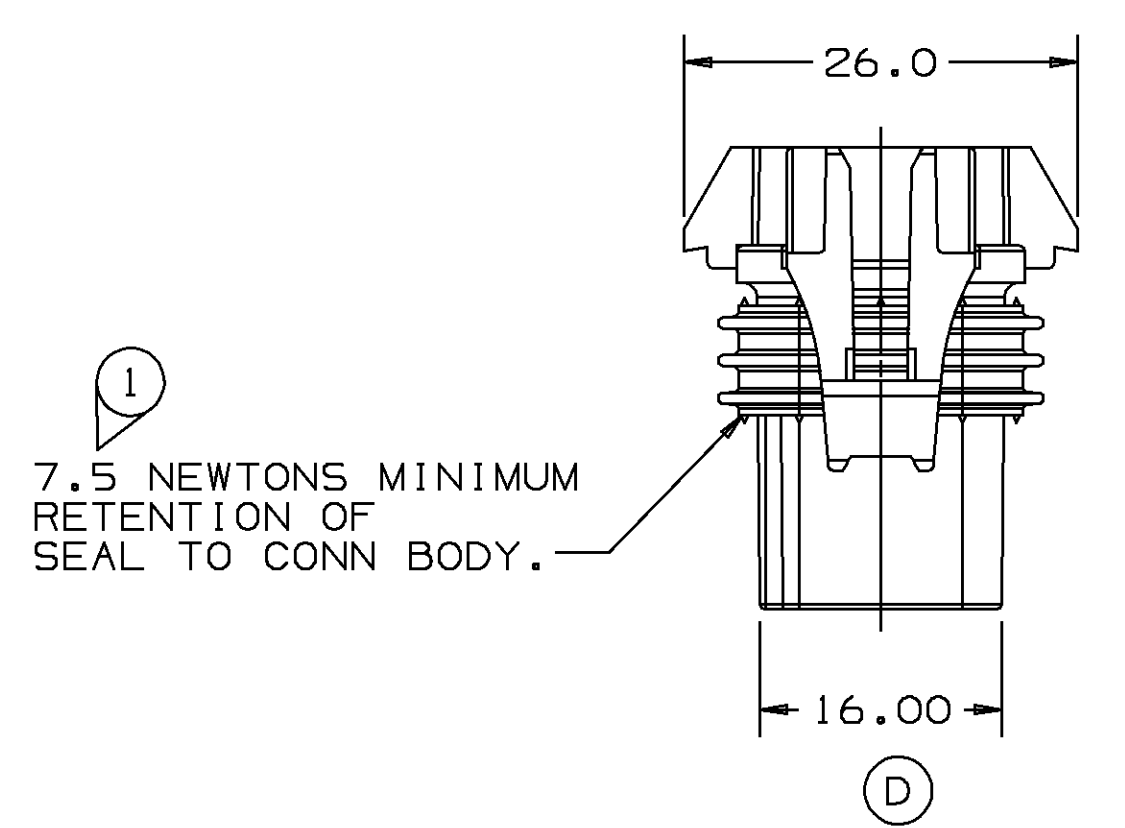

SCALE 2:1

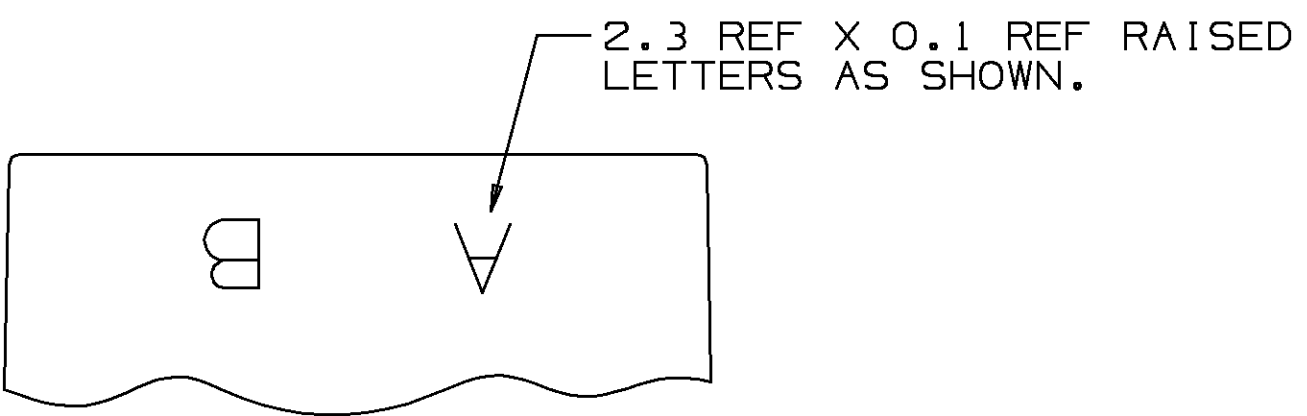
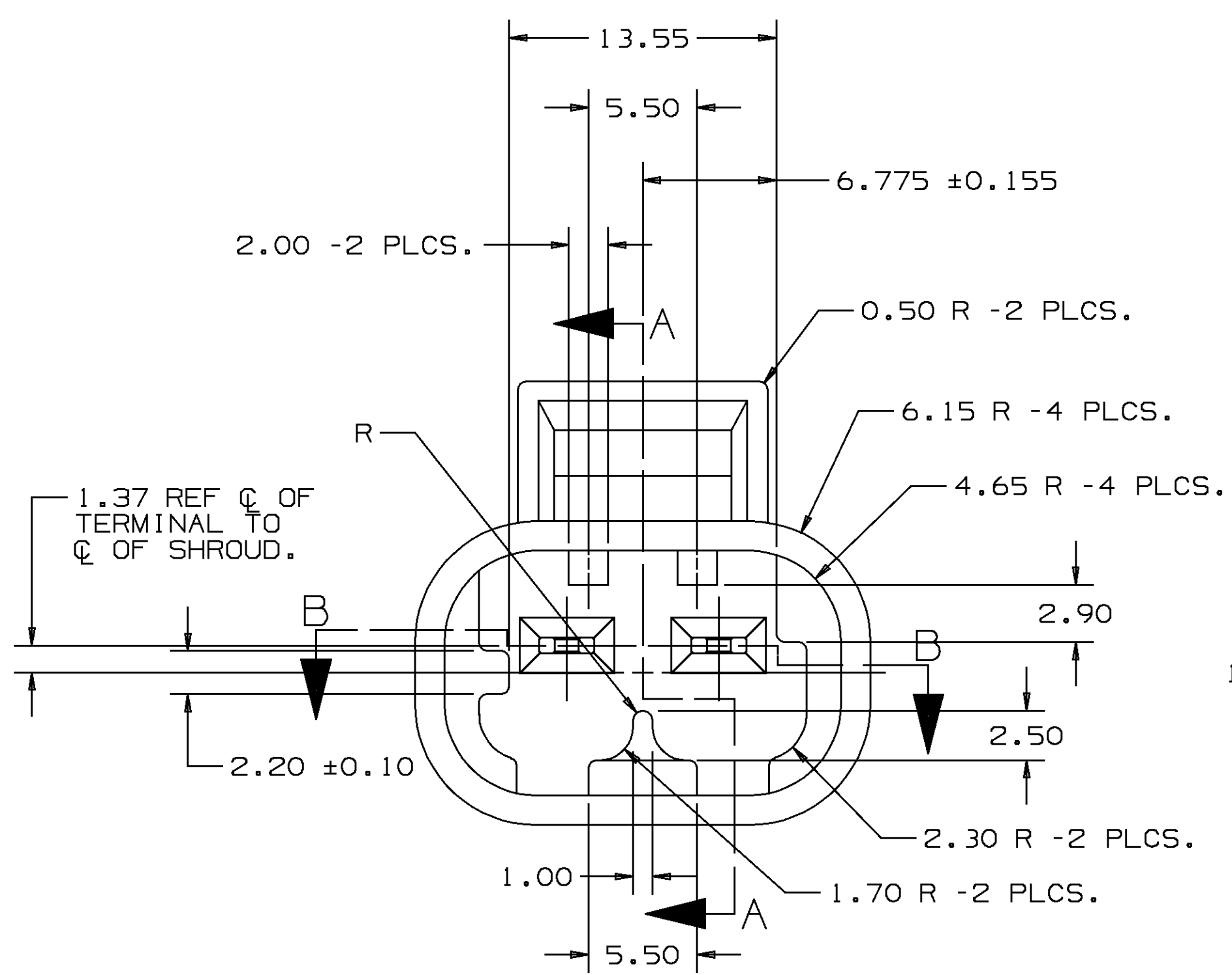
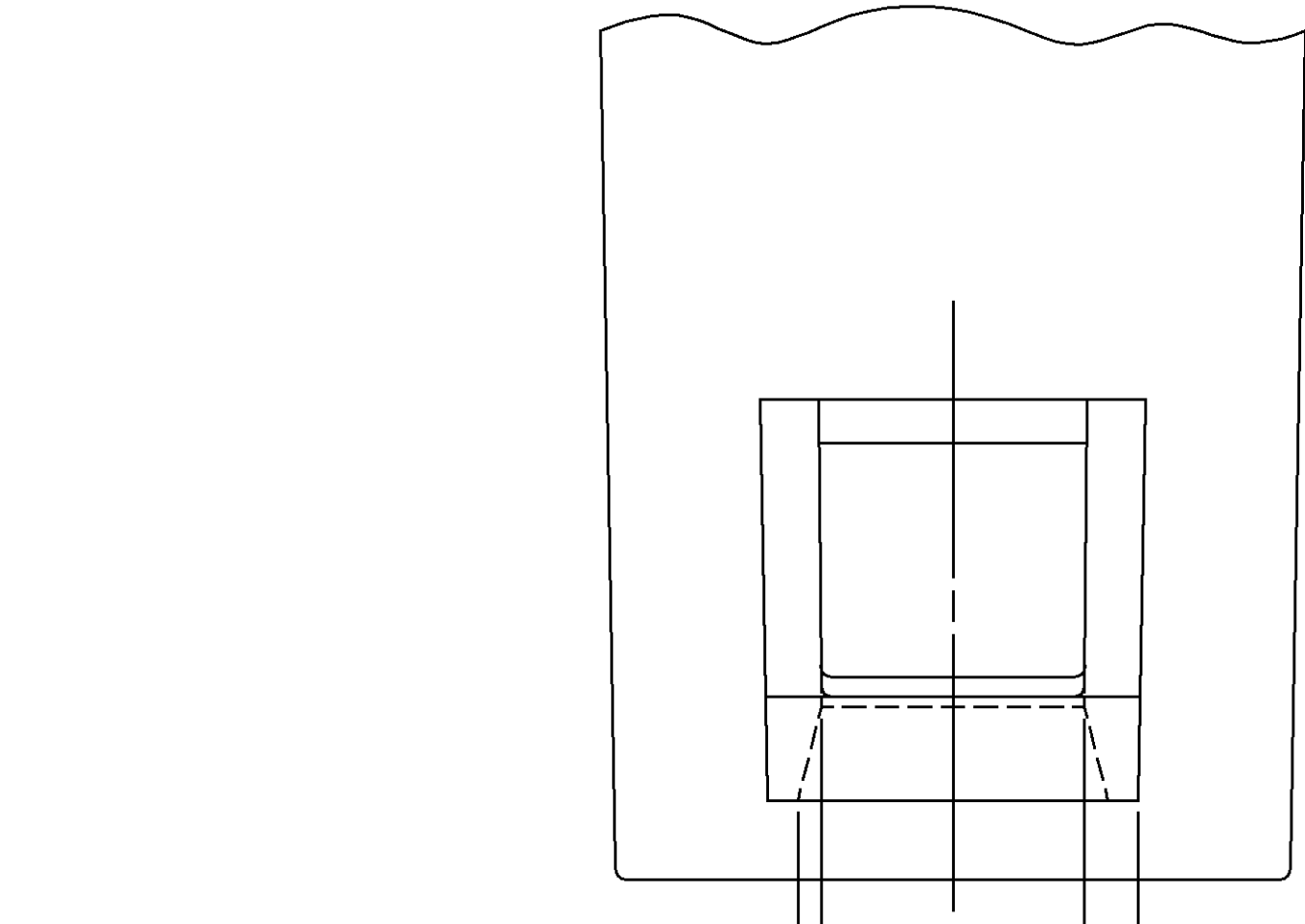

MATING INSERT MOLDED/"PANEL" CONNECTOR INFORMATION
 SCALE 4:1

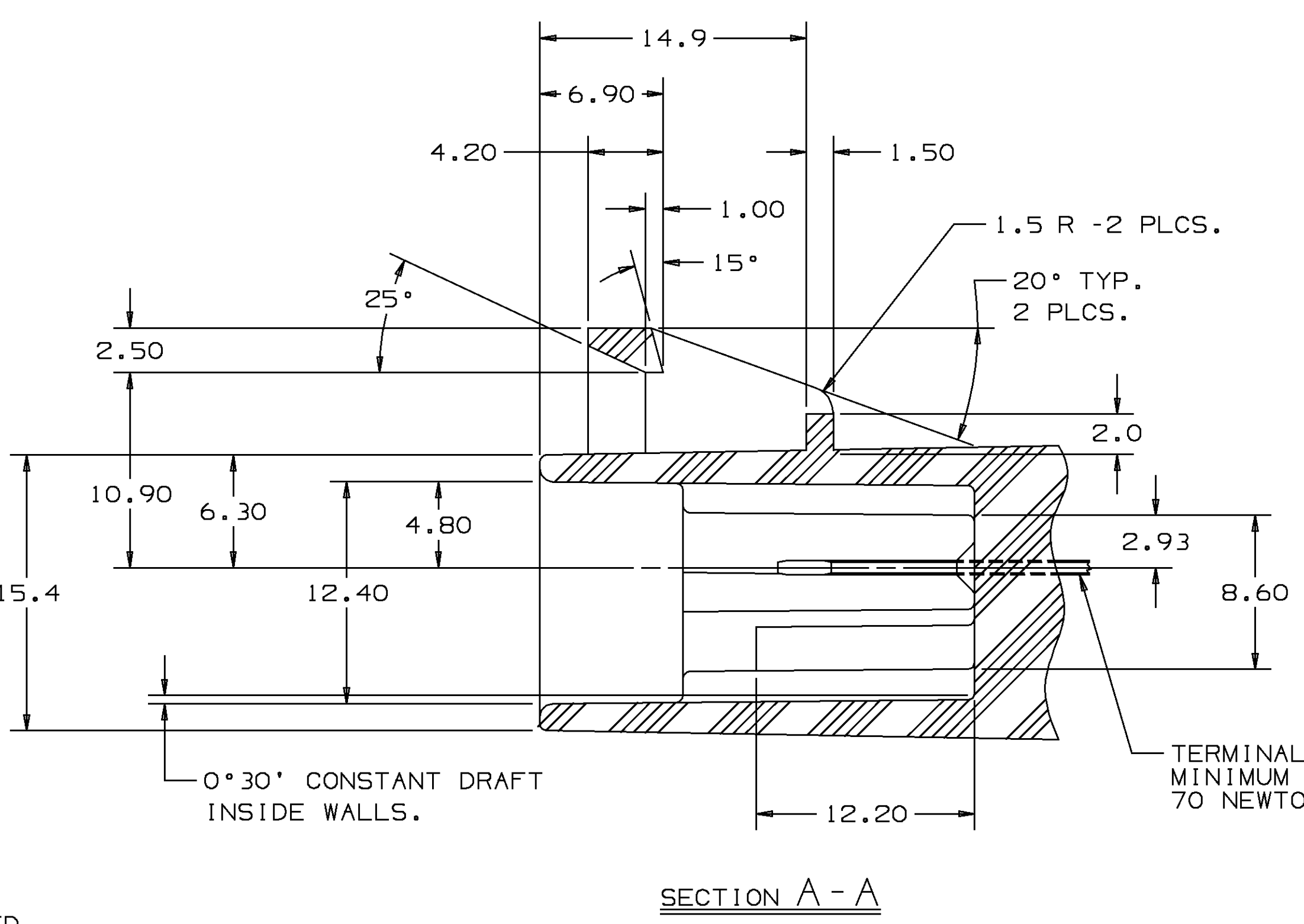
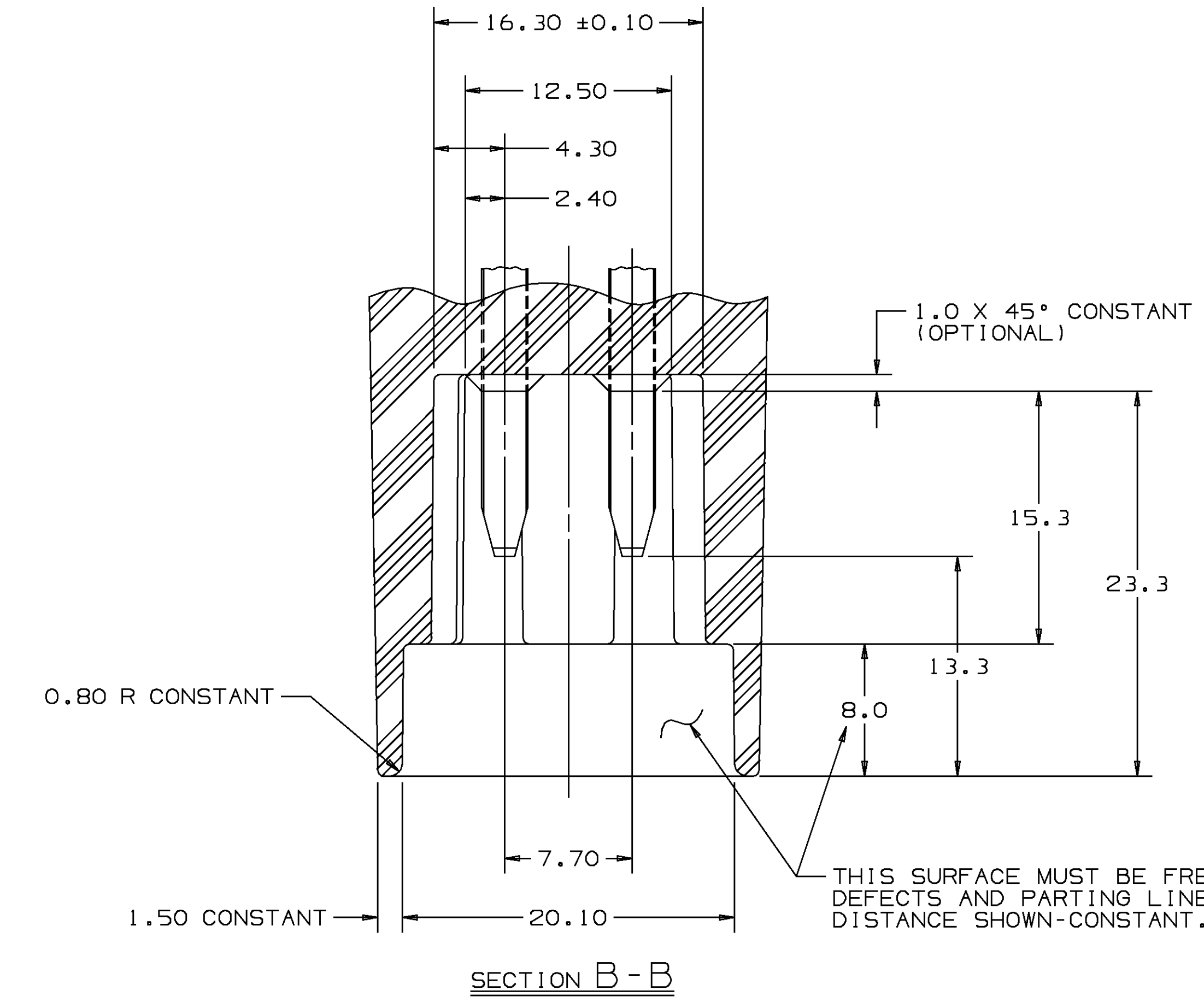

- NOTES**
1. ALL RADII 0.40, UNLESS OTHERWISE SPECIFIED.
 2. DIMENSIONS ARE TO FACE OF VIEW SHOWN, UNLESS OTHERWISE INDICATED.
 3. RECOMMENDED MATERIAL - GLASS FILLED POLYESTER OR NYLON 66.
 4. 1° DRAFT ON EXTERIOR SURFACES, UNLESS OTHERWISE INDICATED.
 5. USE TAXI 12084172 FOR INLINE CONNECTOR INFORMATION.

- NOTES**
1. CAVITIES TO ACCEPT 12110847 TERMINAL OR EQUIVALENT.
 2. CAVITIES TO ACCEPT 12015323 CABLE SEAL OR EQUIVALENT.
 3. WHEN PARTS ARE SHIPPED, THEY MUST BE PACKED IN PLASTIC BAGS OR SHIPPING CONTAINERS MUST BE LINED WITH PLASTIC LINERS. BAGS OR LINERS MUST BE SEALED TO AVOID ENTRY OF FOREIGN MATTER.
 4. THIS PART TO ACCEPT CPA LOCK 12052834 OR EQUIVALENT.
 5. THIS PART TO ACCEPT TPA 12077904 OR EQUIVALENT.
 6. ENVIRONMENTAL SEAL CLASS CODE 3.
 7. "O" DENOTES DIMENSIONS AND CHARACTERISTICS THAT ARE IMPORTANT TO THE FUNCTION AND/OR PROCESSING OF THE PART. IT DOES NOT NECESSARILY INDICATE AN SPC DIMENSION. THIS DRAWING HAS 5 SNOWCONES.
 8. MATING CONNECTOR - WINDOW LIFT MOTOR OR EQUIVALENT.

PART NO
1212 9487

PART NO
1212 9487

Utgaphis II		METRIC	
THIRD ANGLE PROJECTION			
CODE NO	QC	DIMENSIONS ARE IN MILLIMETERS UNLESS OTHERWISE SPECIFIED	
6900	C-5110	ONE PLACE ± 0.3	TWO PLACE ± 0.15
DWG DATE	16MY89	DR. J. COLDSNOW	19JL89
SCALE	2:1	CK. J. COLDSNOW	19JL89
REFERENCE NO		APPR. J. M. DRAPCHO	01NO91
		APPR. T. E. GENT	01NO91
MATERIAL SPEC SEE DRAWING			
NAME ASM CONN 2F M/P 280 FL			
PART NUMBER 1212 9487			
			SIZE AO