

# SNAP-ON CONTACTS



- Economical and reliable contacts are ideal for molded cases with self contained battery compartments
- Solder "ear" to facilitate soldering of wire lead
- Unique spring tension contact adjusts to variations in battery length
- Reliable spring tension contacts assure low contact resistance
- Clips easily onto .060 (1.52) to .070 (1.78) wall
- Sharp barbs securely anchor contact in place

Refer to page 34 for Battery Contact Layout & Mounting Details

## "AAA" • "AAAA" • "N" • "12V"



CAT. NO. 204

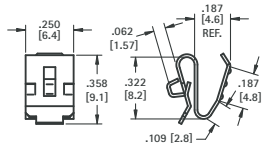

MATERIAL: .010 (.25) Spring Steel, Nickel Plate



CAT. NO. 238

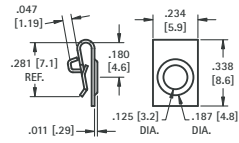

MATERIAL: .010 (.25) Spring Steel, Nickel Plate



CAT. NO. 202

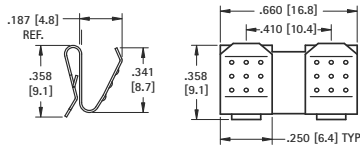

MATERIAL: .010 (.25) Spring Steel, Nickel Plate



CAT. NO. 294

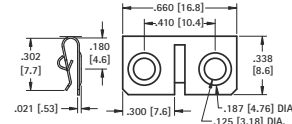

MATERIAL: .010 (.25) Spring Steel, Nickel Plate



CAT. NO. 295

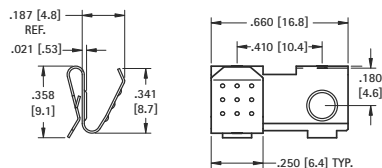

MATERIAL: .010 (.25) Spring Steel, Nickel Plate



CAT. NO. 296

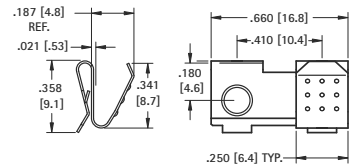

MATERIAL: .010 (.25) Spring Steel, Nickel Plate

## "AA" • "CR2" • "A"



CAT. NO. 209

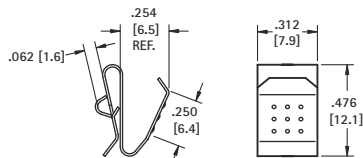

MATERIAL: 012 (.30) Spring Steel, Nickel Plate



CAT. NO. 228

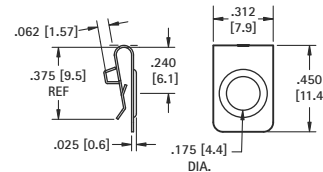

MATERIAL: 010 (.25) Spring Steel, Nickel Plate

## "AA"



CAT. NO. 288

- The (2) two leaf contacts are separate, allowing a divider between the batteries.

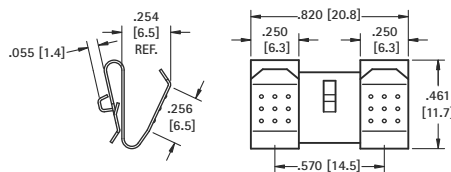

MATERIAL: 012 (.30) Spring Steel, Nickel Plate



CAT. NO. 292

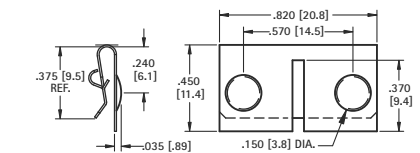

MATERIAL: 010 (.25) Spring Steel, Nickel Plate



CAT. NO. 210

- The (2) two leaf contacts are held together by a web. This design offers greater stability.

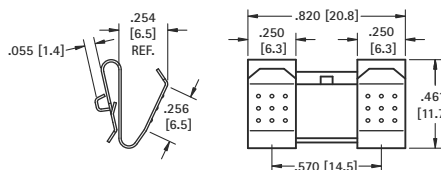

MATERIAL: .012 (.30) Spring Steel, Nickel Plate



CAT. NO. 291 Right

CAT. NO. 290 Left (shown)

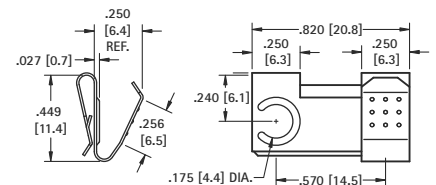

MATERIAL: 012 (.30) Spring Steel, Nickel Plate

# SLIDE-IN MOUNT CONTACTS



- Economical and reliable contacts are ideal for molded cases with self contained battery compartments
- Solder "ear" to facilitate soldering of wire lead
- Unique spring tension contact adjusts to variations in battery lengths
- Reliable spring tension contacts assure low contact resistance
- Clips easily onto .060 (1.52) to .070 (1.78) wall
- Sharp barbs securely anchor contact

Refer to page 34 for Battery Contact Layout & Mounting Details

"AA" - "CR2" - "A" - "9V"

- Press fit into housing groove.

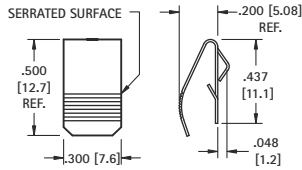
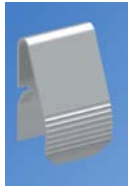

CAT. NO. 5205

MATERIAL: .012 (.30) Spring Steel, Nickel Plate

"AA"

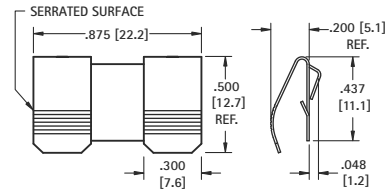

CAT. NO. 5206

MATERIAL: .012 (.30) Spring Steel, Nickel Plate

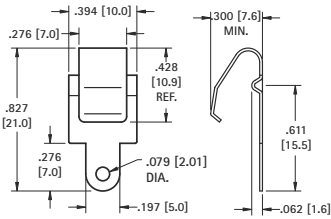

CAT. NO. 5209

MATERIAL: .012 (.30) Phosphor Bronze, Nickel Plate

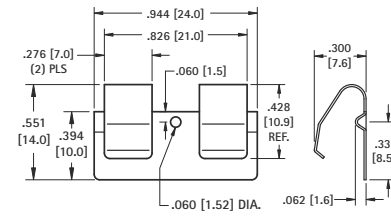

CAT. NO. 5208

MATERIAL: .012 (.30) Phosphor Bronze, Nickel Plate

# SLIDE-IN P.C. MOUNT CONTACTS

- Economical and reliable contacts
- Designed for direct placement onto PCB, no wire leads required
- Unique spring tension adjusts to variations in battery length

- Reliable spring tension assure low contact resistance and dependable connection
- Symmetrical design allows these contacts to function both as a positive and negative contacts

"AAA" - "AAAA" - "N" - "12V"

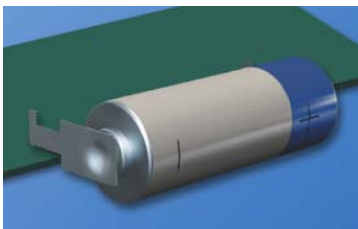

- "Off-Board" edge mounting design frees up valuable board space

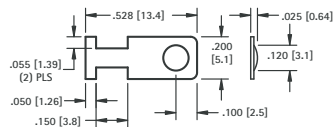

CAT. NO. 230-1

MATERIAL: .008 (.20) Spring Steel, Nickel plate

UNIVERSAL BATTERY SIZES

MATERIAL: .012 (.30) Phosphor Bronze, Tin-Nickel plate

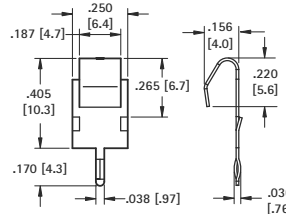

CAT. NO. 1021-1

CAT. NO.	(L) Length
109-2	.840 (21.3)
109-3	1.000 (25.4)

MATERIAL: .012 (.30) Spring Steel, Nickel plate

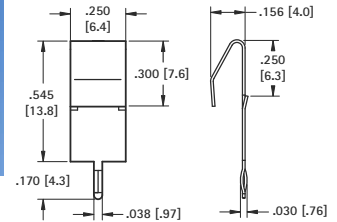

CAT. NO. 1017-1

CAT. NO. 108-2

- Made from corrosion resistant Stainless Steel

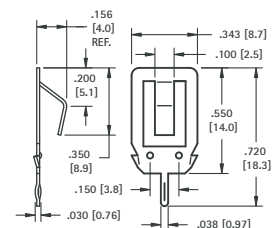

MATERIAL: .012 (.30) Stainless Steel, Tin-Nickel plate

# SPRING & BUTTON CONTACTS

- Economical and reliable contacts are ideal for molded cases with self contained battery compartments
- "Solder tab" design for either wire lead or PC mounting
- Unique spring contacts adjust to variations in battery lengths
- Reliable spring contacts assure low contact resistance and a dependable connection
- Space saving, economical, excellent mechanical construction

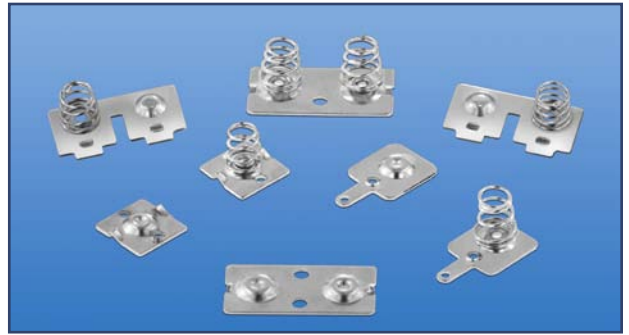

Refer to page 35 for Battery Contact Layout & Mounting Details

**MATERIAL:**

**Plate:** .020 (.51) Steel, Nickel Plate **Spring:** Spring Steel, Nickel Plate

BATTERY CONTACTS FOR MOLDED CASES

**"AAA" - "AAAA" - "N" - "12V"**

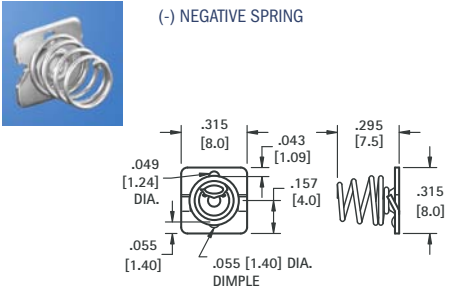

CAT. NO. 5203

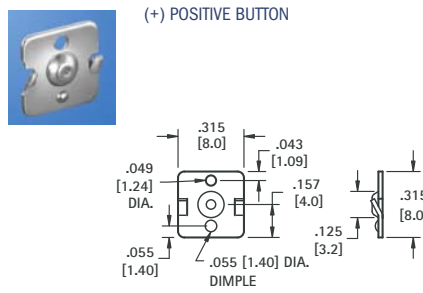

CAT. NO. 5225

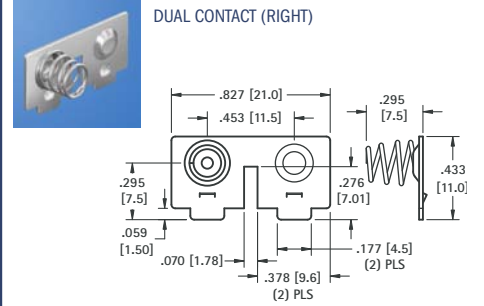

CAT. NO. 5213

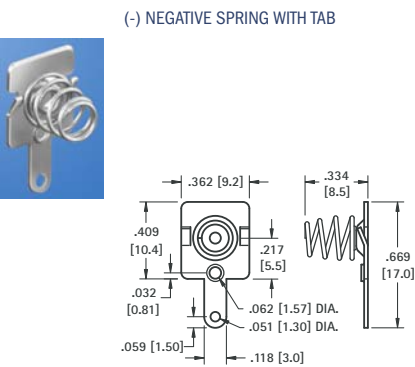

CAT. NO. 5204

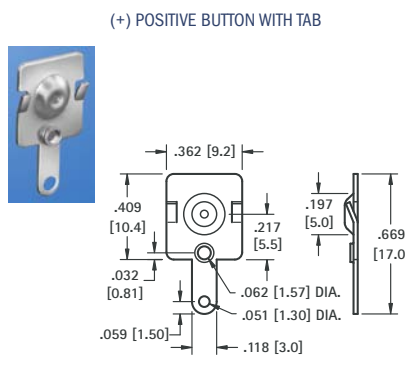

CAT. NO. 5226

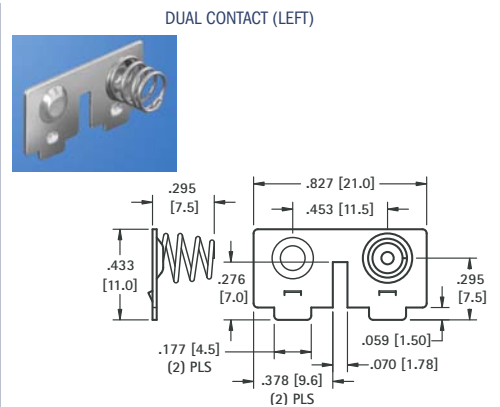

CAT. NO. 5214

**"AA" - "CR2" - "A"**

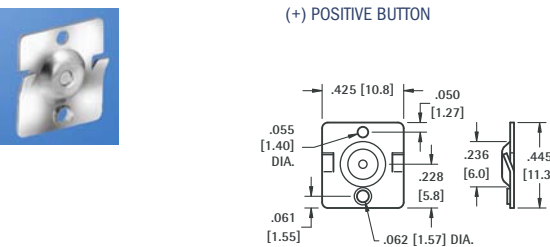

CAT. NO. 5224

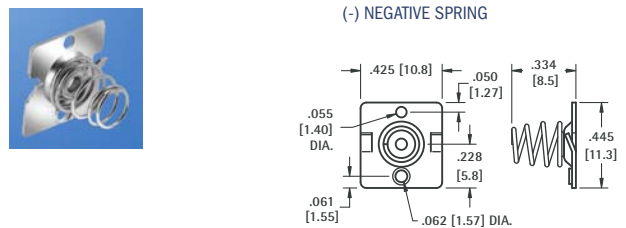

CAT. NO. 5202

**"AA"**

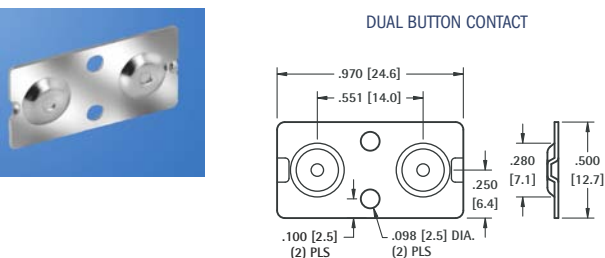

CAT. NO. 5227

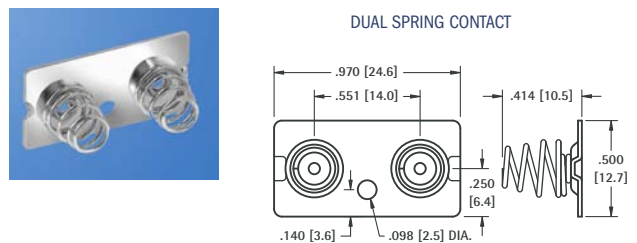

CAT. NO. 5228

# SPRING & BUTTON CONTACTS

- Economical and reliable contacts are ideal for molded cases with self contained battery compartments
- "Solder tab" design for either wire lead or PC mounting
- Unique spring contacts adjust to variations in battery lengths
- Reliable spring contacts assure low contact resistance and a dependable connection
- Space saving, economical, excellent mechanical construction

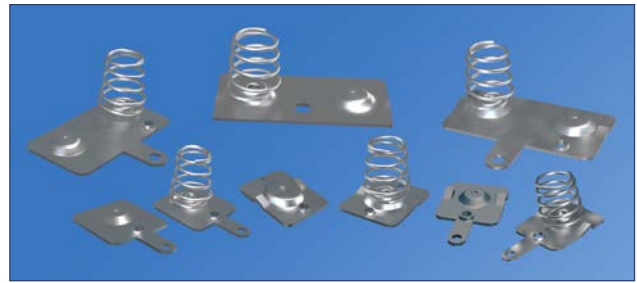

**MATERIAL:**

**Plate:** .020 (.51) Steel, Nickel Plate **Spring:** Spring Steel, Nickel Plate

Refer to page 35 for Battery Contact Layout & Mounting Details

"AA" • "CR2" • "A"

(-) NEGATIVE SPRING

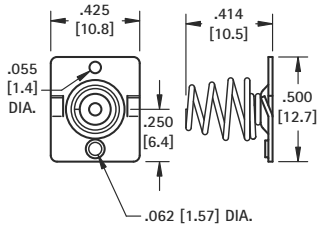

**CAT. NO. 5222**

(+) POSITIVE BUTTON

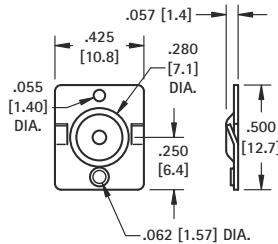

**CAT. NO. 5221**

DUAL CONTACT ("AA" ONLY)

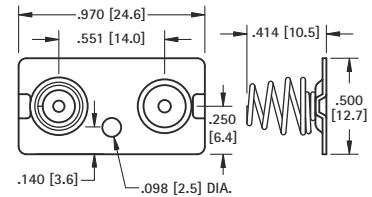

**CAT. NO. 5212** Left or Right

(-) NEGATIVE SPRING WITH TAB

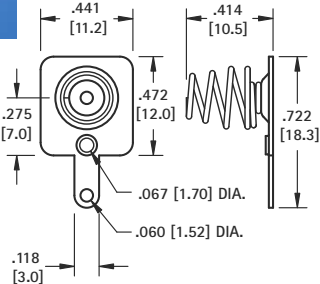

**CAT. NO. 5201**

(+) POSITIVE BUTTON WITH TAB

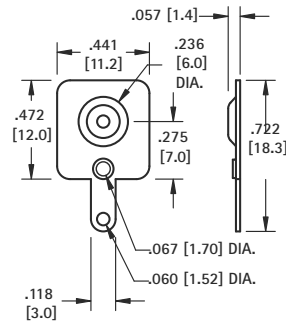

**CAT. NO. 5223**

DUAL CONTACT ("AA" ONLY)

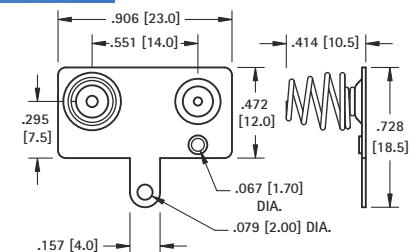

**CAT. NO. 5210** Left

**CAT. NO. 5211** Right (Shown)

(-) NEGATIVE SPRING WITH TAB/LANCE

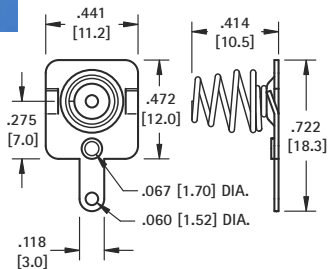

**CAT. NO. 5220**

(+) POSITIVE BUTTON WITH TAB/LANCE

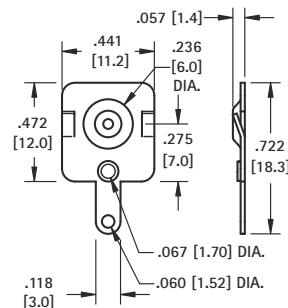

**CAT. NO. 5219**

DUAL CONTACT WITH TAB ("AA" ONLY)

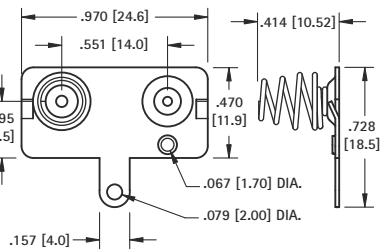

**CAT. NO. 5218** Left

**CAT. NO. 5217** Right (Shown)

# SPRING & BUTTON CONTACTS

BATTERY CONTACTS FOR MOLDED CASES

- Economical and reliable contacts are ideal for molded cases with self contained battery compartments
- "Solder tab" design for either wire lead or PC mounting
- Unique spring contacts adjust to variations in battery lengths
- Reliable spring contacts assure low contact resistance and a dependable connection
- Space saving, economical, excellent mechanical construction

**MATERIAL:**

**Plate:** .020 (.51) Steel, Nickel Plate **Spring:** Spring Steel, Nickel Plate

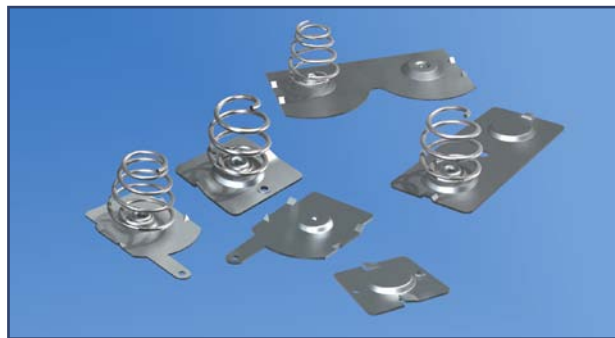

Refer to page 35 for Battery Contact Layout & Mounting Details

**"C" CELL**

(+) POSITIVE BUTTON

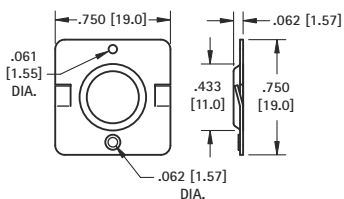

**CAT. NO. 5240**

(-) NEGATIVE SPRING

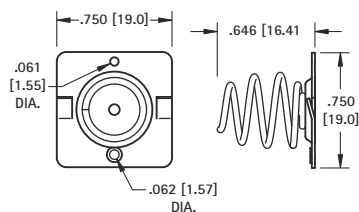

**CAT. NO. 5241**

**DUAL CONTACT**

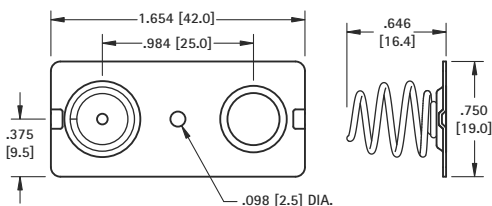

**CAT. NO. 5242**

**"D" CELL**

(+) POSITIVE BUTTON

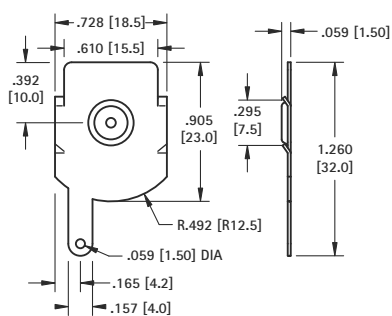

**CAT. NO. 5250**

(-) NEGATIVE SPRING

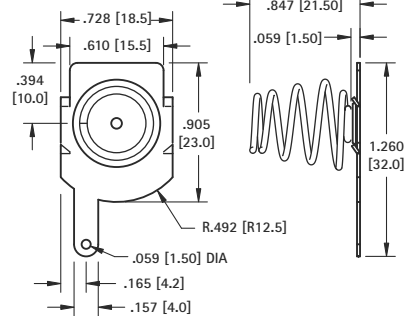

**CAT. NO. 5251**

**DUAL CONTACT**

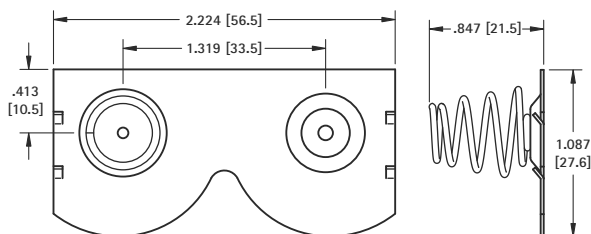

**CAT. NO. 5253** Left

**CAT. NO. 5252** Right (Shown)