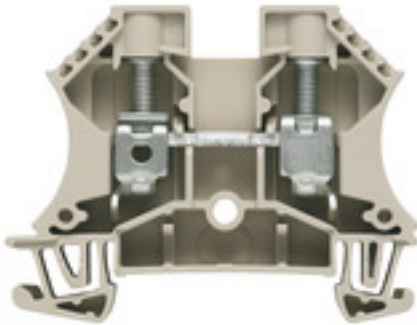

W-Series
WDU 10

Weidmüller Interface GmbH & Co. KG
 Klingenbergstraße 16
 D-32758 Detmold
 Germany
 Fon: +49 5231 14-0
 Fax: +49 5231 14-292083
 www.weidmueller.com

Klippon® Connect with clamping yoke Technology

The high reliability and variety of designs of the terminal blocks with clamping yoke connections make planning easier and optimises operational safety. Klippon® Connect provides a proven response to a range of different requirements.

General ordering data

| | |
|------------|--|
| Type | WDU 10 |
| Order No. | 1020300000 |
| Version | Feed-through terminal, Screw connection, 10 mm ² , 1000 V, 57 A, Dark Beige |
| GTIN (EAN) | 4008190068868 |
| Qty. | 50 pc(s). |

W-Series
WDU 10

Weidmüller Interface GmbH & Co. KG
 Klingenbergstraße 16
 D-32758 Detmold
 Germany
 Fon: +49 5231 14-0
 Fax: +49 5231 14-292083
 www.weidmueller.com

Technical data
Dimensions and weights

| | | | |
|--------------------------|---------|-----------------|------------|
| Width | 9.9 mm | Width (inches) | 0.39 inch |
| Height | 60 mm | Height (inches) | 2.362 inch |
| Depth | 46.5 mm | Depth (inches) | 1.831 inch |
| Depth including DIN rail | 47 mm | Weight | 18.46 g |
| Net weight | 16.9 g | | |

Temperatures

| | | | |
|----------------------------------|--------|----------------------------------|--------|
| Continuous operating temp., min. | -60 °C | Continuous operating temp., max. | 130 °C |
|----------------------------------|--------|----------------------------------|--------|

Material data

| | | | |
|---------------------------|-------|--------|------------|
| Material | Wemid | Colour | Dark Beige |
| UL 94 flammability rating | V-0 | | |

Rating data IECEx/ATEX

| | | | |
|--------------------------------|---|---------------------------------|--------------------|
| Certificate No. (ATEX) | DEMKO14ATEX1338U | Certificate No. (IECEX) | IECEXULD14.0005U |
| Max. voltage (ATEX) | 690 V | Current (ATEX) | 57 A |
| Wire cross section max. (ATEX) | 10 mm ² | Max. voltage (IECEX) | 440 V |
| Current (IECEX) | 57 A | Wire cross section max. (IECEX) | 10 mm ² |
| Operating temperature range | For operating temperature range see EC Design Test Certificate / IEC Ex-Certificate of Conformity | Marking EN 60079-7 | Ex eb II C Gb |
| Ex 2014/34/EU label | II 2 G D | | |

System specifications

| | | | |
|--|---|---|--------|
| Version | Screw connection, for screwable cross-connection, One end without connector | Tightening torque (clamping screw for aluminium conductors) | 1.2 Nm |
| Tightening torque (clamping screw for copper conductors) | 1.2... 1.9 Nm | End cover plate required | Yes |
| Number of potentials | 1 | Number of levels | 1 |
| No. of clamping points per level | 2 | Number of potentials per tier | 1 |
| Levels cross-connected internally | No | PE connection | No |
| Mounting rail | TS 35 | N-function | No |
| PE function | No | PEN function | No |

2 clampable conductors (H05V/H07V) with equal cross-section (rated connection)

| | | | |
|--|---------------------|--|-------------------|
| Cross-section for connected wire, solid, two clampable wires, min. | 0.5 mm ² | Cross-section for connected wire, solid, two clampable wires, max. | 6 mm ² |
| Cross-section for connected wire, stranded, two clampable wires, min. | 0.5 mm ² | Cross-section for connected wire, stranded, two clampable wires, max. | 6 mm ² |
| Wire connection cross section, finely stranded, two clampable wires, min. | 0.5 mm ² | Wire connection cross section, finely stranded, two clampable wires, max. | 6 mm ² |
| Wire connection cross section, finely stranded with wire-end ferrules DIN 46228/1, 2 clampable wires, min. | 0.5 mm ² | Wire connection cross section, finely stranded with wire-end ferrules DIN 46228/1, 2 clampable wires, max. | 6 mm ² |

W-Series
WDU 10

Weidmüller Interface GmbH & Co. KG
 Klingenbergstraße 16
 D-32758 Detmold
 Germany
 Fon: +49 5231 14-0
 Fax: +49 5231 14-292083
 www.weidmueller.com

Technical data
Additional technical data

| | | | |
|--------------------------|-------|-----------------------------|---------|
| Explosion-tested version | Yes | Number of similar terminals | 1 |
| Open sides | right | Type of mounting | Snap-on |

CSA rating data

| | | | |
|-------------------------------|----------------|-------------------------------|-------|
| Certificate No. (CSA) | 200039-1057876 | Current size C (CSA) | 65 A |
| Voltage size C (CSA) | 600 V | Wire cross section max. (CSA) | 6 AWG |
| Wire cross section min. (CSA) | 18 AWG | | |

Conductors for clamping (rated connection)

| | | | |
|---|----------------------|---|---------------------|
| Blade size | 1.0 x 5.5 mm | Clamping range, max. | 16 mm ² |
| Clamping range, min. | 1.31 mm ² | Clamping screw | M 4 |
| Connection cross-section, stranded, max. | 16 mm ² | Connection cross-section, stranded, min. | 1.5 mm ² |
| Connection direction | on side | Gauge to IEC 60947-1 | B6 |
| Number of connections | 2 | Stripping length | 12 mm |
| Tightening torque, max. | 1.9 Nm | Tightening torque, min. | 1.2 Nm |
| Torque level with DMS electric screwdriver | 4 | Twin wire-end ferrules, max. | 6 mm ² |
| Twin wire-end ferrules, min. | 1.5 mm ² | Type of connection | Screw connection |
| Wire connection cross section AWG, max. | AWG 6 | Wire connection cross section AWG, min. | AWG 16 |
| Wire connection cross section, finely stranded, max. | 16 mm ² | Wire connection cross-section, finely stranded with wire-end ferrules DIN 46228/1, max. | 16 mm ² |
| Wire connection cross-section, finely stranded with wire-end ferrules DIN 46228/1, min. | 1.5 mm ² | Wire connection cross-section, finely stranded with wire-end ferrules DIN 46228/4, max. | 16 mm ² |
| Wire connection cross-section, finely stranded with wire-end ferrules DIN 46228/4, min. | 1.5 mm ² | Wire connection cross-section, finely stranded, min. | 1.5 mm ² |
| Wire connection cross-section, solid core, max. | 16 mm ² | Wire connection cross-section, solid core, min. | 1.5 mm ² |

Rating data

| | | | |
|---------------------------------|--------------------|--|---------|
| Rated cross-section | 10 mm ² | Rated voltage | 1,000 V |
| Rated current | 57 A | Current at maximum wires | 76 A |
| Standards | IEC 60947-7-1 | Volume resistance according to IEC 60947-7-x | 0.56 mΩ |
| Rated impulse withstand voltage | 8 kV | Pollution severity | 3 |

UL rating data

| | | | |
|---|--------|---|-------|
| Certificate No. (UR) | E60693 | Conductor size Factory wiring max. (UR) | 6 AWG |
| Conductor size Factory wiring min. (UR) | 18 AWG | Conductor size Field wiring max. (UR) | 6 AWG |
| Conductor size Field wiring min. (UR) | 18 AWG | Current size C (UR) | 65 A |
| Voltage size C (UR) | 600 V | | |

W-Series
WDU 10

Weidmüller Interface GmbH & Co. KG
 Klingenbergstraße 16
 D-32758 Detmold
 Germany
 Fon: +49 5231 14-0
 Fax: +49 5231 14-292083
 www.weidmueller.com

Technical data**Classifications**

| | | | |
|------------|-------------|------------|-------------|
| ETIM 3.0 | EC000897 | ETIM 4.0 | EC000897 |
| ETIM 5.0 | EC000897 | ETIM 6.0 | EC000897 |
| UNSPSC | 30-21-18-11 | eClass 5.1 | 27-14-11-20 |
| eClass 6.2 | 27-14-11-20 | eClass 7.1 | 27-14-11-20 |
| eClass 8.1 | 27-14-11-20 | eClass 9.0 | 27-14-11-20 |
| eClass 9.1 | 27-14-11-20 | | |

Product information

| | |
|---------------------------------|---|
| Descriptive text ordering data | 1000 VDC rated voltage tested. For alternative colours, see section on W-series accessories – specific functions. |
| Descriptive text technical data | Note max. current of terminal (76 A) when using WQV! Tighten AWG 6/7 and H07V-R16 to 2.4 Nm. |
| Descriptive text accessories | Cross-connections, socket and test plug, see section "W series accessories". Only 400 V with the use of shield bus LS 2.8 1056400000. |

Approvals

Approvals



ROHS Conform

Downloads

| | |
|---|---|
| Approval/Certificate/Document of Conformity | CFAT_WDU_10.pdf IECEXULD14.0005U_e.pdf CB Test Zertifikat CB Zertifikat DE_PT1001_20160414_116_ISSUE01.pdf ACF-ATEX_4786180920 |
| Brochure/Catalogue | CAT 1 TERM 16/17 EN |
| Engineering Data | EPLAN, WSCAD, Zuken E3.S |
| User Documentation | NTI_IECEX_WDU-WPE_10.pdf |

Safety noteSafety notice [Safety Information](#)

Data sheet

W-Series
WDU 10

Weidmüller Interface GmbH & Co. KG
Klingenbergstraße 16
D-32758 Detmold
Germany
Fon: +49 5231 14-0
Fax: +49 5231 14-292083
www.weidmueller.com

Drawings

