

# NOTES:

- 1 MATERIAL: BASE AND COVER: 30% GLASS FILLED POLYESTER FLAME RETARDANT PER UL-94-V0  
COLOUR: SEE TABLE  
STRAIN RELIEF: UNREINFORCED THERMOPLASTIC FLAME RETARDANT PER UL-94-V0  
COLOUR: GREY  
CONTACT: BERILLIUM COPPER
- 2 PLATING: 0.76  $\mu$ m / 30  $\mu$ m Au OVER 1.27  $\mu$ m / 50  $\mu$ m Ni MIN IN CONTACT AREA REMAINDER OF PRODUCT (IDC PART) 1.5  $\mu$ m / 60  $\mu$ m TIN LEAD OVER 1.27  $\mu$ m / 50  $\mu$ m Ni
- 3 COVER AND STRAIN RELIEF ARE LOOSE PIECES DELIVERED IN BOX
- 4 DIM PRODUCT WITH COVER IN PRELOAD POSITION 13  $\pm$  0.3 / .512  $\pm$  .008
- 5 A DASH "L" AT THE END OF THE PART NUMBER TO INDICATE A NEW LATCH DESIGN.

PART CODE		TOLERANCES UNLESS OTHERWISE SPECIFIED		CUSTOMER COPY		BERG ELECTRONICS	
Dr	Rev	Dr	Date	linear	projection	title	code
				angles		0.76 $\mu$ m / 30 $\mu$ m Au 2.5	213
dr	WIZZI P	94	02	22		PRODUCT FAMILY QUICKIE	
engr	PHAMVAN	94	02	22		PROJECT NO	
chr	WIZZI P	94	02	22		4/1	
chr	PHAMVAN	94	02	22		A2	
A	FR0105	PN7	94	02	22	0001	PHAMVAN
sheet	revision	A	A				
index	sheet	1	2				

PRODUCT NUMBER	SIZE	DIM. "A"	DIM. "B"	DIM. "C"	DIM. "S"	SLOT STYLE
93682-X04	2X2	9.54/ .376	2.54/ .1	9.46/ .372	5.71/ .225	NO SLOT
93682-X06	2X3	12.08/ .476	5.08/ .2	12.00/ .472	8.25/ .325	RIGHT IF NO KEY
93682-X08	2X4	11.62/ .576	7.62/ .3	14.54/ .572	10.79/ .425	RIGHT IF NO KEY
93682-X10	2X5	17.16/ .676	10.16/ .4	17.08/ .672	13.33/ .525	RIGHT SLOT
93682-X14	2X7	22.24/ .876	15.24/ .6	22.16/ .872	18.41/ .725	RIGHT SLOT
93682-X16	2X8	24.78/ .976	17.78/ .7	24.70/ .972	20.95/ .825	2 SLOTS
93682-X18	2X9	27.32/1.076	20.32/ .8	27.24/1.072	23.49/ .925	2 SLOTS
93682-X20	2X10	29.86/1.176	22.86/ .9	29.78/1.172	26.03/1.025	2 SLOTS
93682-X24	2X12	34.94/1.376	27.94/1.1	34.86/1.372	31.11/1.225	2 SLOTS
93682-X26	2X13	37.48/1.476	30.48/1.2	37.40/1.472	33.65/1.325	2 SLOTS
93682-X30	2X15	42.56/1.676	35.56/1.4	42.48/1.672	38.73/1.525	2 SLOTS
93682-X34	2X17	47.64/1.876	40.64/1.6	47.56/1.872	43.81/1.725	2 SLOTS
93682-X40	2X20	55.26/2.176	48.26/1.9	55.18/2.172	51.43/2.025	2 SLOTS
93682-X44	2X22	60.34/2.376	53.34/2.1	60.26/2.372	56.51/2.225	2 SLOTS
93682-X50	2X25	67.96/2.676	60.96/2.4	67.88/2.672	64.13/2.525	2 SLOTS
93682-X60	2X30	80.66/3.176	73.66/2.9	80.58/3.172	76.83/3.025	2 SLOTS
93682-X64	2X32	85.74/3.376	78.74/3.1	85.66/3.372	81.91/3.225	2 SLOTS

93682-XXXL	2XXX	NEW LATCH DESIGN SEE NOTE 5 (SHEET 1/2)
------------	------	---

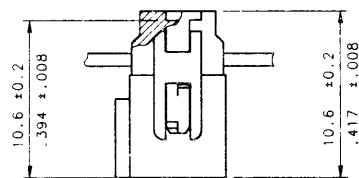

WITHOUT STRAIN RELIEF

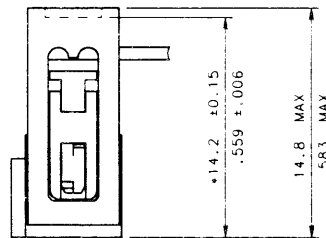

WITH LOW PROFILE STRAIN RELIEF

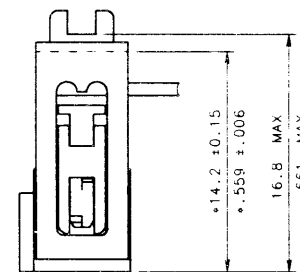

WITH STANDARD STRAIN RELIEF

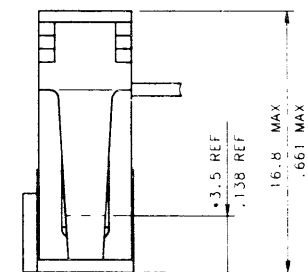

WITH LATCHING STRAIN RELIEF

AFTER TERMINATION SIDE VIEW OF ASSEMBLY (\* LATCHING DIM ON HEADER)

93682-7YY		○				○	724
93682-6YY	○					○	624
93682-5YY		○			○		504 524 530
93682-4YY		○		○			
93682-3YY		○	○				324
93682-2YY	○				○		204 224 230
93682-1YY	○			○			
93682-0YY	○		○				004
PRODUCT CODE X	WITH CENTRAL KEY	WITHOUT CENTRAL KEY	STANDARD	WITHOUT	LOW PROFILE	LATCHING	DASHES NOT AVAILABLE
STRAIN RELIEF							

part code		tolerances unless otherwise specified		CUSTOMER COPY		<b>BERG</b> ELECTRONICS	
itr	ecn no	dr	date	linear	projection	title	EURO QUICKIE
				angles			RECEPTACLE 2 PICES
				dr	NIZEL P	94 02 22	0.78 μm / 30 μ" Au
				engr	PHAMVAN M	94 02 22	product family
				chr	NIZEL P	94 02 22	code
				app	PHAMVAN M	94 02 22	size
A	RADIOS	PN2	94 02 22	scale			213
sheet	revision						93682
index	sheet						2 of 2