



What can we help you find?



[Home](#) > [Products](#) > [Automotive](#) > [Product Feature Selector](#) > [Product Details](#)

1452671-1 Product Details

[Share](#) [Print](#) [Email](#)

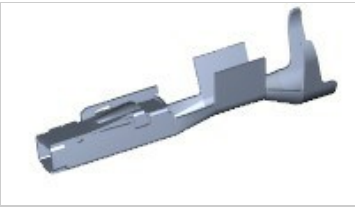

Multiple Contact Point (MCP) & MCON Contact Systems

MCON 1.2 - LL (SWS)

1452671-1

TE Internal Number: 1452671-1

Active

[View 3D PDF](#)

Product Highlights [View All](#)

- MCON Product Line, Multiple Contact Point (MCP) Product Line
- Wire-to-Wire
- Applies To Wire/Cable
- Contact
- Contact Type = Socket

[Pricing & Availability](#)

[Request Sample](#)

[Add to My Part List](#)

[Buy Product through Distributor](#)

[Documents](#) [Features](#) [Compliance](#)

Product Drawings	
MCON 1.2 LL (LOCKING-LANCE) (PDF, English)	
AMP MCP1.2 LL- CONTACT AMP MCP1.2 LL- Kontakt (PDF, German)	.tif available
CAD Files	
2D Drawing (DXF, Version B, ZIP)	
3D Model (IGES, Version B, ZIP)	
3D Model (STEP, Version B, ZIP)	
Product Specifications	
Application Specification	
Allgemeine Crimpspezifikation / GENERAL CRIMP SPEC. (PDF, German)	
MCON 1.2 Contact (PDF, German)	

Related Products

Not quite the product you're looking for?

[Find Similar Products](#)

[View Part in Product Feature Selector](#)

[View Mating Products \(5\)](#)

[View Terminals \(1\)](#)

[View Seals \(4\)](#)

[Check for Tooling](#)

Corporate Information

- [About TE](#)
- [Investors](#)
- [News Room](#)
- [Supplier Portal](#)
- [Careers](#)
- [Terms & Conditions](#)
- [Privacy Policy](#)
- [Global Accessibility Statement](#)

Quick Links

- [Distributor Inventory](#)
- [Product Cross Reference](#)
- [Documents & Drawings](#)
- [Product Compliance Support Center](#)
- [Site Map](#)

Customer Support

- [Email or Chat With Us](#)
- [Find a Phone Number](#)
- [Knowledge Base](#)
- [Manage Your Account](#)

Keep Me Informed

