

154719 ✓ ACTIVE

[Positive Lock](#) | [Positive Lock 250](#)

TE Internal #: 154719

Crimp Terminal Housings, Receptacle, Receptacle, 1 Position,
Straight, UL 94V-2, Black, Polyamide 6.6 GF, Mating Alignment,
Positive Lock 250

[View on TE.com >](#)



Terminals & Splices > Terminal Housings, Insulation Sleeves & Blocks > Crimp Terminal Housings

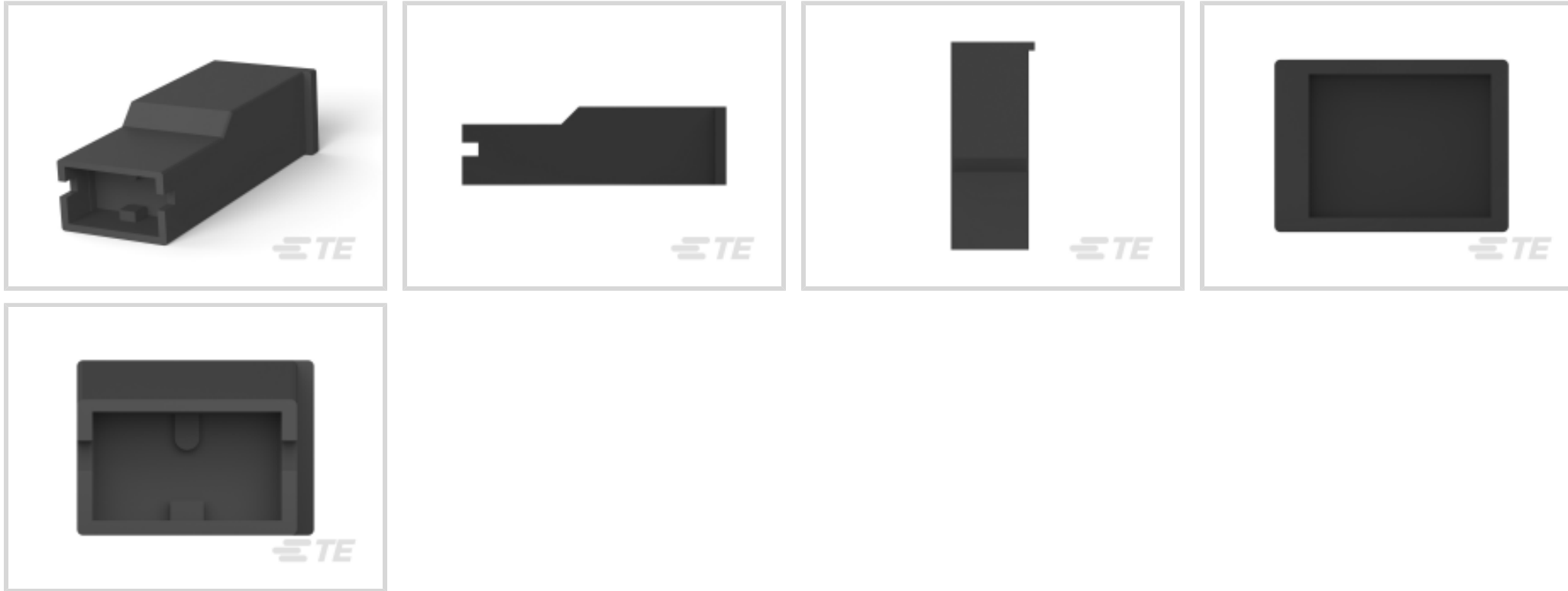

Terminal Type: **Receptacle**

Housing Type: **Receptacle**

Number of Positions: **1**

Terminal Orientation: **Straight**

UL Flammability Rating: **UL 94V-2**

Features

Product Type Features

Terminates To	Wire & Cable
Product Type	Terminal Housing
Sealable	No
Connector System	Wire-to-Board, Wire-to-Wire
Housing Type	Receptacle
Insulated	No

Configuration Features

Number of Positions	1
---------------------	---

Body Features

Primary Product Color	Black
-----------------------	-------

Contact Features

Terminal Type	Receptacle
Terminal Orientation	Straight
Contact Mating Retention	Without



Mechanical Attachment

Mating Alignment Type	Polarization
Mating Alignment	With
Crimp Terminal Housing Mounting Style	Cable Mount (Free-Hanging)

Housing Features

Housing Material	Polyamide 6.6 GF
------------------	------------------

Dimensions

Length	24.26 mm[.96 in]
--------	------------------

Usage Conditions

Operating Temperature Range	-40 – 105 °C[-40 – 221 °F]
-----------------------------	----------------------------

Industry Standards

UL Flammability Rating	UL 94V-2
------------------------	----------

Packaging Features

Packaging Quantity	1500
--------------------	------

Product Compliance

[For compliance documentation, visit the product page on TE.com>](#)

EU RoHS Directive 2011/65/EU	Compliant
EU ELV Directive 2000/53/EC	Compliant
China RoHS 2 Directive MIIT Order No 32, 2016	No Restricted Materials Above Threshold
EU REACH Regulation (EC) No. 1907/2006	Current ECHA Candidate List: JAN 2022 (223) Candidate List Declared Against: JAN 2022 (223) Does not contain REACH SVHC
Halogen Content	Low Halogen - Br, Cl, F, I < 900 ppm per homogenous material. Also BFR/CFR/PVC Free
Solder Process Capability	Not applicable for solder process capability

Product Compliance Disclaimer

This information is provided based on reasonable inquiry of our suppliers and represents our current actual knowledge based on the information they provided. This information is subject to change. The part numbers that TE has identified as EU RoHS compliant have a maximum concentration of 0.1% by weight in homogenous materials for lead, hexavalent chromium, mercury, PBB, PBDE, DBP, BBP, DEHP, DIBP, and 0.01% for cadmium, or qualify for an exemption to these limits as defined in the Annexes of Directive 2011/65/EU (RoHS2). Finished electrical and electronic equipment products will be CE marked as required by Directive 2011/65/EU. Components may not be CE marked. Additionally, the part

numbers that TE has identified as EU ELV compliant have a maximum concentration of 0.1% by weight in homogenous materials for lead, hexavalent chromium, and mercury, and 0.01% for cadmium, or qualify for an exemption to these limits as defined in the Annexes of Directive 2000/53/EC (ELV). Regarding the REACH Regulation, the information TE provides on SVHC in articles for this part number is based on the latest European Chemicals Agency (ECHA) 'Guidance on requirements for substances in articles' posted at this URL: <https://echa.europa.eu/guidance-documents/guidance-on-reach>

Compatible Parts



REPRESENTATION ONLY 

TE Part # 47387-7
DAHT PG PIDG 16-12 ASSY





TE Part # 154718-3
PL 250 REC 0.7-2.0 MM2 0.406 TPBR





TE Part # 63812-1
250 PL MKI REC. 18-14AWG TPBR





TE Part # 154717-3
PL 250 REC TERMINAL 14-11 AWG TPBR





TE Part # 790319-3
250 PL MKI REC. 12-10AWG PTBR





TE Part # 926646-1
PL 250 REC HSG 8P NYLON BLACK





TE Part # 344160-1
R/ANGLE POS.LOK.BOOT





TE Part # 1-160759-1
250 PL MKI REC. 20-15AWG PTBR





TE Part # 927422-1
POSITIVE LOCK 3P HOUSING PA6.6 BLACK





TE Part # 2-1377175-8
SMP 0-0154719-0

Also in the Series | Positive Lock 250



Automotive Terminals(1)

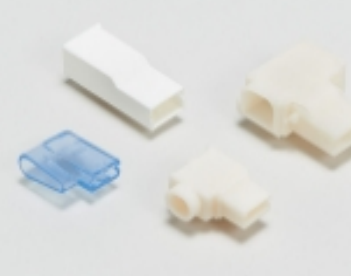

Crimp Terminal Housings(203)



Insertion & Extraction Tools(3)



Insulation Boots & Sleeves(4)



Quick Disconnects(189)

Customers Also Bought

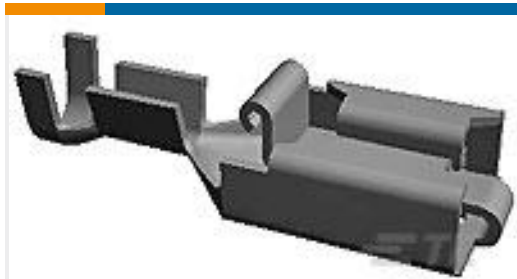

TE Part #928901-3
PL 250 REC TERMINAL 17-13 AWG
TPBR LP

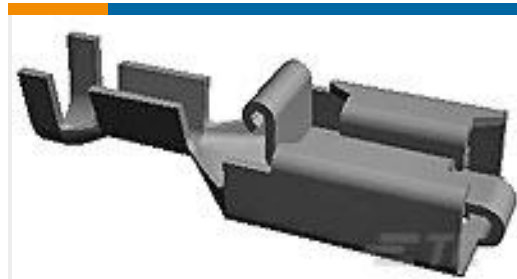

TE Part #154718-3
PL 250 REC 0.7-2.0 MM2 0.406 TPBR

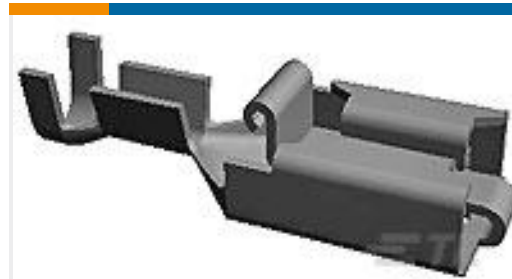

TE Part #160831-4
PL REC 1.0-2.5 MM2 .0160 X 2.060
TPPHBZ

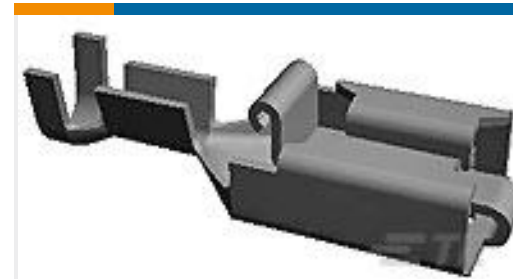

TE Part #154717-6
PL 250 REC TERMINAL 14-11 AWG
PTPB

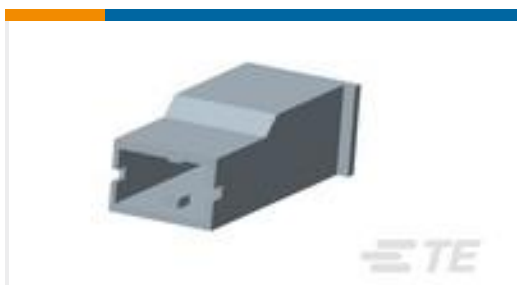

TE Part #154719-4
PL 250 REC HSG 1P NYLON YELLOW



TE Part #4-1879215-9
CPF 0402 14K 0.1% 25PPM 1K RL



TE Part #8-1879208-2
CPF 0402 24K 0.1% 25PPM 1K RL



TE Part #3-1633713-8
CRIMPER, WIRE PREMIUM

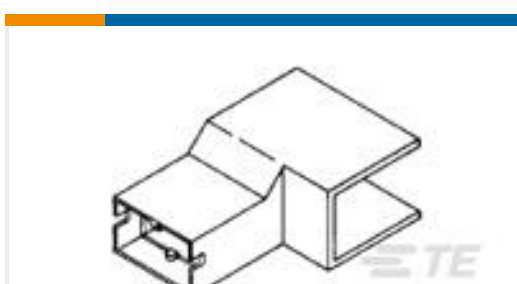

TE Part #926291-1
PL 250 HOUSING FLAG PA 6.6 BLACK

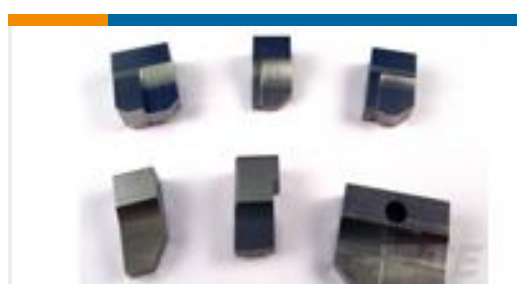

TE Part #1-1633733-0
ANVIL, WIRE

Documents

Product Drawings

250 HSG. PL MKI REC. BLACK

English

CAD Files

3D PDF

3D

Customer View Model

ENG_CVM_CVM_154719_AV.2d_dxf.zip



English

Customer View Model

[ENG_CVM_CVM_154719_AV.3d_igs.zip](#)

English

Customer View Model

[ENG_CVM_CVM_154719_AV.3d_stp.zip](#)

English

By downloading the CAD file I accept and agree to the [Terms and Conditions](#) of use.

Datasheets & Catalog Pages

Positive Lock Receptacles

English

Product Specifications

Application Specification

English

Product Environmental Compliance

[MD_154719_04262018247_dmtec](#)

English

[MD_154719_04262018247_dmtec](#)

English

Instruction Sheets

Instruction Sheet (U.S.)

English