

1452388-1 ✓ ACTIVE

AMP | MCON 1.2mm, MCON Interconnection System

TE Internal #: 1452388-1

Automotive Connector Locks & Position Assurance, TPA (Terminal Position Assurance), Red, Wire-to-Board, PA GF, MCON Interconnection System

[View on TE.com >](#)



Connectors > Automotive Connectors > Connector Accessories > Locks & Position Assurance

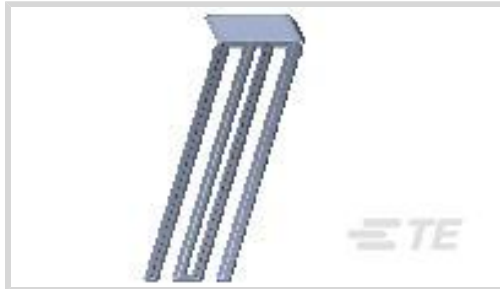

Connector & Contact Retention Accessory Type: **TPA (Terminal Position Assurance)**

Primary Product Color: **Red**

Connector System: **Wire-to-Board**

Primary Product Material: **PA GF**

Operating Temperature Range: **-40 – 140 °C [-40 – 284 °F]**

Features

Product Type Features

Connector & Contact Retention Accessory Type	TPA (Terminal Position Assurance)
Connector System	Wire-to-Board

Body Features

Primary Product Color	Red
Primary Product Material	PA GF

Usage Conditions

Operating Temperature Range	-40 – 140 °C[-40 – 284 °F]
-----------------------------	----------------------------

Industry Standards

UL Flammability Rating	UL 94HB
------------------------	---------

Packaging Features

Packaging Quantity	3000
Packaging Method	Box

Other

Serviceable	Yes
-------------	-----

Product Compliance

[For compliance documentation, visit the product page on TE.com>](#)



EU RoHS Directive 2011/65/EU	Compliant
EU ELV Directive 2000/53/EC	Compliant
China RoHS 2 Directive MIIT Order No 32, 2016	No Restricted Materials Above Threshold
EU REACH Regulation (EC) No. 1907/2006	Current ECHA Candidate List: JAN 2022 (223) Candidate List Declared Against: JAN 2022 (223) Does not contain REACH SVHC
Halogen Content	BFR/CFR/PVC Free, but Br/Cl >900 ppm in other sources.
Solder Process Capability	Not applicable for solder process capability

Product Compliance Disclaimer

This information is provided based on reasonable inquiry of our suppliers and represents our current actual knowledge based on the information they provided. This information is subject to change. The part numbers that TE has identified as EU RoHS compliant have a maximum concentration of 0.1% by weight in homogenous materials for lead, hexavalent chromium, mercury, PBB, PBDE, DBP, BBP, DEHP, DIBP, and 0.01% for cadmium, or qualify for an exemption to these limits as defined in the Annexes of Directive 2011/65/EU (RoHS2). Finished electrical and electronic equipment products will be CE marked as required by Directive 2011/65/EU. Components may not be CE marked. Additionally, the part numbers that TE has identified as EU ELV compliant have a maximum concentration of 0.1% by weight in homogenous materials for lead, hexavalent chromium, and mercury, and 0.01% for cadmium, or qualify for an exemption to these limits as defined in the Annexes of Directive 2000/53/EC (ELV). Regarding the REACH Regulation, the information TE provides on SVHC in articles for this part number is based on the latest European Chemicals Agency (ECHA) 'Guidance on requirements for substances in articles' posted at this URL: <https://echa.europa.eu/guidance-documents/guidance-on-reach>

Compatible Parts



TE Part # CAT-M4595-CH8172
MCON, CONNECTOR HOUSING



TE Part # 8-1452423-7
96 POS. PCM CPNNECTOR



TE Part # 1-1564284-1
96POS,MCON-1.2 CB,REC HSG,ASSY



TE Part # 1-1564284-7
96POS,MCON-1.2 CB,REC HSG,ASSY



TE Part # 1-1564284-8
96POS,MCON-1.2 CB,REC HSG,ASSY



TE Part # 1-1564284-9
96POS,MCON-1.2 CB,REC HSG,ASSY



TE Part # 2-1563173-1
96POS,MCON-1.2 CB,REC HSG,ASSY



TE Part # 2-1564284-2
96POS,MCON-1.2 CB,REC HSG,ASSY

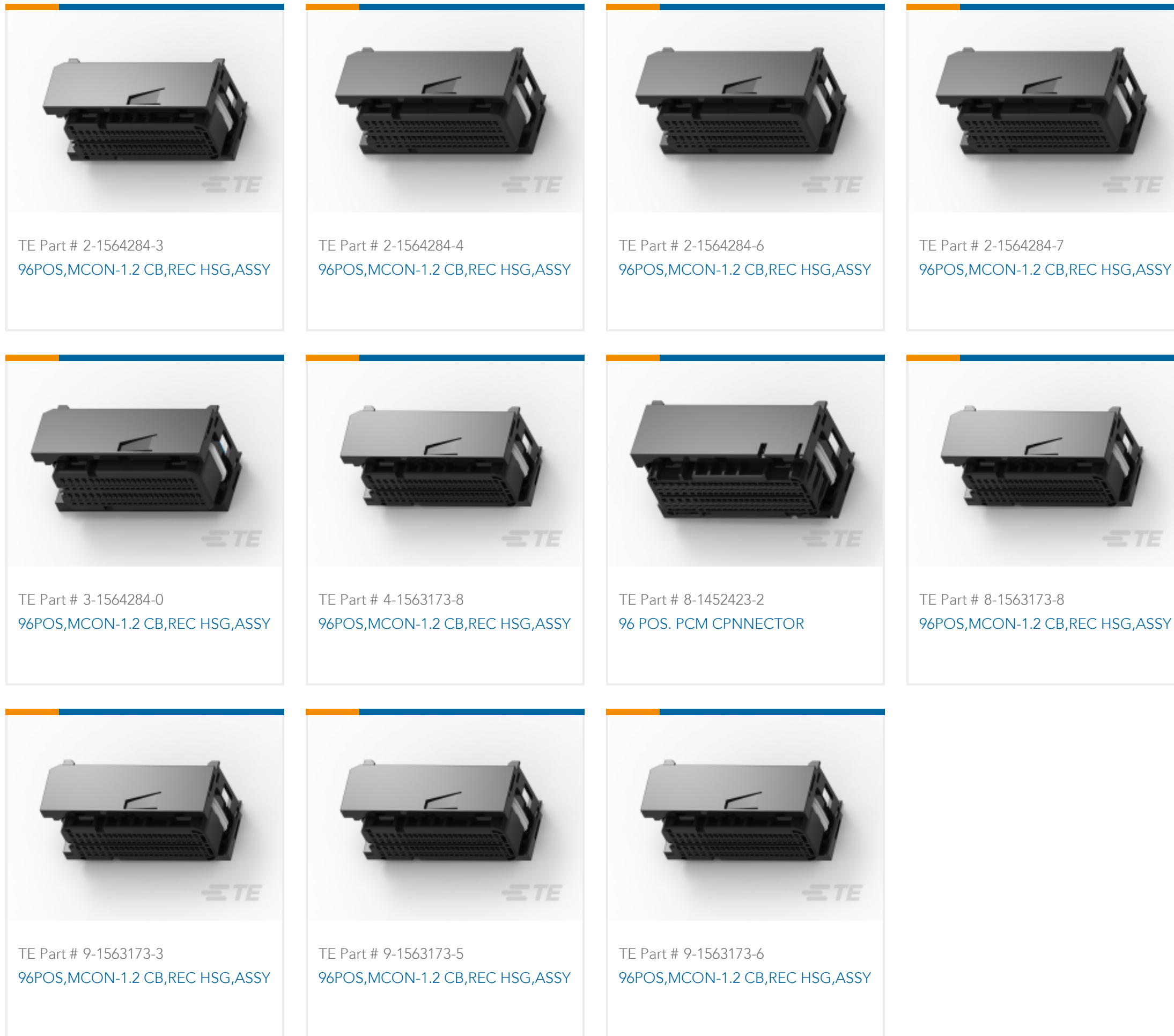

Also in the Series | **MCON 1.2mm**

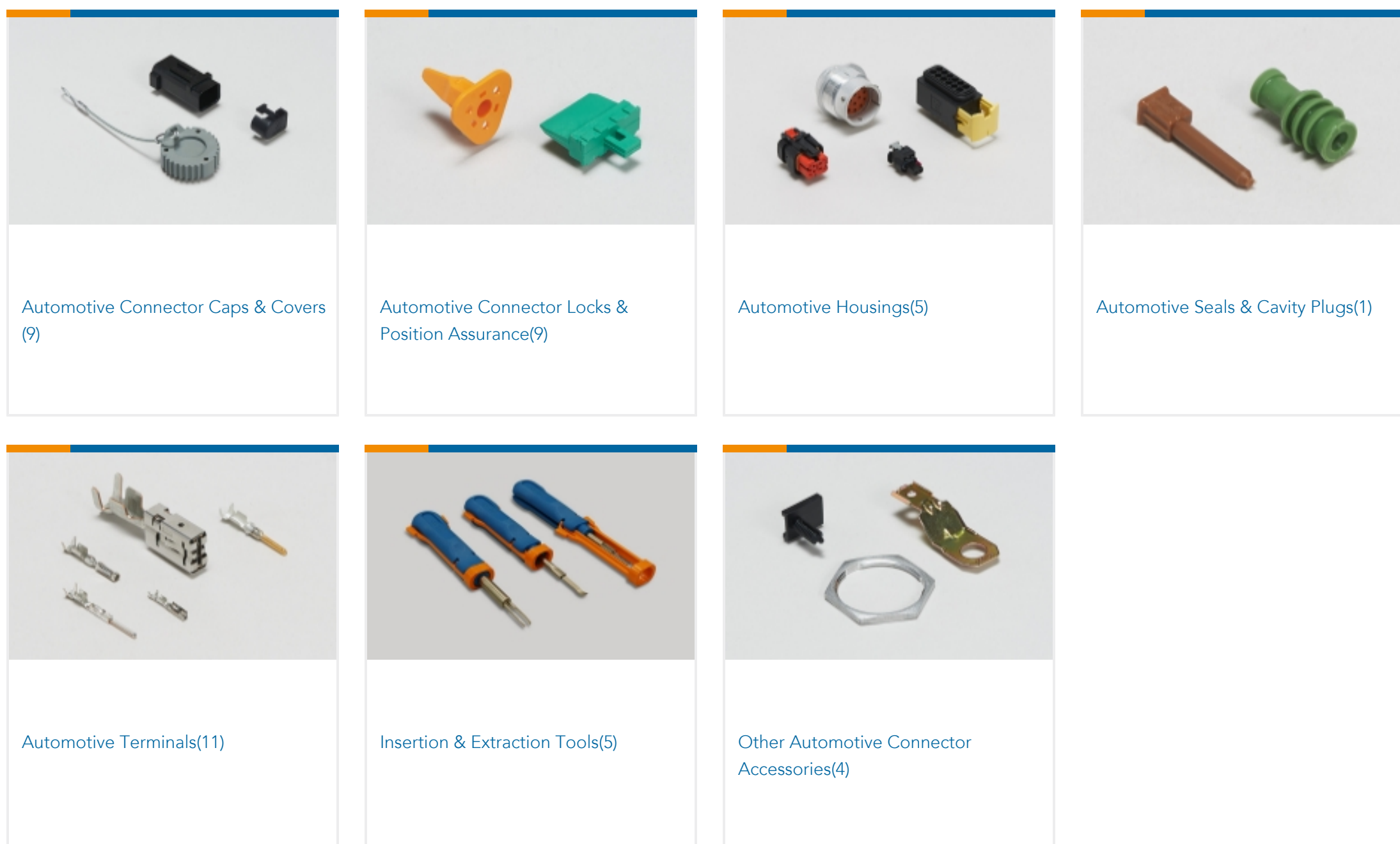

Also in the Series | **MCON Interconnection System**



Automotive Connector Caps & Covers (24)

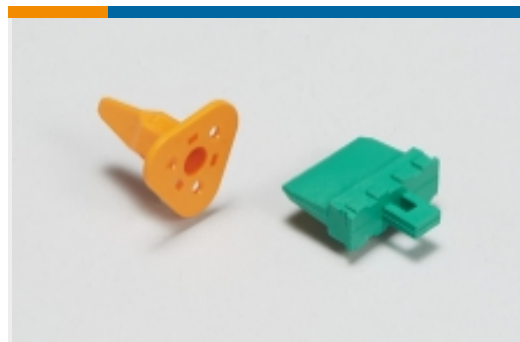

Automotive Connector Locks & Position Assurance(11)



Automotive Housings(288)



Automotive Seals & Cavity Plugs(4)

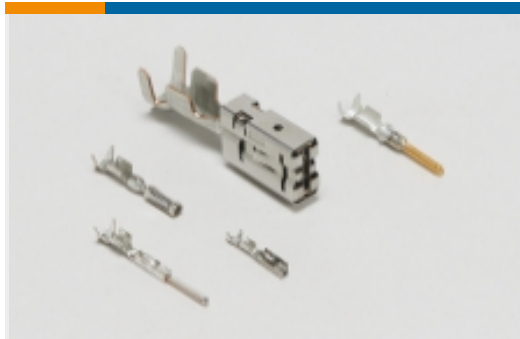

Automotive Terminals(113)



Insertion & Extraction Tools(31)



Other Automotive Connector Accessories(6)

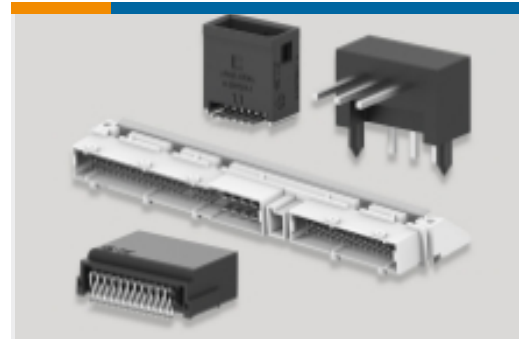

PCB Headers & Receptacles(1)

Customers Also Bought



TE Part #9-1452423-9
96 POS. CONNECTOR ASSY



TE Part #1-1718484-4
CARRIER FOR RECEPTACLE INSERTS

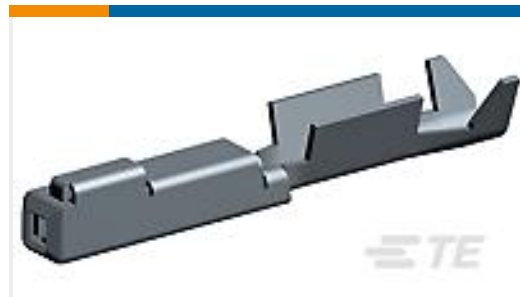

TE Part #2040168-1
0.64 RCPT SEALED TIN STRIP(L SIZE)



TE Part #1452416-1
58POS CONNECTOR COVER 180 ASSY



TE Part #1452388-2
SECONDARY LOCK FOR 96 POS CONN



TE Part #281871-3
5MM PITCH TAB/RCPT CONN



TE Part #1981561-2
0.50 SERIES CAVITY PLUG



TE Part #1674311-8
0.64 III RCPT NON SEALED Au



TE Part #1674936-5
0.64 III RCPT NON SEALED TIN (S)

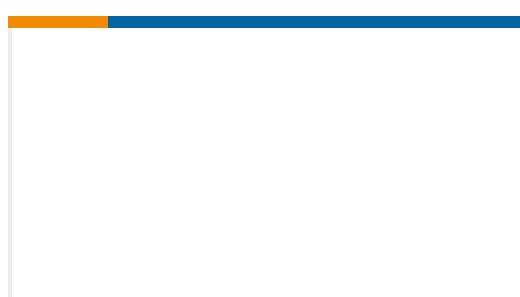

TE Part #2174114-1
WIRE COVER ASSEMBLY 50POS 0.5/1.0 SEALED

Documents



Product Drawings

2 LOCKING DEVI1.2

English

CAD Files

Customer View Model

[ENG_CVM_CVM_1452388-1_C.2d_dxf.zip](#)

English

3D PDF

3D

Customer View Model

[ENG_CVM_CVM_1452388-1_C.3d_igs.zip](#)

English

Customer View Model

[ENG_CVM_CVM_1452388-1_C.3d_stp.zip](#)

English

By downloading the CAD file I accept and agree to the [Terms and Conditions](#) of use.

Product Specifications

Appl. Spec. for 154 pos.Connector (96 pos. and 58 pos.)

English

Product Specification

English

Product Environmental Compliance

Product Compliance

English

Product Compliance

English