

- NOTES
- UNLESS OTHERWISE SPECIFIED AND/OR INDICATED: DIMENSIONS ARE TO FACE OF VIEW SHOWN AND AUTOMATICALLY ROUNDED BY COMPUTER FOR INSPECTION (SEE MATH MODEL FOR PRECISE DIMENSIONS). FOR ALL OTHER DIMENSIONS NOT SHOWN BUT REQUIRED FOR TOOL BUILD, SEE MATH MODEL FOR PRECISE TOOL PATH DATA. ALL RADII 0.5 DRAFT IS 0° 30' MAX ON ALL OUTSIDE SURFACES
 - MATING COMPONENTS OR EQUIVALENT: CONNECTOR 120477B1
 - TERMINALS MUST WITHSTAND A MINIMUM PUSHOUT FORCE OF 89 N (20 LBS).
 - RECOMMENDED BODY MATERIAL: NYLON 66 OR EQUIVALENT FLEXIBLE THERMOPLASTIC.

MATING CONNECTOR INFORMATION

RECOMMENDED MATERIAL: P-1546 (CA-210) BRASS
EXTRA SPRING TEMPER - TIN PLATED.
PLATING THICKNESS: 0.003 - 0.005 MM
TENSILE STRENGTH: 430 MPA
NOTE - USE OF MATERIAL WITH A CONDUCTIVITY 20% IACS AT 68° F SHOULD BE APPROVED BY PACKARD ELECTRIC

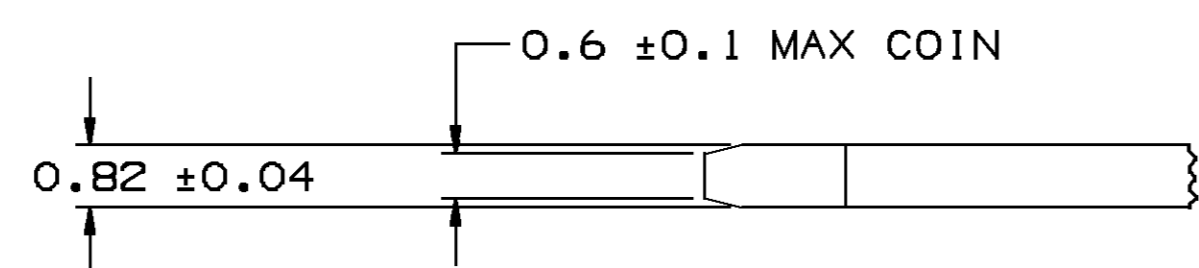
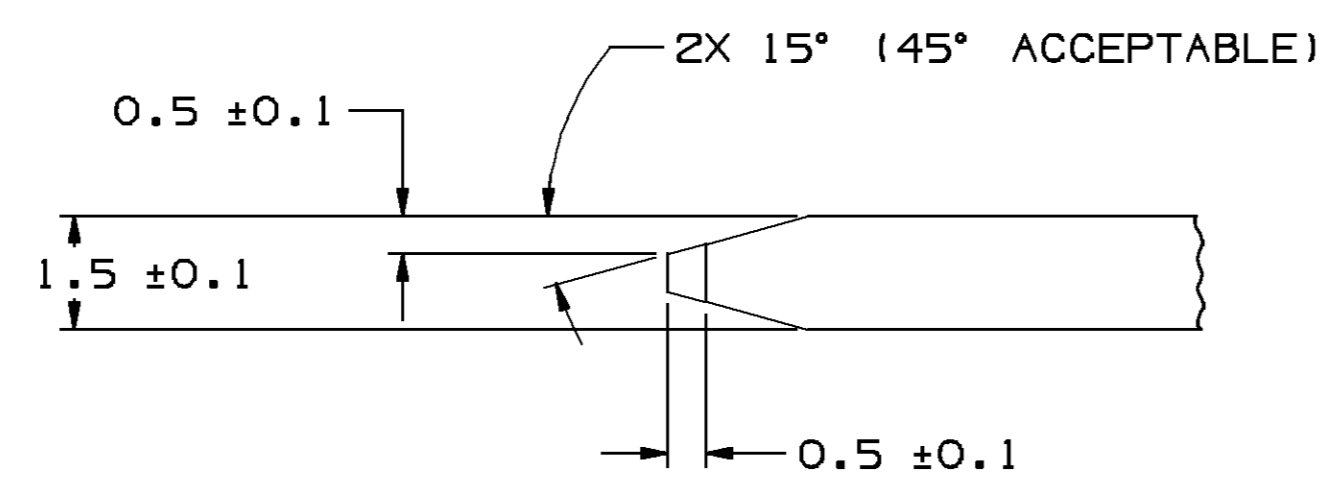

SCALE 10:1

MATING TERMINAL INFORMATION

- NOTES
- UNLESS OTHERWISE SPECIFIED AND/OR INDICATED: DIMENSIONS ARE TO FACE OF VIEW SHOWN AND AUTOMATICALLY ROUNDED BY COMPUTER FOR INSPECTION (SEE MATH MODEL FOR PRECISE DIMENSIONS). FOR ALL OTHER DIMENSIONS NOT SHOWN BUT REQUIRED FOR TOOL BUILD, SEE MATH MODEL FOR PRECISE TOOL PATH DATA.
 - MATERIAL RECYCLING CODE PER ISO 11469. (2.3)X(0.1) RAISED CHARACTERS AS SHOWN TO BE LOCATED ON ANY EXTERIOR SURFACE. OPTIONAL CONSTRUCTION TO BE NO MATERIAL RECYCLING CODE.
 - THIS PART ACCEPTS THE FOLLOWING COMPONENTS OR EQUIVALENT: CAVITIES TO ACCEPT 120478B3 TERMINAL OR EQUIVALENT. MAX INSULATION CRIMP MUST BE LESS THAN 2.3 HIGH AND 2.7 WIDE. SECONDARY TERMINAL LOCK 120477B3
 - (2.3)X(0.1) RAISED DELPHI CORPORATE BRAND TO BE LOCATED ON ANY EXTERIOR SURFACE. PREFERABLY VISIBLE AT FINAL ASSEMBLY. OPTIONAL CONSTRUCTION TO BE "PED" OR NO LOGO.
 - THIS CONNECTOR WILL PASS THRU A Ø13 MIN HOLE.
 - THIS PART IS NOT CONTROLLED FOR AUTOMATIC FEEDING.

12065422	02	M3592024 PA66 HS IM CRM	12065423	0.781
120477B1	A2	M3592001 PA66 HS IM BLK	120477B2	0.781
PART NO	REV/N/P	STATUS	MATERIAL SPECIFICATION AND COLOR	MATING CONNECTOR
				VOL CM ³

FROM	> 0	> 20	> 30	> 70	> 100	> 150	> 200	> 250	> 300
TO	20	30	70	100	150	200	250	300	400
TOLERANCE UNLESS OTHERWISE SPECIFIED	±0.15 ±0.2 ±0.3 ±0.4 ±0.5 ±0.6 ±0.8 ±1 ±1.2								
ANGULAR TOLERANCE 2C°	±1 ±1.2								

(4) PROCESS SENSITIVE DIMENSION	THIRD ANGLE PROJECTION	DO NOT SCALE	USE MATH DATA
DIMENSIONS ENCLOSED IN () INDICATE REFERENCE DIMENSIONS AND NO TOLERANCE LIMITS ARE ESTABLISHED			

SYMBOL DEFINITION		TOTAL NO OF INSPECTIONS REQUIRED		MISSING SYMBOLS		NO MISSING SYMBOL NUMBER		DATE		REV		N/P		CHG		ZONE		REVISION HISTORY		AUTH		DR		APVD	
A DIMENSION WITHOUT AN INSPECTION REPORT SYMBOL DOES NOT REQUIRE INSPECTION. IT MAY BE CONTROLLED ON THE INDIVIDUAL COMPONENT DRAWING.		10		10		28JA02		R		01								ALL PARTS - CREATED PD AND ADDED MATERIAL RECYCLING CODE		216148		RH		ROH	
		LAST NO. USED		10		12JA04		R		02								ADDED DIM 10 & ADDED NFO NOTE. UPDATED NOTE 2		249873		LLJ		LLJ	
						04AP06		R		03								12065422 - MAT'L SPEC WAS M3592002		278935		RM6		JAA	

DELPHI
DELPHI PACKARD ELECTRIC SYSTEMS
WARREN, MI

DR	DATE
APV01 R. HERMOSILLO	28JA02
APV02 R. CHACON	28JA02
APV03 G. MACIAS	30JA02
APV04	
APV05	

UNLESS OTHERWISE SPECIFIED THIS DOCUMENT IS IN ACCORDANCE WITH ASME Y14.9M-1994 AS MODIFIED BY THE IN CHARGE OF REVISIONS AND TOLERANCE AND RELATED DATUM APPLY HERE. TOLERANCE FROM AT MEASURES NOT APPLY WITH RELATIONSHIP BETWEEN FEATURES IS ESTABLISHED BY ORIENTATION OR LOCATION TOLERANCES. SPACED PARTITION CALLOUTS MAY BE SHOWN SEPARATELY, REGARDLESS OF DATUM REFERENCE. ALL DIMENSIONS ARE IN MILLIMETERS.

THIS PART IS NOT CONTROLLED FOR AUTOMATIC FEEDING.

SCALE: 5:1

FRAME NO: 1

SHEET NO: 1 OF 1

REV: R 03

DRAWING NUMBER: 12065180

DRAWING NAME: TAXI CONN F M/P 150